

SETUP AND OPERATION GUIDE

Lift Chair Collection

TABLE OF CONTENTS

Important Safety Instructions	2
Assembly of Your Lift Chair	
Cord and Transformer Connections	3
Chair Assembly	4
Installation of Back-up Batteries	5
Troubleshooting	5
FCC Instructions	6
Serial Label	6
Customer Service	6

Note: When placing the furniture on non-carpeted flooring, it is recommended to use some type of floor protection such as an area rug or furniture pads under the chair glides. Area rugs and padding are not included with purchase.

WARNING: To avoid serious personal injury:

Carefully and strictly follow assembly instructions. Improper assembly of furniture can result in structural failure, instability of the product, or tip-over.

Monitor and carefully control the assembly components. These include small parts and hardware that may present a choking hazard to small children.

Assembled only by responsible adults and children should not be involved in the assembly process.

Where provided, wall mounting hardware should always be used as prescribed in these instructions to anchor furniture to walls. Proper use of the wall mounting hardware can significantly reduce the potential for furniture tip-over and crushing injuries.

IMPORTANT SAFETY INSTRUCTIONS

READ ALL INSTRUCTIONS BEFORE USING.

WARNING: To reduce the risk of burns, fire, electric shock, or injury to persons:

1. DANGER: To reduce the risk of electric shock-Always unplug this furnishing from the electrical outlet before cleaning.
2. Unplug from outlet before putting on or taking off parts.
3. Close supervision is necessary when used by or near children, or disabled people.
4. Use this furnishing only for its intended use as described in these instructions.
Do not use attachments not recommended by the manufacturer.
5. Never operate this furnishing if it has a damaged cord or plug, if it is not working properly, if it has been dropped or damaged, or dropped into water.
6. Keep the cord away from heated surfaces.
7. Never drop or insert any object into any opening.
8. Do not use outdoors. Just for household indoor use only.
9. To disconnect, turn all controls to the off position, then remove plug from outlet.
10. WARNING: Risk of injury - Keep children away from extended foot support.
11. WARNING: Risk of injury to Persons – do not use this furnishing to support video equipment such as televisions or computer monitors.
12. When not in use, it is recommended that the wand be stored securely in the pocket on the outside of the arm.

SERVICING OF DOUBLE- INSULATED PRODUCTS.

In a double-insulated product, two systems of insulation are provided instead of grounding. No grounding. No grounding means is provided on a double-insulated product, nor is a means for grounding to be added to the product. Servicing a double-Insulated Product requires extreme care and knowledge of the system, and is to be done only by qualified service personnel. Replacement parts for a double-insulated product must be identical to the parts they replace.

SAVE THESE INSTRUCTIONS.

CORD AND TRANSFORMER CONNECTIONS

Once the box has been removed from around the chair, you'll notice the back is laying on top of the seat. There are a couple items to remove from the seat portion of the chair first. Follow the steps below:

1. Remove the zip tie holding the foam bag with the Power Transformer and its cord on the left.
2. You can either find a remote in the pocket or a side switch control on the outside Panel of the chair depending on the type of chair and model.
3. Take out the remote from the side pocket of the chair. Remove the remote from the plastic bag and connect it to the female plug located in the outside pocket of the chair.
4. Connect the Power Transformer to the plug coming from the chair.
5. Connect the Power Cord into the Power Transformer.
6. Connect the Power Cord into an electrical outlet near where the chair will be positioned.

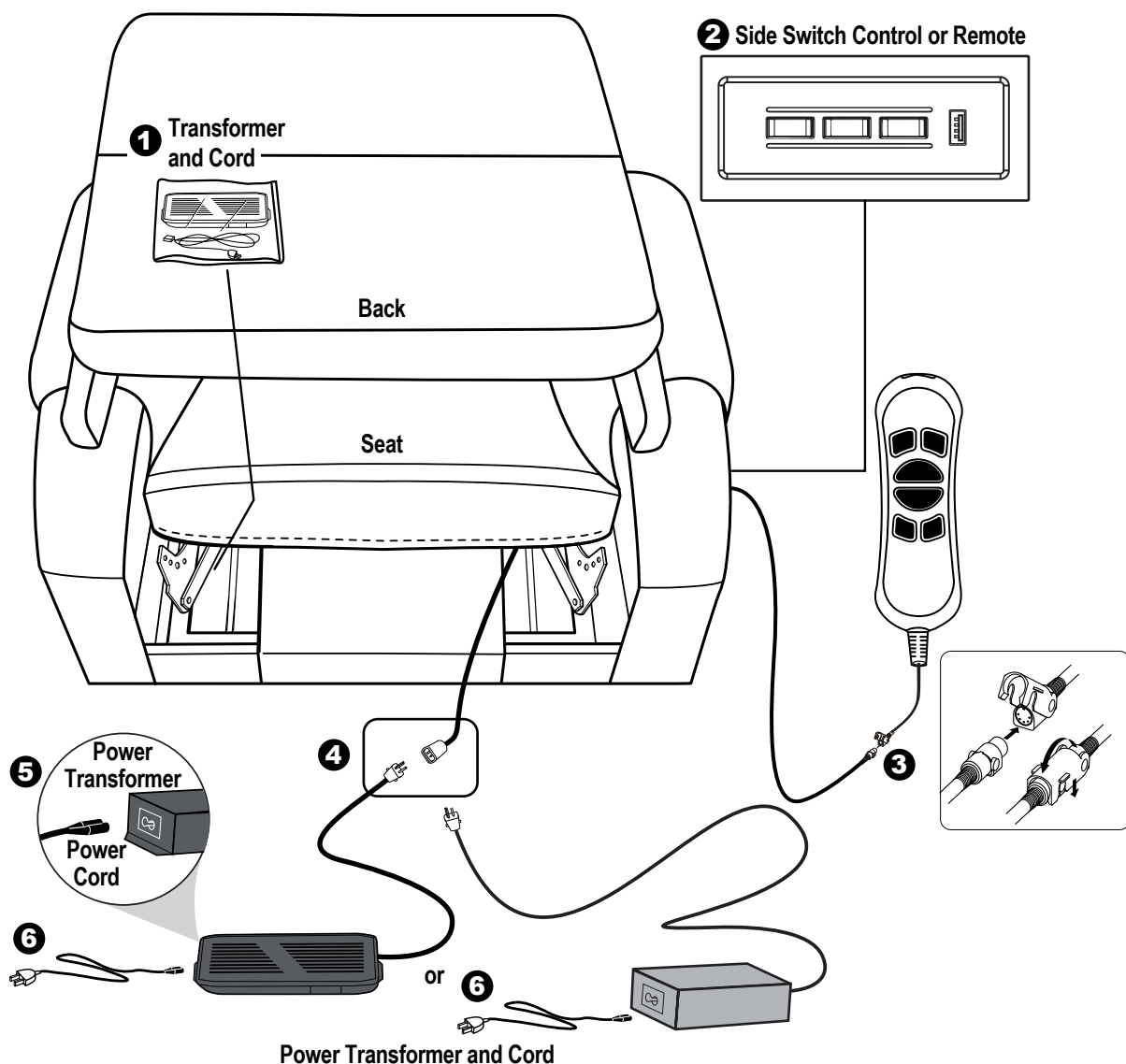

CHAIR ASSEMBLY

ATTACHING THE CHAIR BACK TO THE CHAIR BASE

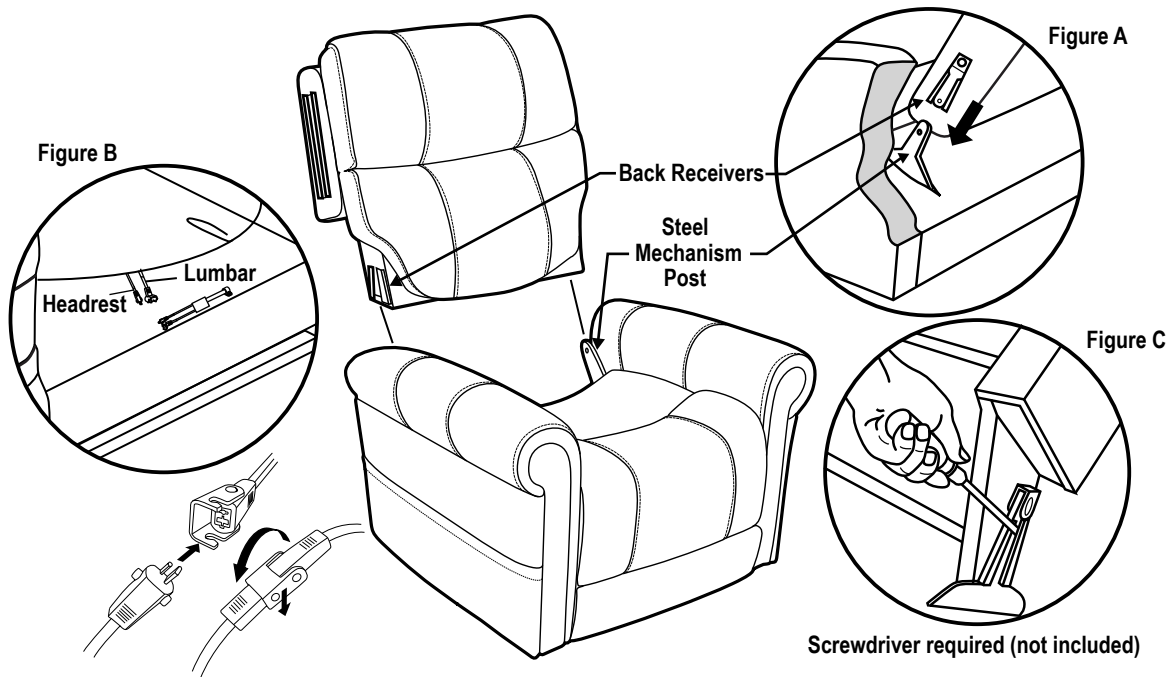

CAUTION: PLEASE READ ALL INSTRUCTIONS CAREFULLY BEFORE STARTING ASSEMBLY PROCESS. IT IS RECOMMENDED TO USE TWO PEOPLE WHEN ASSEMBLING AND REMOVING THE INSIDE BACKS TO AND FROM THE BASE OF THE FURNITURE.

- STEP1: Slide inside back receivers onto the steel mechanism posts in the base of the chair. (Figure A)
- STEP2: Press both sides of the back firmly into place until the back automatically locks into track.
- STEP3: Connect the Headrest and Lumbar cable plugs (Figure B). Headrest-only models have only one set of cables. Connect the Air Massage, Power Supply, Heat and Vibrator cable plugs if available.
- STEP4: To remove the back from the base, use a screwdriver pressing outward on the black tab in the metal receivers on both sides of the chair back and lift the back from the base of the chair to release. (Figure C)

ATTACHING THE CHAIR WINGS TO THE CHAIR BACK *

- STEP1: Slide the metal inserts on the chair's wings into the metal sleeves on the side of the chair back.
- STEP2: Slide the wings down until they are completely set on the backs metal sleeves.

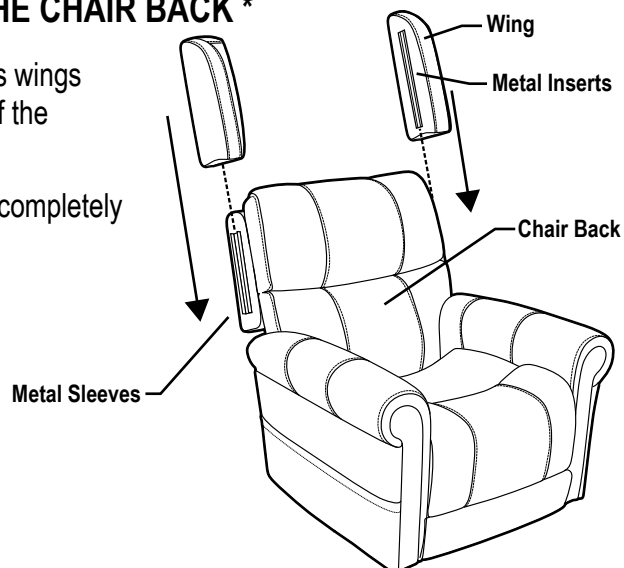

INSTALLATION OF BACK-UP BATTERIES

2 - 9 Volt back-up batteries will operate the chair from the reclined position to the seated position **one cycle** in case of a power failure. If a power failure occurs and the chair is cycled, the 2 - 9 Volt alkaline batteries will need to be replaced.

1. Removed the sliding door on the side of the transformer to locate the 2 - 9 Volt alkaline batteries.
2. Pull out the 2 - 9 Volt alkaline batteries and replace with new batteries.
3. Replace door on the transformer.
4. **2 - 9 Volt alkaline batteries are not intended to lift the chair. Replace batteries after use or every 6 months. Batteries not included.**

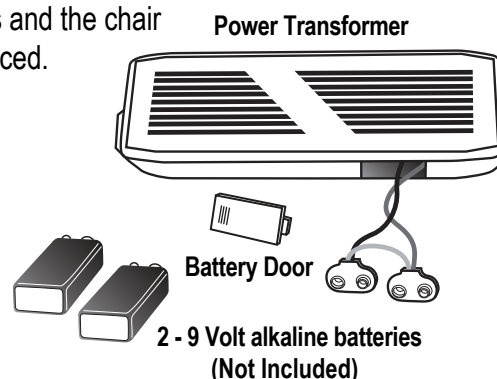

9V Emergency Backup

Provides temporary emergency power in the event of a power outage. Batteries not included. Replace batteries every 6 months to ensure proper function when needed.

Do NOT use with the 29V battery pack.

The enhanced power features of this product require use of 120V receptacle power.

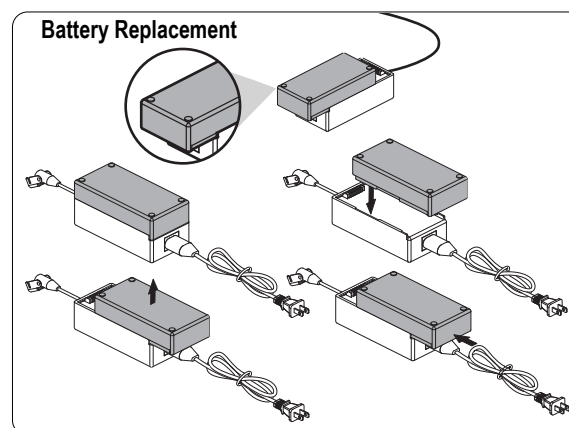

TROUBLE SHOOTING

PROBLEM	POSSIBLE FACTORS	SOLUTIONS
Chair doesn't recline or lift	Transformer may not connected well	<ul style="list-style-type: none"> • Check the power supply has been correctly connected to socket • Confirm the wire from chair to transformer is firmly connected
Headrest or Lumbar doesn't work	Headrest or lumbar motor may not connected well	<ul style="list-style-type: none"> • Check the headrest and lumbar motor has been correctly connected to socket
Headrest and lumbar work oppositely	Headrest and lumbar motor plug	<ul style="list-style-type: none"> • Check the headrest and lumbar motor has been correctly connected to socket
The remote doesn't work	Remote may not be connected well	<ul style="list-style-type: none"> • Check the remote cord has been correctly connected to plug
APP doesn't work	Out of the range of wireless connection	<ul style="list-style-type: none"> • Close the chair, the effective wireless connection range is ≤ 32.8 Feet
APP doesn't work	The version of APP is not	<ul style="list-style-type: none"> • Update the version and reset the chair

FCC INSTRUCTION

CAUTION: Changes or modifications not expressly approved by the party responsible for compliance could void the user's authority to operate the equipment.

NOTE: This equipment has been tested and found to comply with the limits for a Class B digital device, pursuant to Part 15 of the FCC Rules. These limits are designed to provide reasonable protection against harmful interference in a residential installation. This equipment generates, uses, and can radiate radio frequency energy and, if not installed and used in accordance with the instructions, may cause harmful interference to radio communications. However, there is no guarantee that interference will not occur in a particular installation. If this equipment does cause harmful interference to radio or television reception, which can be determined by turning the equipment off and on, the user is encouraged to try to correct the interference by one more of the following measures:

- Reorient or relocate the receiving antenna.
- Increase the distance between the equipment and receiver.
- Connect the equipment into an outlet on a circuit different from that to which the receiver is connected.
- Consult the dealer or an experienced radio/TV technician for help.

Serial Label

Your serial number label at the rear of the chair , as the below picture.

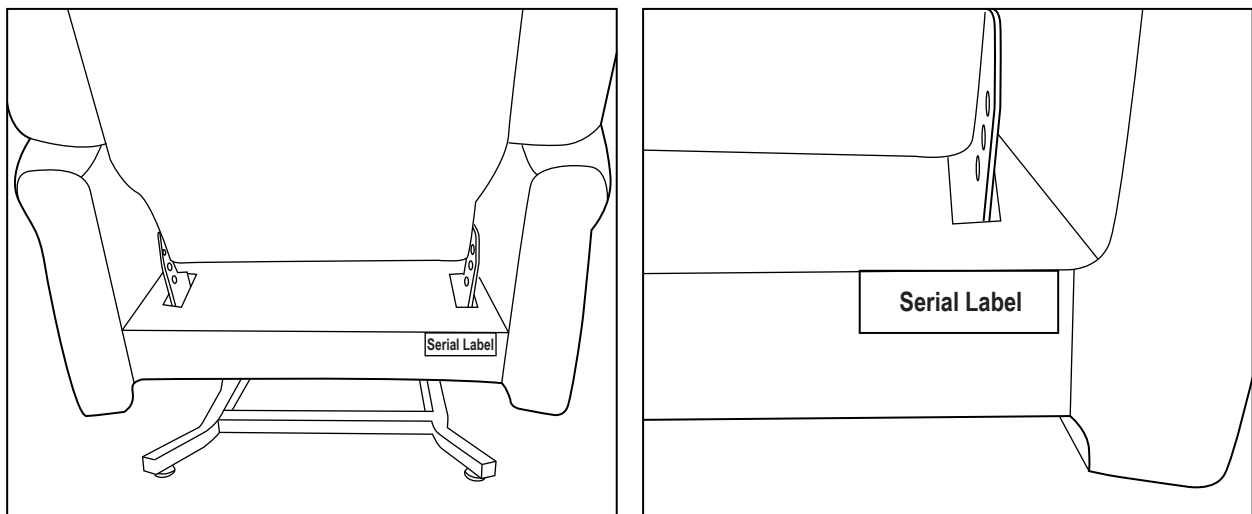

Product Protected By Following Patents:
Patented Articulating Power Headrest & Lumbar
US Patent: 10,736,423

MOTO **MOTION**

FASHION. FORWARD. FURNITURE.

Customer Service

If you have any questions regarding the use of this unit or find that your unit need service, please contact your retailer.

Lift chairs with multiple motors

- * Must use 4 NEW DURACELL BRAND 9 volt batteries
- * You need to replace all 4 DURACELL BRAND batteries after 1 use or yearly if not used.
- * This will move VERY, VERY Slow when using the battery back up
- * Lithium Battery available for Purchase

