

## INSTALLATION GUIDE

Pro Ventilation Hood Liners



Contents

Wolf Pro Ventilation Hood Liners . . . . . 3

Safety Instructions . . . . . 4

Installation Considerations . . . . . 5

Pro Hood Liner Specifications . . . . . 6

Pro Hood Liner Installation . . . . . 8

Service Information . . . . . 15

Features and specifications are subject to change at any time without notice. Visit [wolfappliance.com/specs](http://wolfappliance.com/specs) for the most up-to-date information.

**IMPORTANT NOTE:** Throughout this guide, dimensions in parentheses are millimeters unless otherwise specified.

Important Note

To ensure the safe and efficient use of Wolf equipment, please take note of the following types of highlighted information throughout this guide:

**IMPORTANT NOTE** highlights information that is especially important.

**CAUTION** signals a situation where minor injury or product damage may occur if instructions are not followed.

**WARNING** states a hazard that may cause serious injury or death if precautions are not followed.



Pro Hood Liner Installation

**IMPORTANT NOTE:** This installation must be completed by a qualified installer or Wolf factory certified service.

Read this entire installation guide prior to installation and save for the local inspector’s reference. The homeowner should keep this installation guide for future reference.

This appliance must be installed in accordance with National Electrical Codes, as well as all state, municipal and local codes. The correct voltage, frequency and amperage must be supplied to the appliance from a dedicated, grounded circuit which is protected by a properly sized circuit breaker or time delay fuse. The proper voltage, frequency and amperage ratings are listed on the product rating plate.

Record the model and serial numbers before installing the hood liner. Both numbers are listed on the product rating plate, located inside the left wall of the hood liner shell. Refer to the illustration below.

Wolf Pro Hood Liner
Model Number
Serial Number

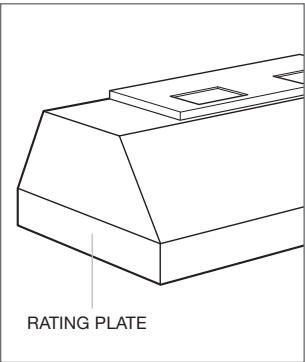

Location of rating plate  
(inside liner).

## IMPORTANT INSTRUCTIONS

TO REDUCE THE RISK OF FIRE, ELECTRIC SHOCK OR INJURY, OBSERVE THE FOLLOWING:

- Installation work and electrical wiring must be done by qualified person(s) in accordance with all applicable codes and standards, including fire-rated construction.
- Two installers are recommended due to the size and weight of the pro ventilation hood liner.
- Install the pro ventilation hood liner only with a blower manufactured by Wolf.
- When cutting or drilling into wall or ceiling, do not damage electrical wiring and other hidden utilities.
- Ducted fans must always be vented to the outdoors.

### CAUTION

To reduce the risk of fire and properly exhaust air, be certain to duct air outside. Do not vent exhaust air into spaces within walls or ceilings or into attics, crawl spaces or garages.

## Installation Considerations

Wolf pro ventilation hood liners are recommended for use with all Wolf cooking appliances. The ventilation hood should be at least as wide as the cooking surface and be installed 30" (762) to 36" (914) above the countertop.

- Proper installation is the responsibility of the installer. Product failure due to improper installation is not covered under the Wolf warranty. Refer to the Wolf pro ventilation hoods use & care guide for warranty details, or visit the contact & support section of our website, [wolfappliance.com](http://wolfappliance.com).
- Make sure you have the tools and materials necessary for proper installation.
- Warranty service must be performed by Wolf factory certified service. Wolf is not responsible for service required to correct a faulty installation.

### MATERIALS INCLUDED WITH HOOD LINER:

- Transition with backdraft damper—attached inside hood liner (needs to be removed)
- Two control knobs
- Filters and grease cups (installed in hood liner)
- Installation package and hardware
- Installation guide, use & care guide and product registration card

## DECORATIVE HOODS

A custom decorative hood can be created out of wood, plaster, tile or metal. The shape of the decorative hood is not critical as long as the hood liner fits completely inside the hood. The decorative hood and liner must fit together at the bottom edge in both width and depth. The height of the hood does not have to match the height of the liner. Interior dimensions of the decorative hood must exceed exterior dimensions of the liner. Refer to pages 6–7 for dimensions of the hood liner.

The lower  $\frac{3}{4}$ " (19) of the 4" (102) reveal is stainless steel and the rest of the reveal is aluminum. Make sure the bottom edge of the liner does not extend more than  $\frac{3}{4}$ " (19) below the decorative hood for a finished look.

## BLOWER ASSEMBLIES

Wolf pro ventilation hood liners are shipped without the blower assembly. Internal, in-line and remote blowers are available through your authorized Wolf dealer. For local dealer information, visit the find a showroom section of our website, [wolfappliance.com](http://wolfappliance.com).

The blower will vary in size and is dictated by the cooking surface, the volume of air that needs to be moved and the length of the duct run. Refer to ventilation recommendations in the Wolf design guide.

**IMPORTANT NOTE:** Use only a Wolf blower with the pro hood liner.

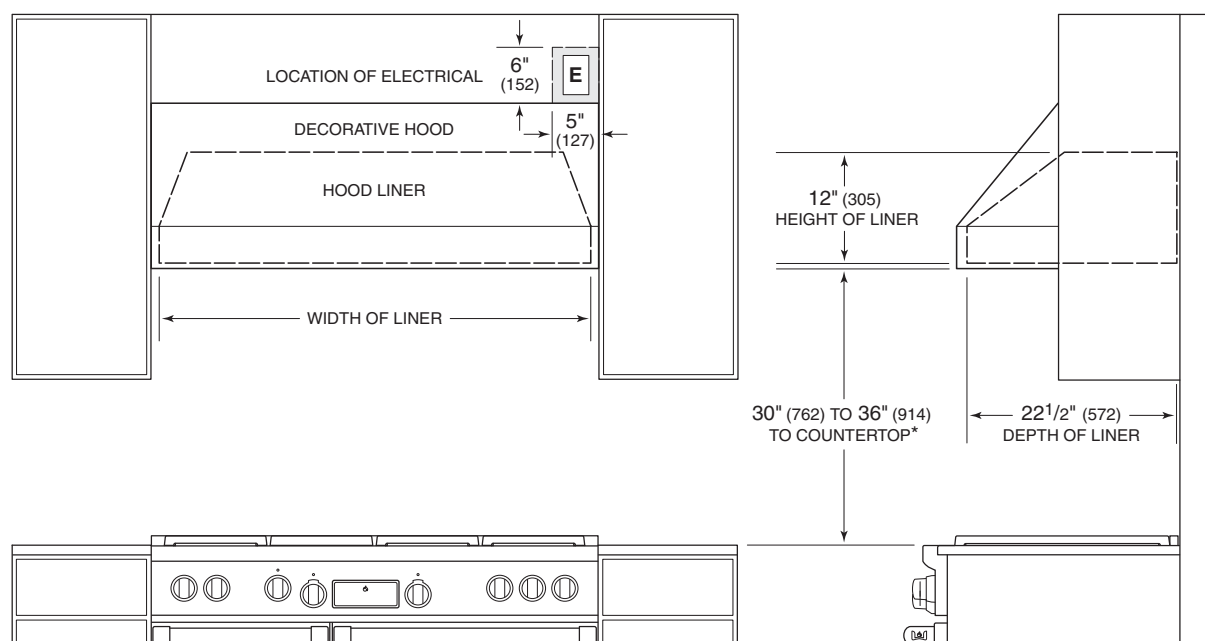

Installation Specifications

The illustration and chart below provides dimensions critical for proper installation of the pro ventilation hood liner. Dimension A in the illustration will vary with the width of the hood liner. Refer to the chart below.

Pro Hood Liners	
WIDTH OF LINER	A
34 <sup>3</sup> / <sub>8</sub> " (873)	17 <sup>3</sup> / <sub>16</sub> " (437)
40 <sup>3</sup> / <sub>8</sub> " (1026)	20 <sup>3</sup> / <sub>16</sub> " (513)
46 <sup>3</sup> / <sub>8</sub> " (1178)	23 <sup>3</sup> / <sub>16</sub> " (589)
52 <sup>3</sup> / <sub>8</sub> " (1330)	26 <sup>3</sup> / <sub>16</sub> " (665)
58 <sup>3</sup> / <sub>8</sub> " (1483)	29 <sup>3</sup> / <sub>16</sub> " (741)

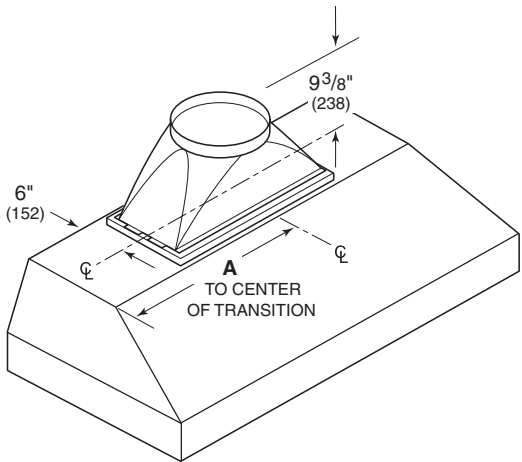

Pro hood liners.

Electrical Requirements

Wolf pro ventilation hood liners require a separate, grounded 120 V AC, 60 Hz power supply. The service should have its own 15 amp circuit breaker. Locate the electrical supply within the shaded area shown in the installation illustration on the previous page.

**IMPORTANT NOTE:** You must follow all National Electrical Code regulations. In addition, be aware of local codes and ordinances when installing your service.

**⚠ WARNING**

Risk of electrical shock. This ventilation hood must be properly grounded. Electrical service for the hood must be installed by a qualified electrician in accordance with all applicable national and local electrical codes.

## Install Ductwork

### ⚠ WARNING

To reduce the risk of fire, use only metal ductwork.

**IMPORTANT NOTE:** Pro ventilation hood liners must exhaust to the outdoors.

Wolf recommends that the ventilation hood be installed 30" (762) to 36" (914) above the countertop. Consult a qualified HVAC engineer for specific ducting applications.

A 10" (254) round duct is recommended for pro ventilation hood liners. Use only rigid metal ductwork, do not use flex ducting.

Decide where the ductwork will run between the hood liner and the outside. Pro hood liners have a vertical discharge. A straight, short duct run will allow the ventilation hood to perform most efficiently. Limit the number of elbows and transitions. The duct run should be no longer than 50' (15 m). There is a possibility of noise issues, if a remote blower is used with a short duct run.

Unless you are using a remote blower, a roof or wall cap must be installed. Connect 10" (254) round metal ductwork to the cap and work back towards the hood. Use duct sealing tape to seal joints between ductwork sections.

Pro hood liners have a backdraft damper included in the transition assembly. Local codes may require the use of an additional backdraft damper. Contact your local HVAC professional for specific requirements. In cold weather installations, a backdraft damper is necessary to minimize the backflow of cold air into the room.

Local building codes may require the use of make-up air. Consult your local HVAC professional for specific requirements in your area.

### PRO HOOD LINERS

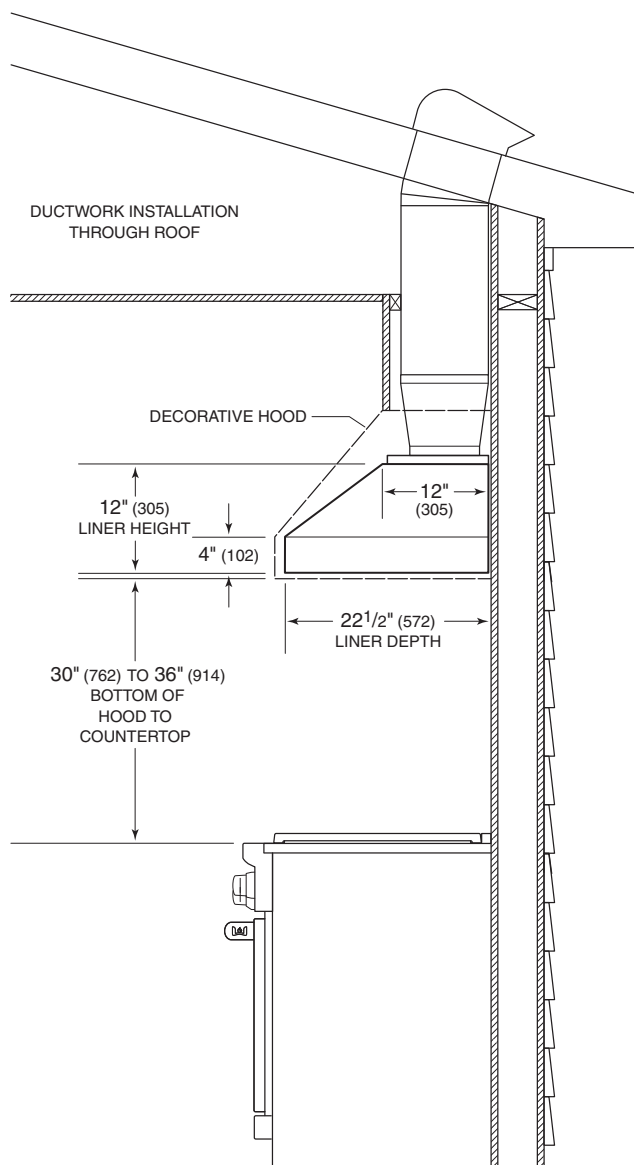



## Wall Framing

- 1) Layout dimensions of the back of the hood liner on the wall. Dimensions will vary with the width of the hood liner. Refer to the illustration and chart on page 7.
- 2) Using minimum 2" (51) x 4" (102) lumber, construct the wall framing flush with the wall studs and centered in the location that the hood liner will be mounted. Proper structural support is required to accommodate the weight of the hood liner.
- 3) Refer to the illustrations below for the location of mounting holes for pro hood liners and a cross-section view of a typical installation.

### ⚠ WARNING

Framing must be fastened together and to ceiling joists to provide enough structural strength to support the weight of the hood and internal blower, if applicable.

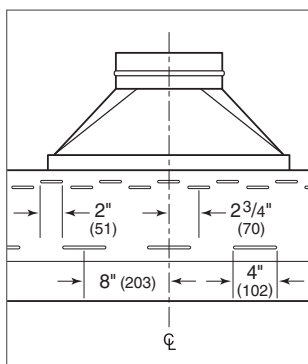

Location of mounting holes.

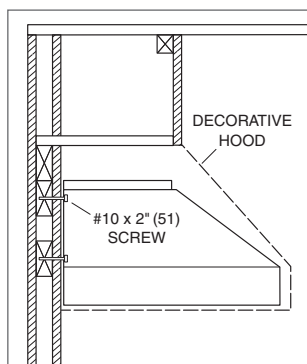

Installation cross-section.

## Hood Liner Preparation

**IMPORTANT NOTE:** For pro ventilation hood liners using an internal blower, refer to installation instructions provided with the blower assembly.

- 1) Remove the filters of the hood liner by pushing each filter up at the angle it is placed in, then rotate the bottom of the filter down. Refer to the illustration below. Remove the center filter first. Gloves should be worn when handling filters.
- 2) The hood liner is shipped with the transition attached upside down in the top of the hood liner. It must be removed and reinstalled in the proper position. Remove the blower mounting plate from the hood liner by removing four nuts from inside the liner. Detach the transition by removing four shipping screws. Reinstall the blower mounting plate back onto the liner and reattach the transition onto the top of the blower mounting plate. Refer to the illustration on page 11.
- 3) Attach the transition to existing ductwork with sheet metal screws and duct sealing tape.
- 4) If you are installing an in-line or remote blower, drill a 7/8" (22) hole through the wood framing for the conduit. Refer to in-line and remote blowers on pages 12–13.

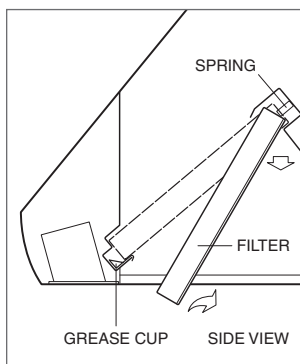

Filter removal.

## Hood Liner Installation

**⚠ CAUTION**

Due to the weight of the hood, be sure to have adequate assistance for installation.

The filters must be removed from the hood liner prior to installation. Refer to hood liner preparation on the previous page.

Position the hood liner in the desired location on the wall. Install #10 x 2" (59) screws through the mounting holes on the back plate. Verify that the screws engage the wall studs or blocking.

If additional support is required for the hood liner, drill supplementary mounting holes in the back plate and use these holes to attach the hood liner to wall framing.

## Hood Wiring Connections

## BLOWER WIRING

**⚠ WARNING**

Before making electrical connections, make sure the electrical power is turned off at the service panel.

**IMPORTANT NOTE:** Refer to specific installation instructions provided with each blower assembly for additional mounting and wiring instructions.

- 1) Remove the hood electrical box cover from the back of the hood liner. Run Romex® wire from the service panel to the hood installation location. Insert the Romex® wire through the holes in the back of the hood liner to the electrical box. Refer to the illustration below for the location of wiring.
- 2) Using the wire connectors provided, connect black wire to power supply black wire, white wire to power supply white wire and green wire to green wire or bare wire.
- 3) Place all wiring connections inside the electrical box and reinstall the cover. Make sure all wires are secure and that no wires are pinched between the cover and electrical box.

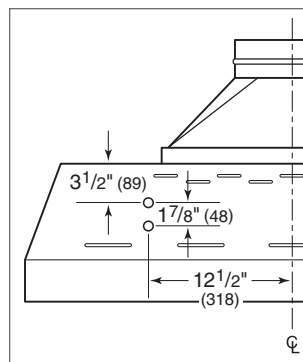

Location of hood wiring.

## Blower Assemblies

Pro ventilation hoods are shipped without the blower assembly. Internal, in-line and remote blowers are available through your authorized Wolf dealer. For local dealer information, visit the find a showroom section of our website, [wolfappliance.com](http://wolfappliance.com).

The blower will vary in size and is dictated by the cooking surface, the volume of air that needs to be moved and the length of the duct run. Refer to ventilation recommendations in the Wolf design guide.

**IMPORTANT NOTE:** Use wire connectors or wire nuts approved by UL or C/UL.

### ⚠ CAUTION

To reduce the risk of fire and electric shock, install this ventilation hood liner only with a blower manufactured by Wolf.

## Internal Blower

### BLOWER INSTALLATION

**IMPORTANT NOTE:** Refer to specific installation instructions provided with each blower assembly for additional mounting and wiring instructions.

- 1) Engage the blower mounting tab into the hood liner top plate mounting slot. Make sure the blower tab and mounting slot are aligned properly front to back.
- 2) Secure the blower with the weld stud at the front of the blower and hood liner top plate and the nut (included with blower). Verify that the blower discharge aligns with the top plate discharge cut-out of the hood liner.
- 3) Once the hood liner installation is complete, plug the blower power cord(s) into receptacle(s) located near the center of the hood liner shell. Use the clips on the interior of the hood liner to secure excess power cord.

**IMPORTANT NOTE:** Before turning electrical power on to the ventilation hood liner, make sure the blower is off.

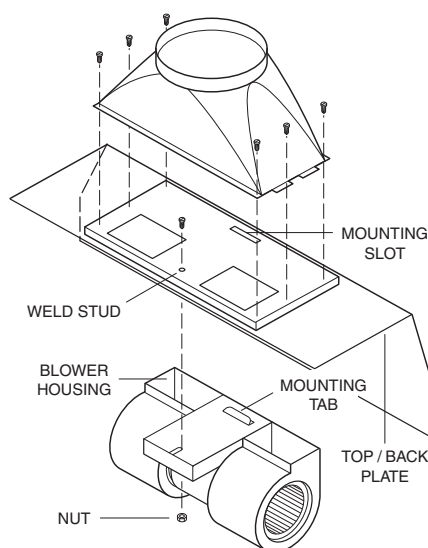

Internal blower assembly.

## In-Line and Remote Blowers

### BLOWER INSTALLATION

**IMPORTANT NOTE:** Refer to specific installation instructions provided with each blower assembly for additional mounting and wiring instructions.

Locate the blower so that the length of the duct run and number of elbows and transitions are kept to a minimum. The duct run should be no longer than 50' (15 m). Remote blowers should be located between wall studs or roof rafters. Avoid pipes, wires and other ductwork.

Allow enough space for transitions needed between the blower and connecting ductwork. For best performance, locate transitions nearest the blower.

Refer to the illustrations below for overall dimensions of Wolf in-line and remote blowers. Installation instructions shipped with each Wolf ventilation product provide detailed specifications. These instructions can also be found on our website, [wolfappliance.com/specs](http://wolfappliance.com/specs).

### IN-LINE AND REMOTE BLOWER DIMENSIONS

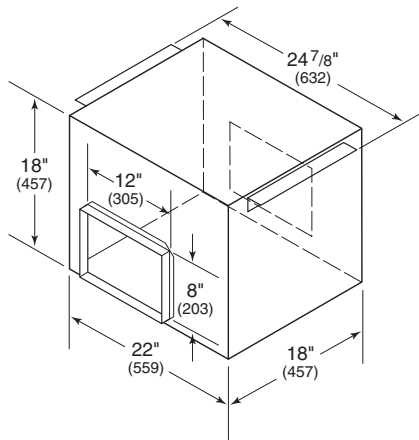

1100 CFM in-line blower.

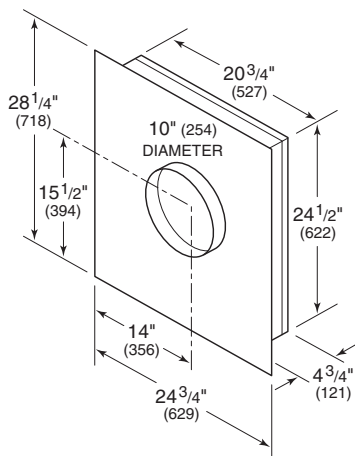

900 CFM remote blower.

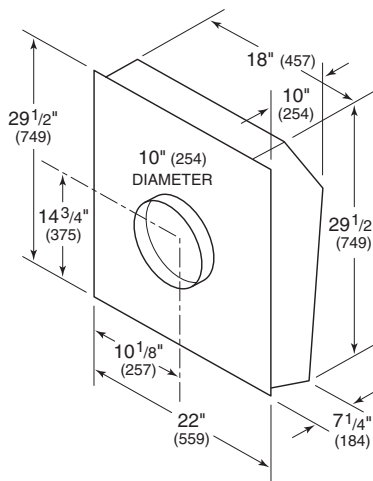

1200 CFM remote blower.

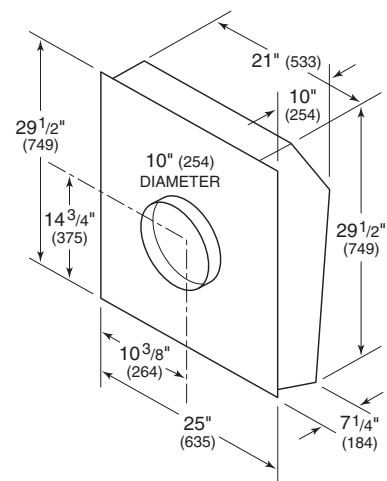

1500 CFM remote blower.

## In-Line and Remote Blowers

### BLOWER WIRING

#### ⚠ WARNING

Before making electrical connections, make sure the electrical power is turned off at the service panel.

**IMPORTANT NOTE:** Refer to specific installation instructions provided with each blower assembly for additional mounting and wiring instructions.

- 1) Remove the two knock-outs in the top plate of the hood liner. Refer to the illustration below.
- 2) Follow wiring instructions at the blower (specific wiring instructions are provided with each blower). Run Romex® wire from the in-line or remote blower to the hood liner.
- 3) Insert 6" (152) of Romex® wire through the holes on the back plate and into the hood liner. Secure the wire to the electrical box with an appropriate connector.
- 4) Locate the cord assembly provided with the blower. The cord assembly has two leads, black (L1) and white (neutral). Connect these leads to the leads from the blower, black to black and white to white. Connect all green and bare wires together to the ground screw in the electrical box.
- 5) Plug the cord assembly into the receptacle located near the center of the hood liner. Refer to the illustration below. Use the clips on the interior of the hood to secure excess power cord.
- 6) Place all wiring connections inside the electrical box and reinstall the cover. Make sure all wires are secure and that no wires are pinched between the cover and electrical box.

**IMPORTANT NOTE:** Before turning the power on to the ventilation hood liner, make sure the blower is off.

#### ⚠ WARNING

Do not run wiring through the ductwork.

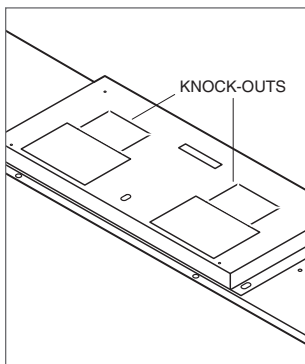

Location of knock-outs.

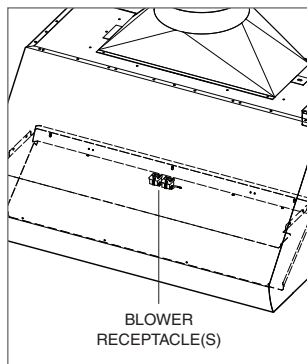

Location of receptacle(s).

## Complete the Installation

### INSTALL FILTERS

To install the filters, orient each filter with lines running vertically. Position the top edge of the filter as shown in the illustration below. While pressing up against the spring, rotate the bottom edge of the filter into position next to the grease cup. Gloves should be worn when handling filters.

### INSTALL LIGHT BULBS

A suction-cup-style light bulb changer is provided with pro ventilation hood liners. Using this device, push the light bulb into the receptacle and rotate clockwise one-quarter turn. Refer to the illustration below.

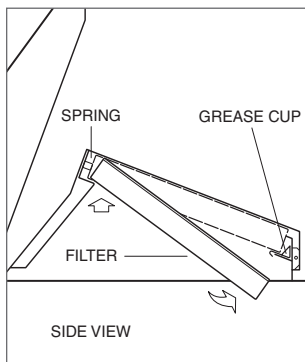

Filter installation.

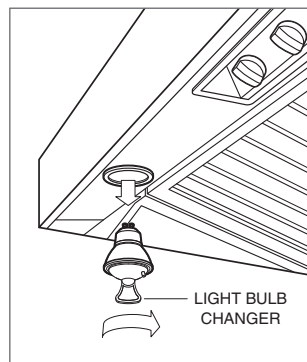

Light bulb installation.

## Troubleshooting

**IMPORTANT NOTE:** If the pro ventilation hood liner does not operate properly, follow these troubleshooting steps:

- Verify that electrical power is being supplied to the hood liner.
- Check electrical connections to ensure that the installation has been completed correctly.
- Refer to the troubleshooting guide in the Wolf pro ventilation hoods use & care guide.
- If the hood liner still does not operate properly, contact Wolf factory certified service. Do not attempt to repair the hood liner yourself. Wolf is not responsible for service required to correct a faulty installation.

## Service Information

If service is necessary, maintain the quality built into your pro ventilation hood liner by contacting Wolf factory certified service.

For the name and number of Wolf factory certified service nearest you, check the contact & support section of our website, [wolfappliance.com](http://wolfappliance.com) or call Wolf customer care at 800-222-7820.

When calling for service, you will need the model and serial numbers of the hood liner. This information is found on the product rating plate, located inside the left wall of the hood liner shell. Refer to the illustration below.

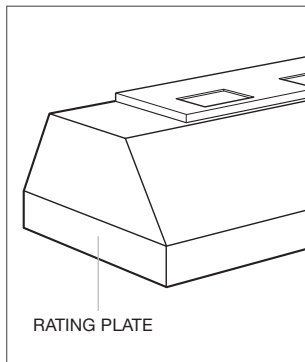

Location of rating plate  
(inside liner).

### ⚠ WARNING

Before servicing or cleaning, switch power off at the service panel and lock the service disconnecting means to prevent power from being switched on accidentally. If it cannot be locked, securely fasten a prominent warning tag, to the service panel.



The information and images in this guide are the copyright property of Wolf Appliance, Inc. Neither this guide nor any information or images contained herein may be copied or used in whole or in part without the express written permission of Wolf Appliance, Inc. ©Wolf Appliance, Inc. all rights reserved.

Wolf, Wolf & Design, Wolf Gourmet, W & Design and the color red as applied to knobs are registered trademarks and service marks of Wolf Appliance, Inc. Sub-Zero, Sub-Zero & Design, Dual Refrigeration, Constant Care and The Living Kitchen are registered trademarks and service marks of Sub-Zero, Inc. (collectively, the "Company Marks.") All other trademarks or registered trademarks are property of their respective owners in the United States and other countries.



WOLF APPLIANCE, INC. P. O. BOX 44848 MADISON, WI 53744 WOLFAPPLIANCE.COM 800.222.7820

817003 REV-A

3/2011

