



## 27" Integrated All Refrigerator—Drawers

Integrated refrigeration can be used anywhere in the home. It merges seamlessly into the décor, with no visible hinges or grilles. Model 700BR is a 27" wide base unit with refrigerator storage in both drawers. This model is ENERGY STAR® qualified for energy efficiency.



### FEATURES

- Custom front panels and hardware allow for infinite design options.
- Point-of-use refrigeration that can be placed anywhere in the home.
- Microprocessor maintains precise control, within 1° of set temperature.
- Easy-access, illuminated touch control panel in upper refrigerator drawer.
- Bright interior lighting.
- Removable crisper cover on upper refrigerator drawer.
- Upper drawer is deep enough for bottled drinks to stand upright.
- Smooth-glide, full-extension storage drawers.
- Alarm feature will sound an audible beep if a drawer is left open.

### MODEL

700BR

### Design

Integrated

### INTERIOR FEATURES

- **Refrigerator**
  - 1 Temperature Zone
  - 2 Storage Drawers
  - Removable Crisper Cover
  - 2 Removable Drawer Dividers

### ACCESSORIES

- Stainless steel front panels with tubular or pro handles.
- Stainless steel tubular and pro handles.
- Dual installation kit for installation with column, tall or drawer model.
- Dozen egg container.

*Accessories are available through your Sub-Zero dealer. For local dealer information, visit the find a showroom section of our website, [subzero.com](http://subzero.com).*





## 27" Integrated All Refrigerator—Drawers

### OVERALL DIMENSIONS

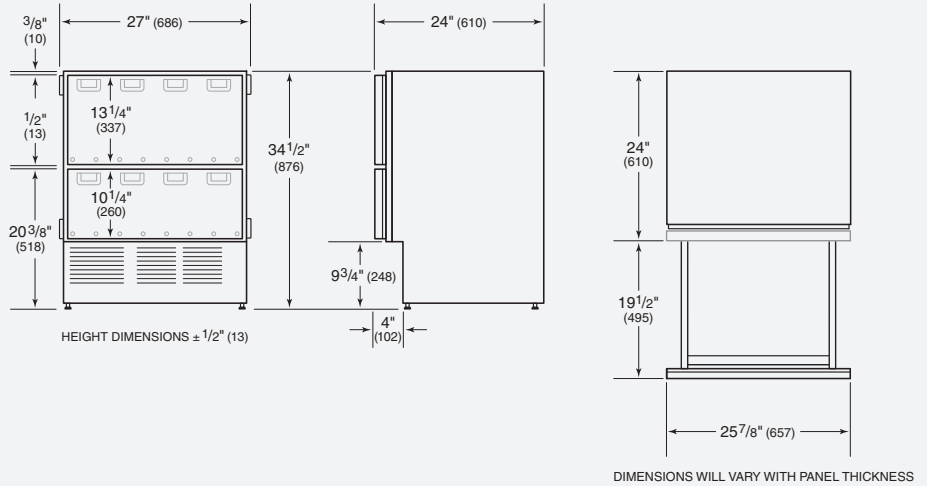

Unit dimensions may vary by ± 1/8".

### SPECIFICATIONS

Overall Width	27"
Overall Height	34 1/2"
Overall Depth	24"
Drawer Clearance	19 1/2"
Refrigerator Capacity	5.3 cu ft
Opening Width	27"
Opening Height	34 1/2"
Opening Depth	25"*
Electrical Requirements	115 V AC, 60 Hz 15 amp dedicated circuit
Shipping Weight	190 lbs

\*Depth is 24" from the front of the unit to its back. Your design may necessitate moving the unit back, or cabinets forward to achieve a flush fit. This will require a minimum opening depth of 25".

### INSTALLATION SPECIFICATIONS

#### Opening Dimensions

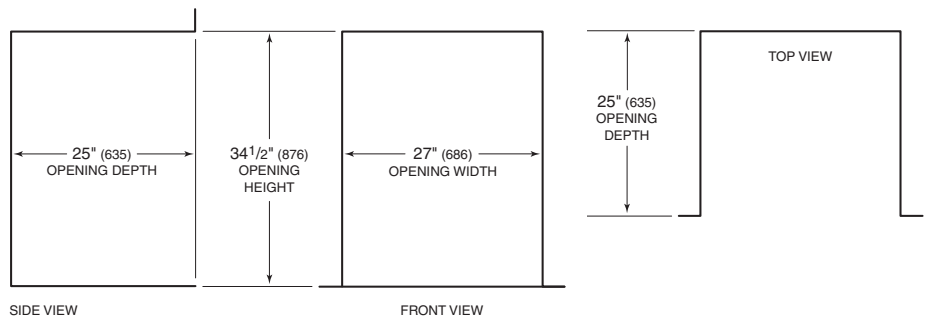

#### Location of Electrical Supply

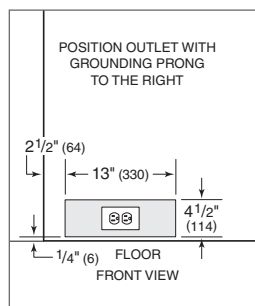

### INSTALLATION NOTES

Stainless steel drawer front panels with handles are available as accessories. These panels are not installed at the factory.

Complete installation specifications, including panel sizes, can be found on our website, [subzero.com/specs](http://subzero.com/specs).

Dimensions in parentheses are in millimeters unless otherwise specified.