

***BOSE***<sup>®</sup>

# LIFESTYLE<sup>®</sup> Homewide Powered Speaker System

Owner's Guide

Guía de usuario

Notice d'utilisation



# SAFETY INFORMATION

## Please read this owner's guide

Please take the time to follow the instructions in this owner's guide carefully. It will help you set up and operate your system properly and enjoy its advanced features. Please save this owner's guide for future reference.

### WARNINGS:

- To reduce the risk of fire or electrical shock, do not expose the product to rain or moisture.
- Do not expose this apparatus to dripping or splashing, and do not place objects filled with liquids, such as vases, on or near the apparatus. As with any electronic product, use care not to spill liquids into any part of the system. Liquids can cause a failure and/or a fire hazard.
- Do not place any naked flame sources, such as lighted candles, on or near the apparatus.



 The lightning flash with arrowhead symbol within an equilateral triangle alerts the user to the presence of uninsulated dangerous voltage within the system enclosure that may be of sufficient magnitude to constitute a risk of electric shock.

 The exclamation point within an equilateral triangle alerts the user to the presence of important operating and maintenance instructions in this owner's guide.

### Notes:

- The product label is located on the bottom of the product.
- Where the mains plug is used as the disconnect device, such disconnect device shall remain readily operable.
- This product must be used indoors. It is neither designed nor tested for use outdoors, in recreation vehicles, or on boats.
- Make no modifications to the system or accessories. Unauthorized alterations may compromise safety, regulatory compliance, and system performance.

**CE** The LIFESTYLE® Homewide Powered Speaker System conforms to the EMC Directive 2004/108/EC and to the Low Voltage Directive 2006/95/EC. The PERSONAL® music center II conforms to the RTTE Directive 99/5/EC (R+TTED). The complete Declarations of Conformity can be found at [www.Bose.com/static/compliance/index.html](http://www.Bose.com/static/compliance/index.html).

## Class B emissions

- This Class B digital apparatus meets all requirements of the Canadian Interference-Causing Equipment Regulations (Canada only).
- If applicable, the radio communication device incorporated into this apparatus meets all requirements of the Industry Canada standard RSS-310 (Canada only).

## Batteries



**Please dispose of used batteries properly**, following any local regulations. Do not incinerate.

## Additional safety information

See the additional instructions on the **Important Safety Instructions** sheet (North America only) enclosed in the shipping carton.

## INTRODUCTION ..... 1

Before you begin .....	1
Unpacking .....	1

## SYSTEM SETUP ..... 3

Placing the speaker system .....	3
Connecting the speakers to the module .....	5
Making a Bose® link connection .....	6
Making a wired Bose® link connection .....	7
Making a wireless Bose® link connection (optional) .....	8
Connecting the AC power cord .....	11
Installing the batteries .....	12
Preparing for an ADAPTiQ® calibration .....	13
Performing the ADAPTiQ® calibration .....	14

## USING THE PERSONAL® MUSIC CENTER II ..... 17

Controls and indicators .....	17
Setup mode .....	20
About audio streams .....	22
When to change the room code .....	22
When to change the house code .....	22

## LISTENING TO YOUR AUDIO SOURCES ..... 23

Selecting an audio source .....	23
Listening to stored music .....	23
Listening to the radio .....	26
Listening to a music CD .....	27
Listening to audio from a DVD .....	29
Listening to a Local source .....	30
Connecting a Local source .....	30
Selecting a Local source .....	30
Using Local source auto-detect .....	31
Listening to other sources (TV, VCR, CBL-SAT, AUX) .....	32

## USING MULTIPLE SPEAKER SYSTEMS ..... 33

Setting up additional rooms .....	33
Using multiple systems in the same expansion room .....	33
Changing the room code .....	33

## CARE & MAINTENANCE ..... 34

Cleaning .....	34
Limited warranty .....	34
Replacing the controller batteries .....	34
Troubleshooting .....	35
Customer service .....	36
Technical information .....	37

---

### **For your records**

Find the serial number on the bottom of the Acoustimass® module and record it here. This provides easy access to this number if you ever need to contact Bose® Customer Service.

Serial number: \_\_\_\_\_ Purchase date: \_\_\_\_\_

Dealer name: \_\_\_\_\_ Dealer phone: \_\_\_\_\_

Please keep your sales receipt with this owner's guide.

## Before you begin

---

Thank you for purchasing the LIFESTYLE® Homewide powered speaker system. This product is specifically designed to expand your Bose® link-enabled home entertainment system into another area of your home.

- Using the built-in ADAPTiQ® audio calibration system, you can make sure this system delivers the best possible performance in any setting.
- The stereo audio inputs on the Acoustimass® module connection panel allow you to listen to an external audio device through this premium speaker system.
- The included PERSONAL® music center II makes operating your Bose system from a second room easy and enjoyable.

---

**Note:** This system is delivered to you ready to operate using room code C. If another Bose product in your home uses room code C, you will need to use a different room code for your powered speaker system.

To learn how to change the room code in the PERSONAL® music center II, see “Setup mode” on page 20.

To change the room code in the speaker system, see “Changing the room code” on page 33.

---

## Unpacking

---

Check the carton for all the parts shown on the following page.

Save the carton and packing materials, which provide the safest way to transport this product.

If any part of the product appears to be damaged, do not attempt to use it. Contact your authorized Bose dealer immediately or call Bose Customer Service. Refer to the address list enclosed in the carton for contact information.

---

**Note:** Now is a good time to find the serial number on the bottom of your Acoustimass module and record it on page iv.

---

## INTRODUCTION

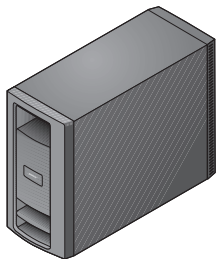
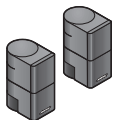
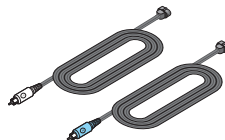
☐ Acoustimass® module☐ Acoustimass module rubber feet☐ 50-ft Bose® link B cable☐ AC power cord☐ 2 Jewel Cube® speakers☐ Rubber speaker feet☐ 2 speaker cables☐ Audio input cable☐ PERSONAL® music center II☐ 4 AA (IEC LR6) batteries☐ ADAPTiQ® headset☐ Demonstration CD

## 1 Placing the speaker system

What you need for this step:

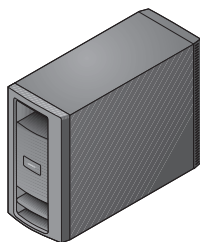

Acoustimass®  
module

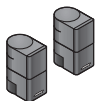

Jewel Cube®  
speakers

**Note:** You can mount Jewel Cube speakers on a wall or on floor stands. To purchase wall mounting brackets or floor stands, contact your local Bose® dealer or visit [www.Bose.com](http://www.Bose.com).

1. Place the Jewel Cube speakers on a stable, level surface; one to your left and one to your right:
  - 6-12 feet (1.8-3.6m) apart
  - At about ear height (when seated)
  - Within 20 feet (6.1m) (maximum speaker cable length) from the Acoustimass module
  - Near the front edge of the shelf if placed in an enclosed bookcase
  - With one cube of each speaker aimed forward into the room and the other aimed at a side wall to create reflected sound

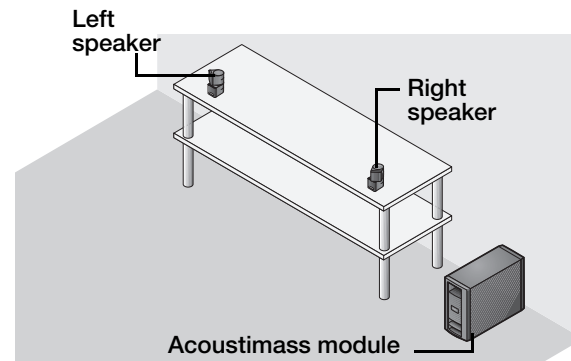

**CAUTION:** Vibration can cause speakers to move, particularly on smooth surfaces like marble, glass or highly polished wood. To reduce the chance of movement, Bose recommends that you attach the included rubber speaker feet to the bottom of the speakers.

## SYSTEM SETUP

2. Place the Acoustimass® module on the floor at the same end of the room as the front speakers:

- Standing upright (BEST) or laying on either side (ALTERNATE)

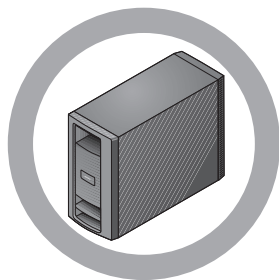

**BEST**

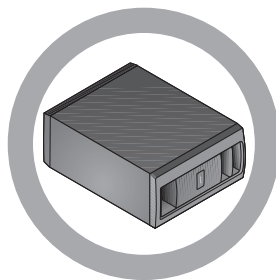

**ALTERNATE**

- With the front opening facing into the room
- Close to an AC (mains) outlet
- At least 18 in (45 cm) from any TV to avoid magnetic interference with the TV image. Move it farther away if you still notice interference.

**Note:** When placing the module on bare floors, you can attach the included rubber feet to the bottom of the module for stability and protection.

---

**CAUTION:** DO NOT stand the module on its front or back end.

---

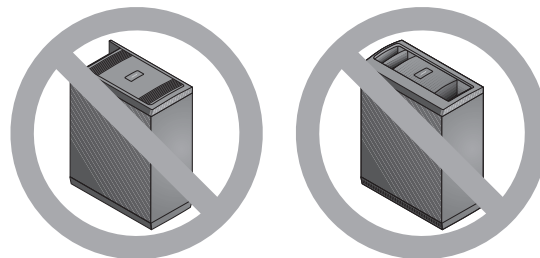

---

**CAUTION:** Do not put electronic media, such as video or audio tapes on or next to the module for long periods of time. The magnetic field surrounding the module may erase some or all of the recorded material.

---



---

**CAUTION:** DO NOT BLOCK the ventilation openings on the module. This can cause it to overheat.

---

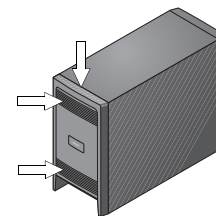

Continue with **2** on the next page.



## 2 Connecting the speakers to the module

What you need for this step:

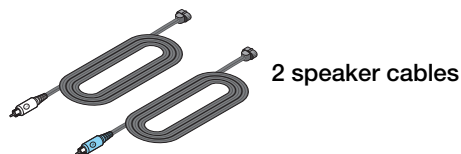

1. Lay the Acoustimass® module on its side as shown.
2. Insert the left (L) (gray) speaker cable plug into the left (L) (gray) connector on the Acoustimass module.
3. Insert the other end of the left (L) speaker cable into the left Jewel Cube® speaker connector.
4. Insert the right (R) (blue) speaker cable plug into the right (R) (blue) connector on the Acoustimass module.
5. Insert the other end of the right (R) speaker cable into the right Jewel Cube speaker connector.

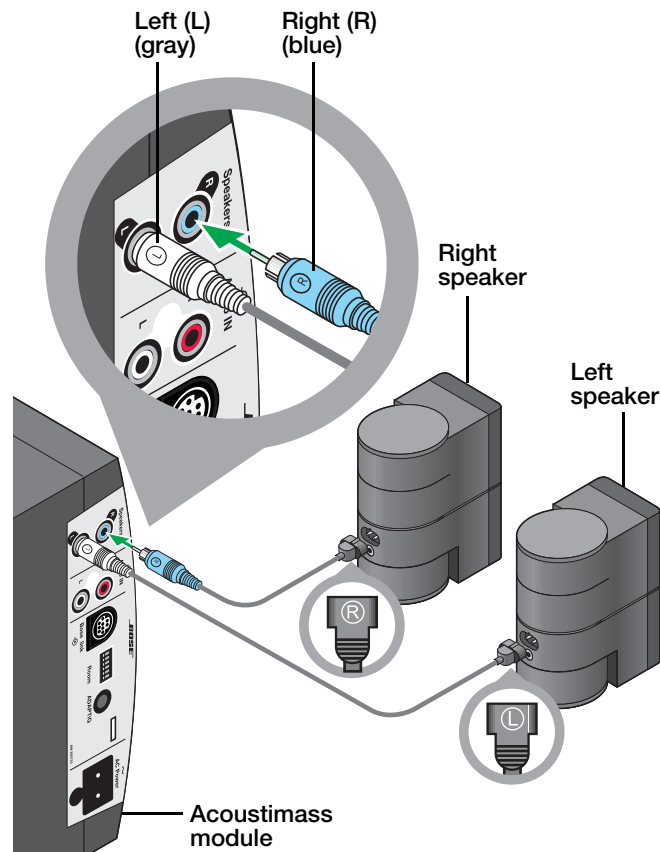
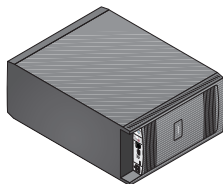

Continue with **3** on the next page.

## SYSTEM SETUP

### 3 Making a Bose® link connection

You can make a wired or wireless (optional) Bose link connection between your powered speaker system and your LIFESTYLE® home entertainment system.

#### Wired Bose link connection

You need:



50-ft Bose link B cable  
(included)

See “Making a wired Bose® link connection” on page 7.

#### Wireless Bose link connection (optional)

You need:

##### The Bose Link AL8 Homewide Wireless Audio Link (purchased separately)



AL8  
transmitter



AR1  
receiver

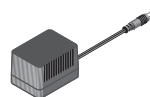

AC power  
pack

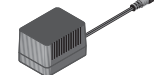

AC power  
pack



Bose link A  
cable



Bose link A  
cable

**Note:** Refer to the AL8 owner's guide for details on the proper placement of the transmitter and receiver.

See “Making a wireless Bose® link connection (optional)” on page 8.

**ATTENTION!**

If you are making a wireless Bose link connection, skip the instructions on this page and go to page 8.

**Making a wired Bose® link connection**

1. Plug one end of the Bose link B cable into the Bose link Speakers connector on your media center.

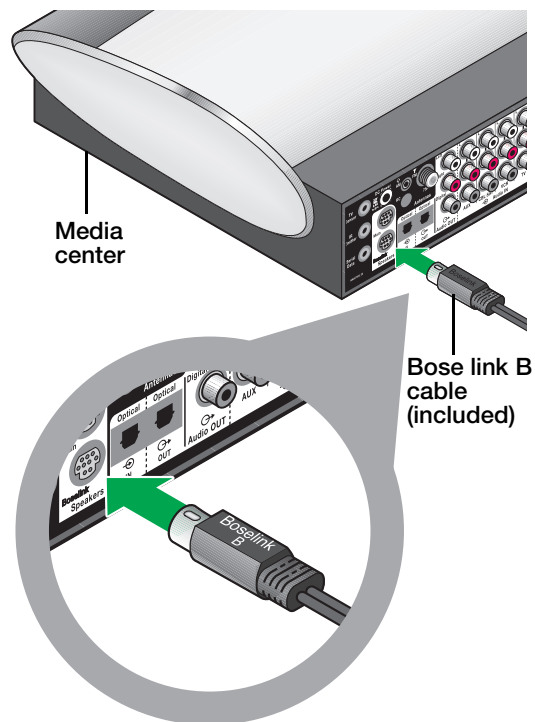

2. Route the Bose link B cable to the room where your powered speaker system is located.
3. Plug the other end of the Bose link B cable into the Bose link connector on the Acoustimass® module.

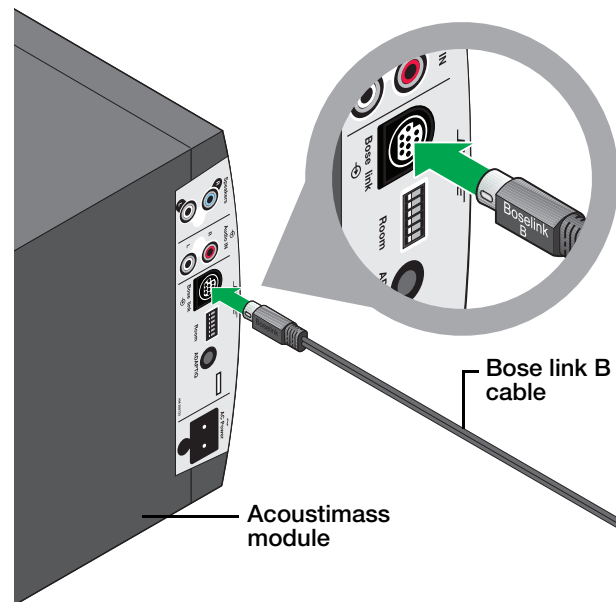

Continue with **4** on page 11.

## SYSTEM SETUP

**Making a wireless Bose® link connection (optional)**

1. Plug one end of a Bose link A cable (supplied with the AL8) into the INPUT connector on the AL8 transmitter.

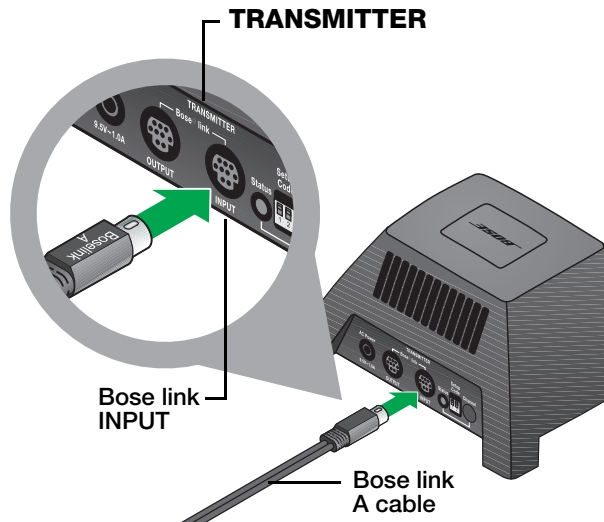

2. Plug the other end of the cable into the Bose link Speakers connector on your media center.

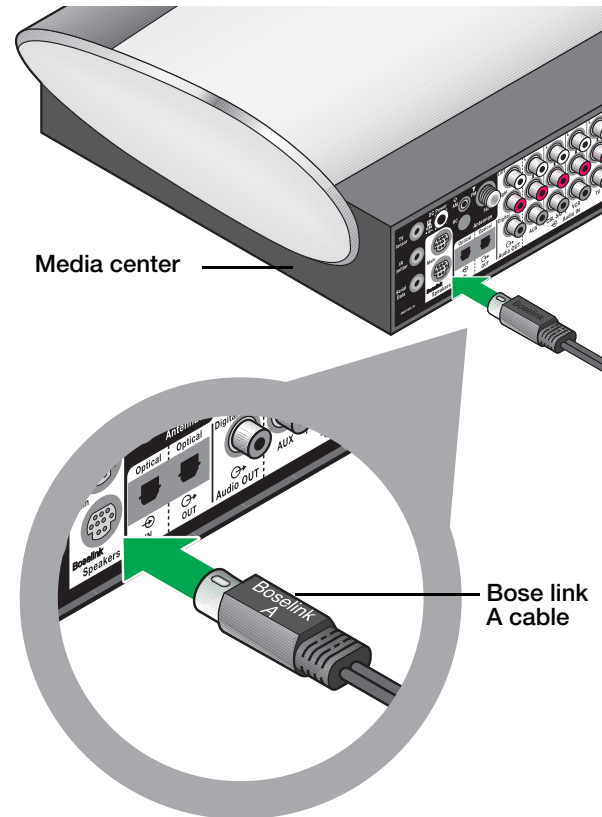

3. Plug the cord from one AC power pack into the AC power connector on the AL8 transmitter.
4. Plug the power pack into an AC outlet.

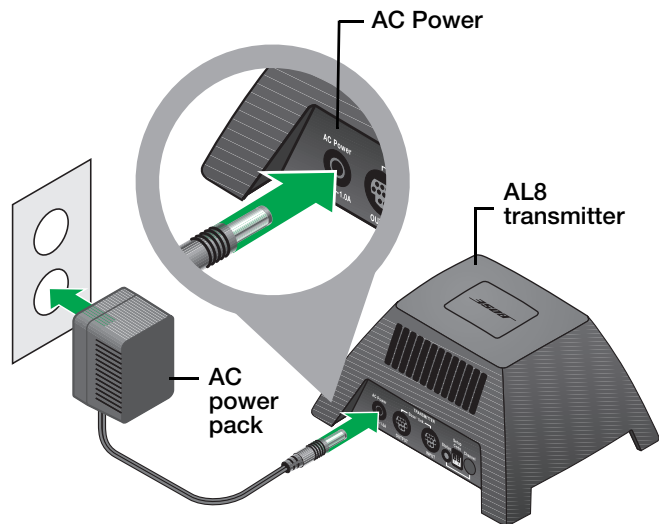

5. Plug one end of the other Bose® link A cable (supplied with the AL8) into the OUTPUT connector on the AR1 receiver.

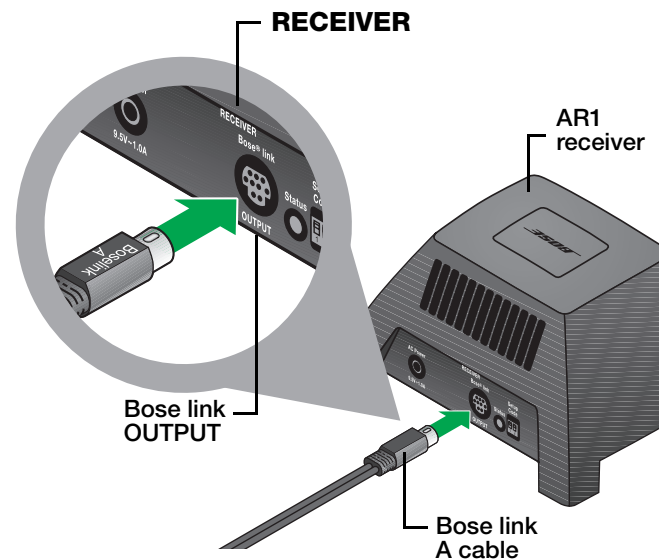

**SYSTEM SETUP**

6. Plug the other end of the cable into the Bose® link connector on the Acoustimass® module.

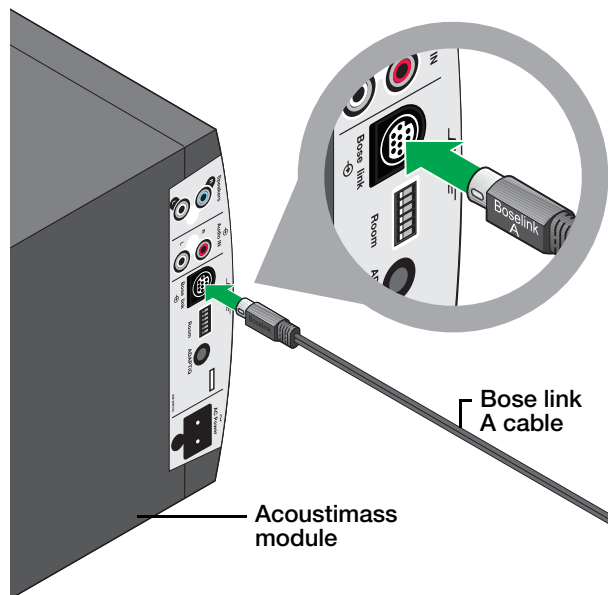

7. Plug the cord of the other AC power pack into the AC power connector on the AR1 receiver.
8. Plug the power pack into an AC outlet.

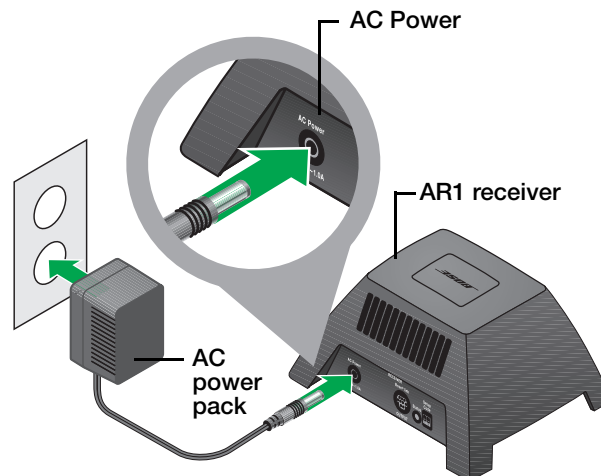

Continue with **4** on the next page.

## 4 Connecting the AC power cord

What you need for this step:

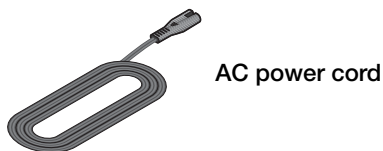

1. Plug one end of the AC power cord into the AC Power connector on the Acoustimass® module.
2. Plug the other end into an AC (mains) outlet.

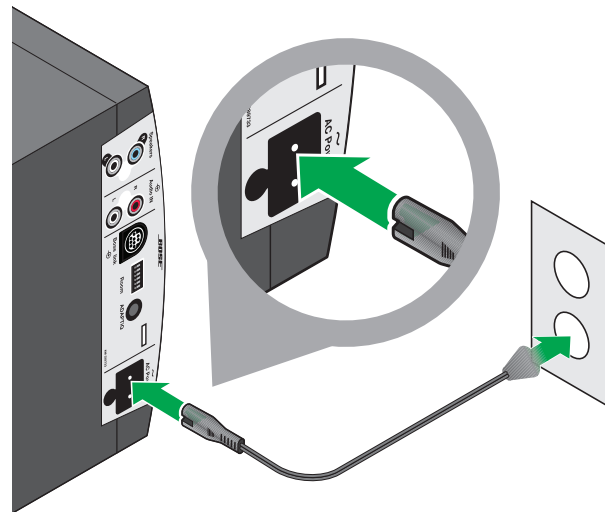

**Note:** Bose recommends using a safety agency-approved surge protector on all electronic equipment. Voltage variations and spikes can damage electronic components in any system.

Continue with **5** on the next page.

## SYSTEM SETUP

# 5 Installing the batteries

What you need for this step:

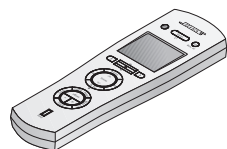

PERSONAL® music center II



Four AA (IEC LR6) batteries

1. Slide the battery compartment cover off the back of the controller.

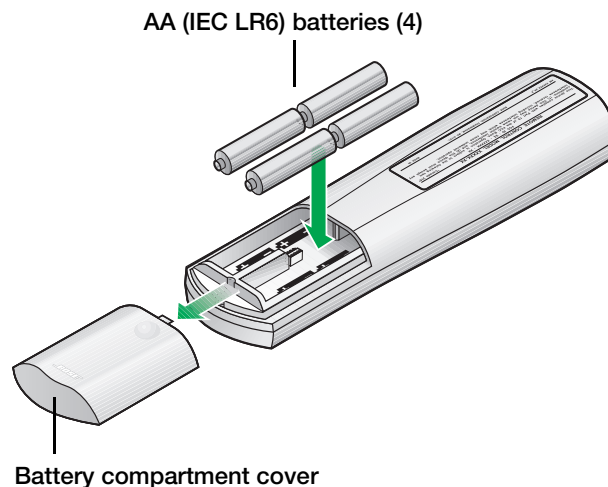

2. Install the four AA (IEC LR6) batteries, matching the polarity markings (+ and -) to the markings inside the battery compartment.
3. Slide the battery cover back into place.

Continue with **6** on the next page.



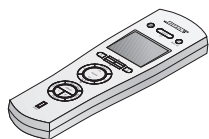

## 6 Preparing for the ADAPTiQ® calibration

What you need for this step:



PERSONAL® music center II

**Note:** If the PERSONAL® music center II displays a language other than the one you selected for your LIFESTYLE® home entertainment system, open the Setup menu and select Language:Update. See "Setup mode" on page 20.

1. Press  on the PERSONAL® music center II.
2. Press . A list of sources appears.

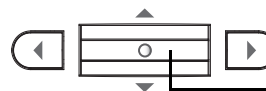
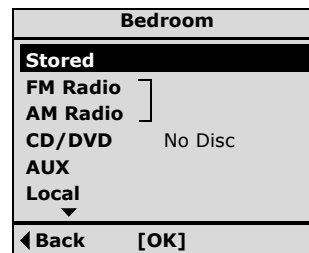

Navigation bar

3. Tilt the navigation bar up or down and select a source from the list. Press the navigation bar **[OK]** to confirm selection.
4. Verify that sound comes from both the left and right speakers and the Acoustimass® module.
5. Take this opportunity to further experiment with the position of the speakers or aim the cubes in different directions. When done, make sure all system components are in their chosen locations.

Continue with **7** on the next page.

## SYSTEM SETUP

## 7 Performing the ADAPTiQ® calibration

What you need for this step:



Audio input cable

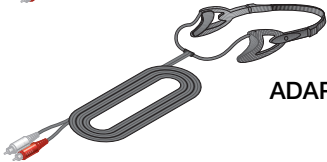

ADAPTiQ headset



PERSONAL® music center II

The ADAPTiQ audio calibration system customizes the sound of your system to the acoustics of your listening area.

To perform a calibration, you need about 10 minutes when the room is quiet. While wearing the special headset, the system will ask you to sit in five different locations in your listening area as the system takes measurements in each. Audio prompts from the system will guide you through the process.

1. Plug the male end of the audio input cable into the Audio IN connectors. Be sure to match the colors, red-to-red and white-to-white.

Connecting the audio input cable makes it easier to connect the ADAPTiQ® headset for the calibration process, or any external audio device (see “Connecting a Local source” on page 30) without moving the Acoustimass® module.

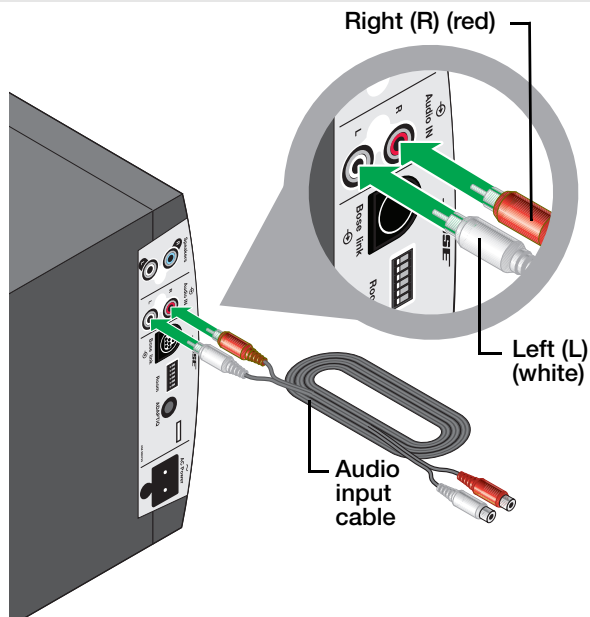

2. Plug the ADAPTiQ headset into the audio input cable. Be sure to match the colors, red-to-red and white-to-white.

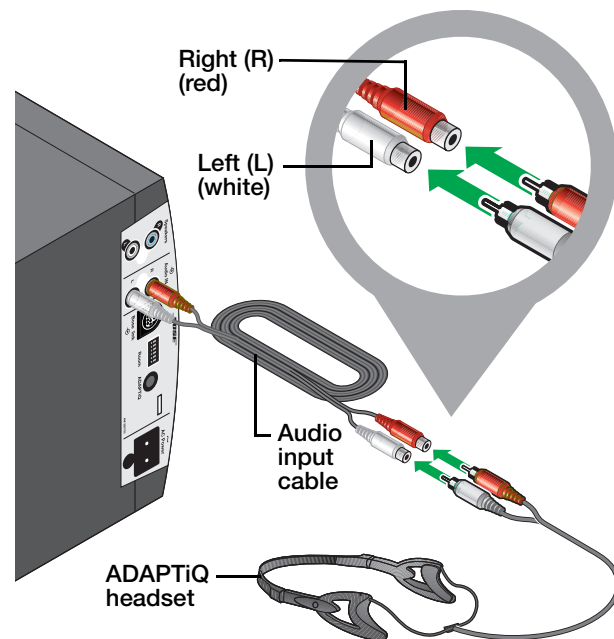

3. Put the headset on your head so the left and right sensors rest above your ears. This headset allows the system to hear exactly what you hear.



## SYSTEM SETUP

4. Press and release the **ADAPTiQ**® button on the Acoustimass® module connector panel. The system announces “English” as the selected language.

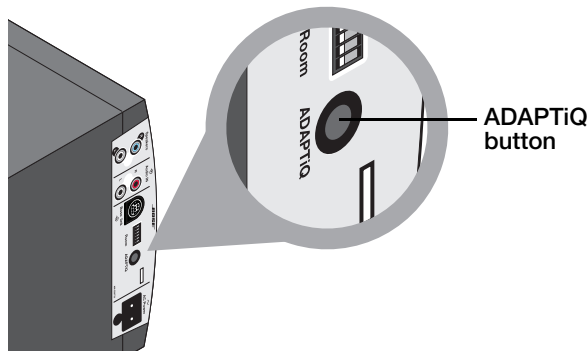

To select a different language, press **ADAPTiQ** repeatedly until you hear the language you want.

5. Press **Play** to continue in the selected language. Follow the audio prompts from your system to complete the process.
6. Place the module in its final position and orientation (standing on its feet or laying on its side).

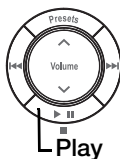

### During the process:

- If you get interrupted and are temporarily called away from the system, you can return within 10 minutes and continue. After 10 minutes, the system cancels the calibration process and returns to normal operation, leaving your system unchanged.
- To cancel and leave your system unchanged, press and release the **ADAPTiQ** button.
- To reset the system to factory settings, press and hold the **ADAPTiQ** button until you hear a confirmation message.

7. When the process is done, unplug the ADAPTiQ headset from the audio input cable and store it in a safe place.

You can leave the audio input cable connected for when you might need to connect the ADAPTiQ headset again or connect a local audio source. See “Listening to a Local source” on page 30.

### When would I need to run the ADAPTiQ calibration process again?

- If you rearrange the furniture in the room or place any speaker system component in a different location or orientation.
- If you move the speaker system to a different room.

# USING THE PERSONAL® MUSIC CENTER II

## Controls and indicators

The PERSONAL® music center II operates your Bose® entertainment system from any room in your home and allows you to control any Bose link-enabled product.

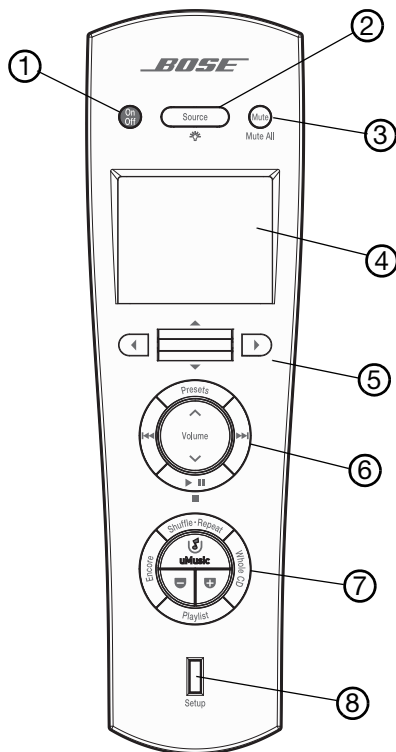

### ① On-Off

- Turns your system on/off in the Bose link room.
- When turned on, the source last selected is active.

### ② Source selection

- *Press*: Opens the list of system sources on the display.
- *Press and hold*: Turns LCD backlight on/off.

### ③ Mute/Mute All

- *Press*: Silences speakers in the Bose link room.



Displayed when Bose link speakers are muted.

- *Press and hold*: Silences all speakers in all rooms.



Displayed when all speakers are muted.

### ④ Display window

- A backlit LCD screen that provides operational and status information.
- Allows access to the same information available in the main room.

## USING THE PERSONAL® MUSIC CENTER II

### ⑤ Display navigation controls

Perform functions defined on the display.

#### Example:

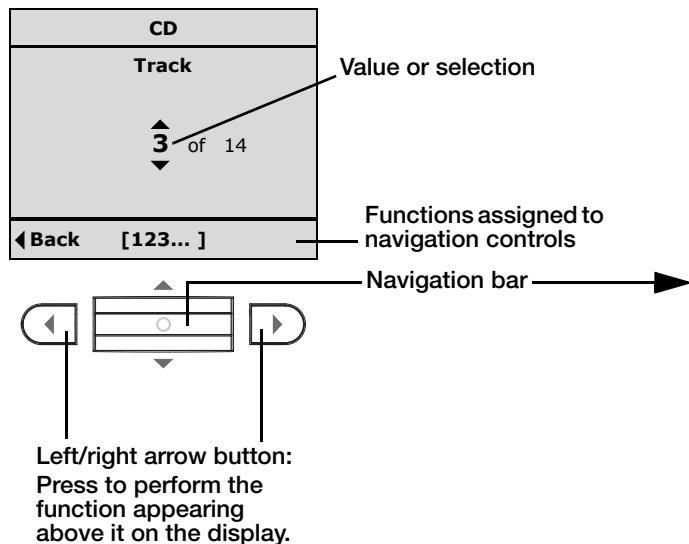

**Note:** Thirty seconds after your last interaction the display goes blank. Pressing the Source button turns on the display again. See "Setup mode" on page 20 to change the LCD delay setting.

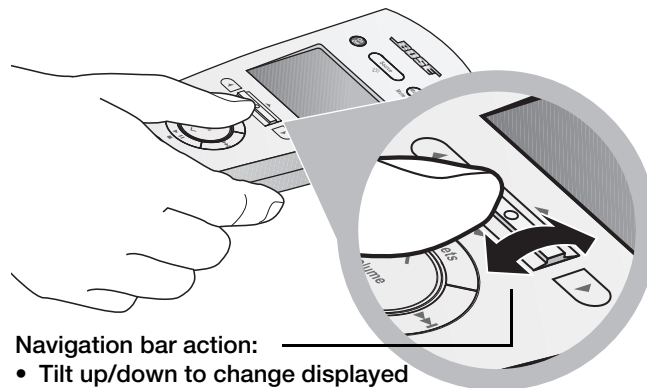

Navigation bar action:

- Tilt up/down to change displayed value or selection
- Press and release (without tilting) to perform the function appearing above it in brackets on the display

## ⑥ Playback controls

- Provides control of system sources including CDs, DVDs, and radio.
- Can control most functions of components connected to your system such as selecting channels on a cable or satellite box.

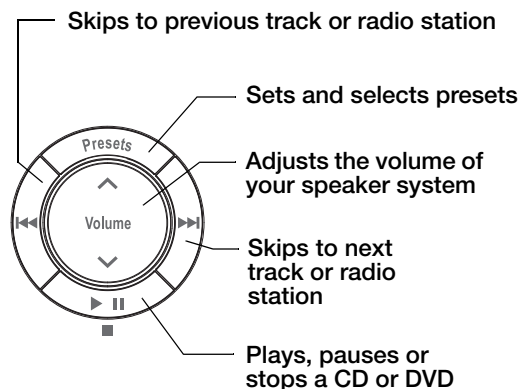

## ⑦ Music playback mode controls

- Allows you to select shuffle and repeat modes.
- Allows you to start the uMusic® intelligent playback system.
- Provides access to your stored music collection.

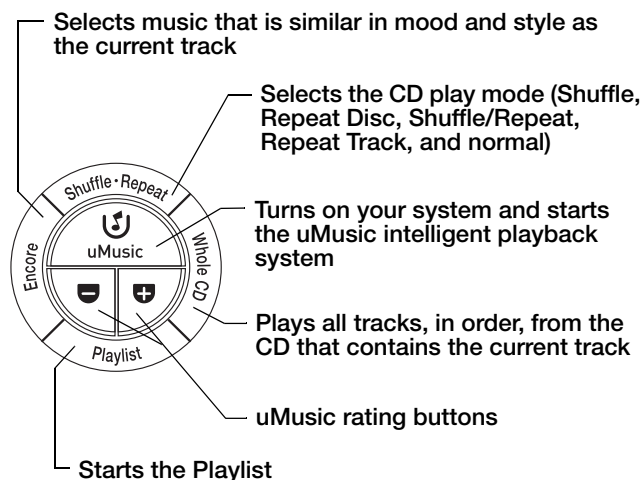

## ⑧ Setup

Opens the setup menu on the display. See "Setup mode" on page 20 to change a setting.

## USING THE PERSONAL<sup>®</sup> MUSIC CENTER II

### Setup mode

The setup mode allows you to change settings that affect the way the PERSONAL<sup>®</sup> music center II functions.

Default settings were chosen at the factory to satisfy most owners. However, if you wish to change any of the settings, use the Setup menu.

#### To change a setting:

1. Press **Setup** to display the Setup menu.

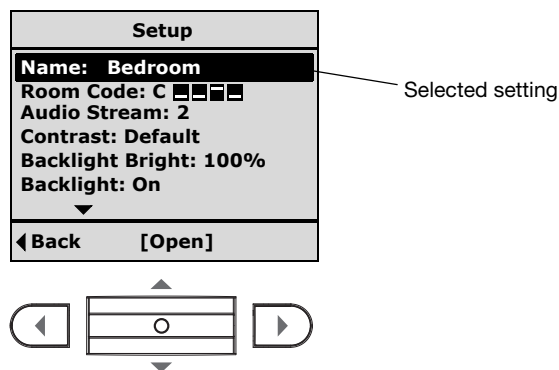

2. Tilt the center bar up/down to select a menu item. Refer to the table on the following page for menu item descriptions.
3. Press **[Open]**.
4. Tilt the center bar up/down to select the setting you want.
5. Press **[OK]** to confirm your choice, or press **Back** to leave the setting unchanged.
6. Press **Setup** to exit the menu.



Setup Item	Description	Available settings (bold type indicates factory setting)
Name	Identifies the location of your powered speaker system.	Attic, Basement, Bathroom, Bathroom 1-3, <b>Bedroom</b> , Bedroom 1-5, Deck, Den, Dining Room, Family Room, Foyer, Garage, Guest Room, Home Theater, Kitchen, Library, Living Room, Master Bedroom, Media Room, Office, Office 1-2, Outside, Patio, Play Room, Pool, Pool House, Porch, Study, Sun Room
Room Code	Enables your PERSONAL® music center II to control the audio delivered to a Bose® link enabled speaker system set to the same letter code (see “When to change the room code” on page 22).	A, B, <b>C</b> , D, E, F, G, H, I, J, K, L, M, N
Audio Stream	Selects the audio stream delivered to your Bose link room (see “About audio streams” on page 22).	Audio 1 - Audio stream delivered to the main room. <b>Audio 2</b> - Audio stream delivered to the Bose link connection.
Contrast	Changes the display contrast between text and background.	-3, -2, -1, <b>0</b> , +1, +2, +3
Backlight Bright	Changes the brightness intensity of the display backlight. Choose a lower % setting to reduce intensity.	20%, 30%, 40%, 60%, 80%, <b>100%</b>
Backlight	Determines if backlight is on or off whenever you activate the display.	Off, <b>On</b>
LCD Delay	Determines how long the display remains on after your last interaction.	10 sec, 20 sec, <b>30 sec</b> , 40 sec, 50 sec, 60 sec
House Code	Enables your controller to operate your LIFESTYLE® home entertainment system (see “When to change the house code” on page 22).	<b>0</b> , 1, 2, 3, 4, 5, 6, 7, 8, 9, 10, 11, 12, 13, 14, 15 <b>NOTE:</b> Must always match the house code in the Bose system in your main room.
Language	Updates the controller with the same language used in the media center.	<b>Update</b> Press the navigation bar <b>[Open]</b> to update.
Version	Identifies current software version.	NOT USER ADJUSTABLE.

## USING THE PERSONAL® MUSIC CENTER II

---

### About audio streams

---

Your LIFESTYLE® system produces two independent audio streams called Audio 1 and Audio 2. Audio 1 is delivered to the speakers in your home entertainment system and what you hear is controlled by the remote used in that room. Audio 2 is delivered to your new powered speaker system and what you hear is controlled by the PERSONAL® music center II. This capability allows you play a source on Audio 2 that is different than the source playing on Audio 1.

While the PERSONAL® music center II is set at the factory to control Audio 2, you can change it to Audio 1 and always listen to the source playing on that stream:

1. Turn off the powered speaker system.
2. Change the Audio Stream setting in the Setup menu to Audio 1 (see “Setup mode” on page 20).
3. Turn on the powered speaker system again.

### When to change the room code

---

The PERSONAL® music center II and your speaker system must have identical room codes. Both are set at the factory for room code C. If room code C is already used by another Bose® link product in your home you need to change both items to another room code.

To change the room code on the The PERSONAL® music center II, use the Setup mode. See the instructions on page 20.

To change the room code on the speaker system, see “Changing the room code” on page 33.

### When to change the house code

---

Your PERSONAL® music center II is set at the factory with a house code identical to the factory setting on other LIFESTYLE® systems and remote controls. If you have not changed the house code setting in your LIFESTYLE® system, there is no need to change that code in your PERSONAL® music center II.

A LIFESTYLE® system radio frequency (RF) remote has a long range and the ability to penetrate walls. Therefore, the signals from a remote in one home can possibly reach and affect the operation of a LIFESTYLE® system in a nearby home. Changing the house code for the system and all the remotes used with it avoids possible conflict.

To change the house code in your media center, see the owner's guide that came with your LIFESTYLE® home entertainment system.

To change the house code in your PERSONAL® music center II, see the instructions on page 20.

# LISTENING TO YOUR AUDIO SOURCES

## Selecting an audio source

1. Press **Source**. The list of available system sources appears on the display.

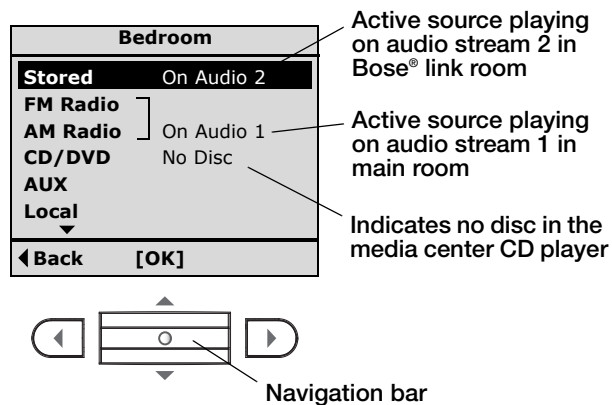

2. Tilt the navigation bar up/down to select a source.
3. Press **[OK]** to confirm. The operating screen for the selected source is displayed.

**Note:** If the *Stored* source is not in the source list, either your system does not have this feature, or there are no stored CDs in the system. Refer to your system owner's guide for instructions on how to store CDs.

## Listening to stored music

1. Press **Source**.
2. Select *Stored* from the source list and press **[OK]**.

OR

Press the **uMusic®** button.

Stored source operating information appears on the display.

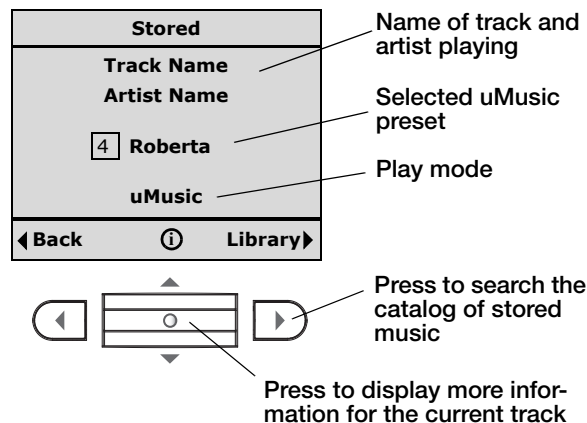

### To change track:

Tilt the navigation bar up/down. The next track selected by the uMusic playback system starts playing.

## LISTENING TO YOUR AUDIO SOURCES

### More Stored source controls:

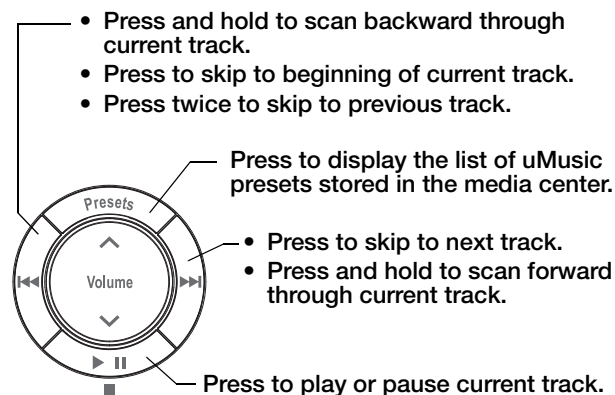
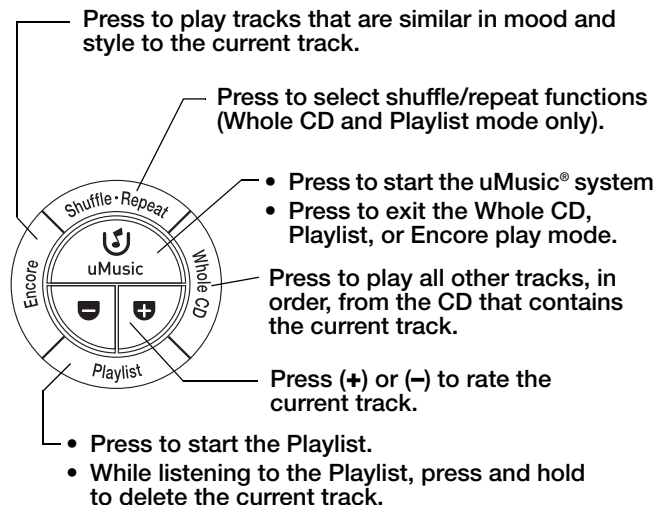

**Note:** See your LIFESTYLE® home entertainment system owner's guide for more information on the uMusic playback system and rating controls.

### To search the library of stored music:

1. Press **Library** (  ) while listening to Stored music.

The Music Library screen appears on the display:

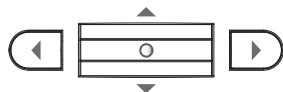

2. Select a category you want to modify and press **[Open]**.

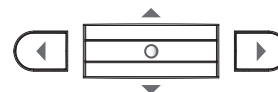
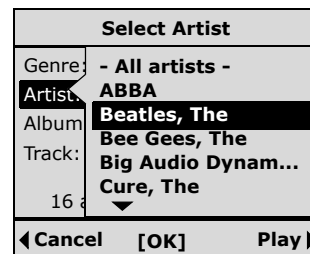

3. Select a setting and press **[OK]**.
4. Change settings for any other categories to narrow your search.
5. Press **Play**.
6. Press **Back** to return to the Stored source display.

## LISTENING TO YOUR AUDIO SOURCES

### Listening to the radio

Select FM radio or AM radio from the source list and press **[OK]**. Radio operating information appears on the display.

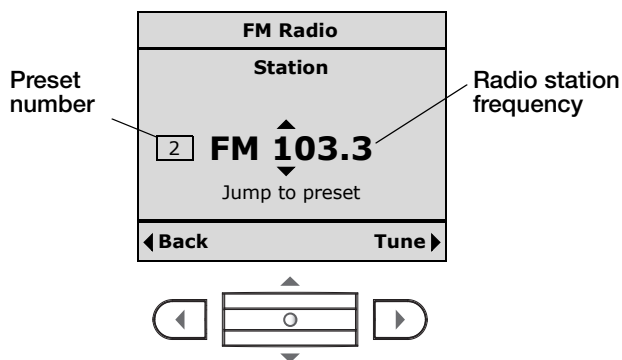

#### To tune to a radio station:

- Tilt the navigation bar up or down to jump to the next or previous preset station.
- OR
- Press **Tune**. Then tilt the navigation bar up/down to change the frequency.

#### More radio controls:

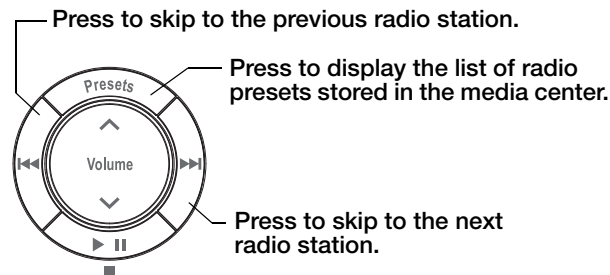

#### To store a station in the next available preset:

1. Tune to the station.
2. Press and hold **Presets** until the next available preset number appears on the display to the left of the station frequency.

#### To store a station in a specific preset:

1. Press **Presets** to see the list of stored presets.
2. Select a preset number from the list.
3. Press **Edit**.
4. Tilt the navigation bar up or down to tune to the station you want for the selected preset.
5. Press **[OK]**.

## Listening to a music CD

Select CD/DVD from the source list. Make sure there is a CD in the disc tray of the media center.

CD source information appears on the display and tells you if the disc is an audio CD or an MP3 CD.

### For an audio CD:

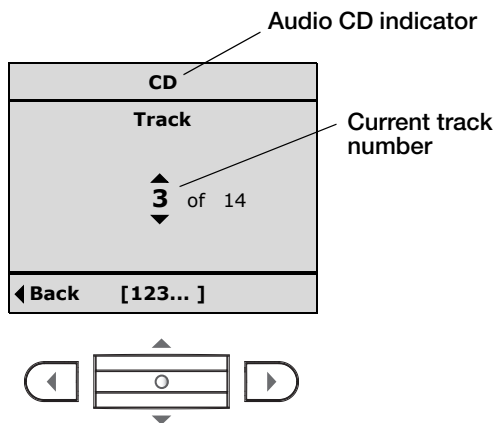

### For an MP3 CD:

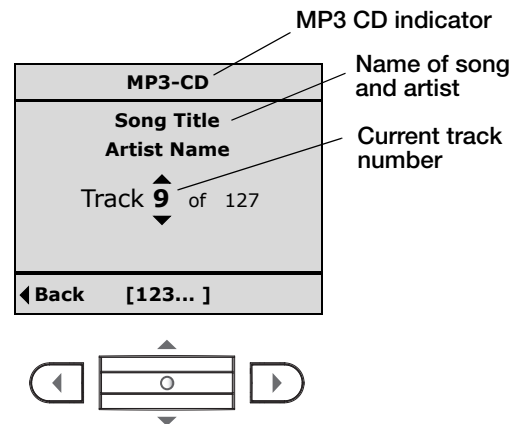

### To play a different track:

Tilt the navigation bar up or down until the track number you want appears.

## LISTENING TO YOUR AUDIO SOURCES

### To select a specific track by number:

1. Press the navigation bar. The following appears on the display:

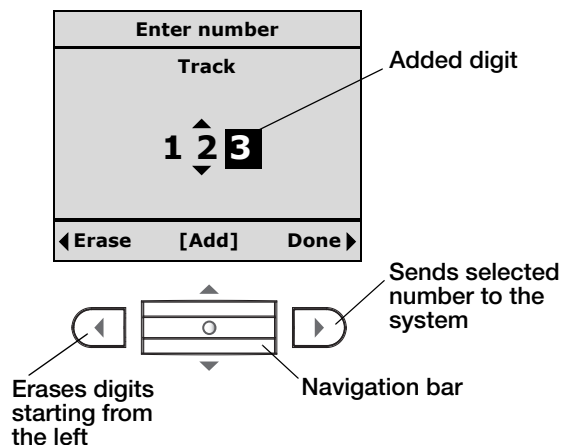

2. Tilt the navigation bar up/down to increase/decrease the highlighted number.
3. Press the navigation bar to add another digit to the right. Press **Erase** to delete a digit. When the number you want is displayed, press **Done**.

### More CD playback controls:

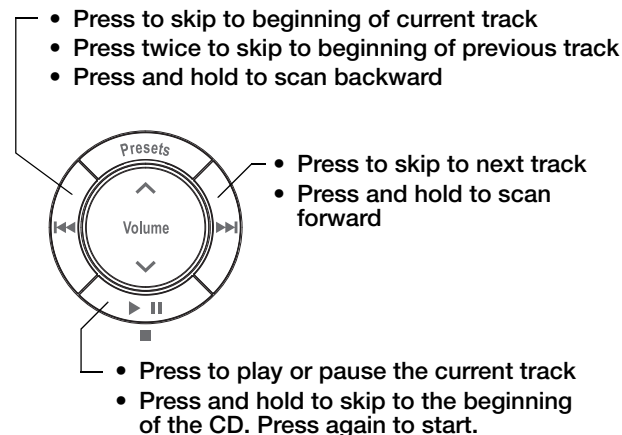



## Listening to audio from a DVD

Select CD/DVD from the source list. Make sure there is a DVD in the disc tray of the media center.

DVD source information appears on the display.

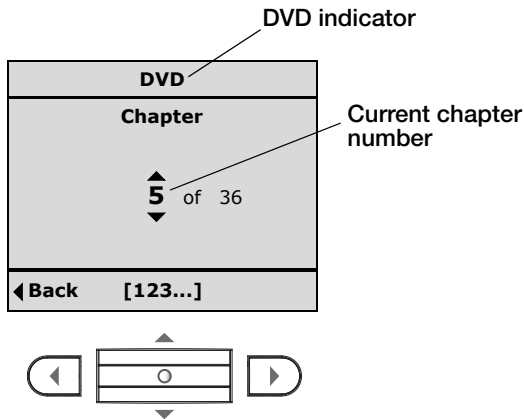

### To change the chapter or track number:

Tilt the navigation bar up/down until the number you want appears. Your choice begins to play automatically.

### To select a specific chapter/track by number:

Press **[123...]**. Refer to “To select a specific track by number:” on page 28.

### More DVD playback controls:

- Press to skip to beginning of current chapter/track
- Press twice to skip to beginning of previous chapter/track
- Press and hold to scan backward

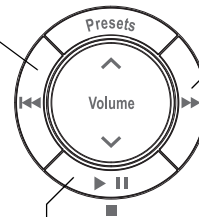

- Press to skip to next chapter/track
- Press and hold to scan forward
- Press to play or pause the current chapter/track
- Press and hold to skip to the beginning of the disc. Press again to start.

## LISTENING TO YOUR AUDIO SOURCES

### Listening to a Local source

A Local source is an audio device, such as a TV or a portable CD or MP3 player, that is connected to the Audio IN connectors on the Acoustimass® module.

#### Connecting a Local source

- Plug the output cable from your audio device into the audio input cable. During setup, this cable was plugged into the Audio IN connectors on the rear panel of the Acoustimass module.
- Be sure to match the connector colors, red-to-red and white-to-white.

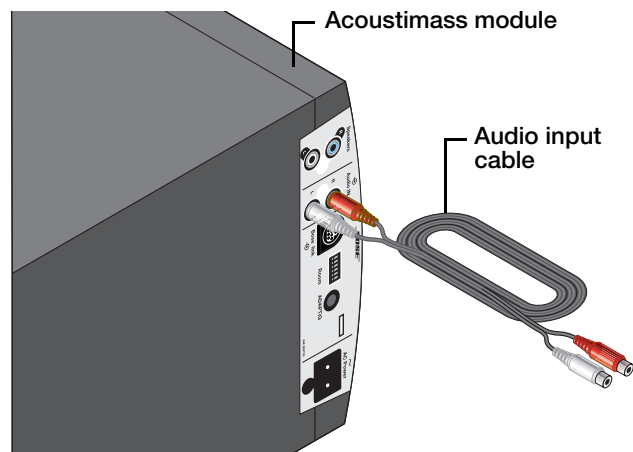

### Selecting a Local source

1. Turn on the Local device.
2. Press **Source** on the PERSONAL® music center II.
3. Select **Local** and press **[OK]**. The Local source operating information appears on the display.

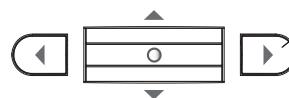
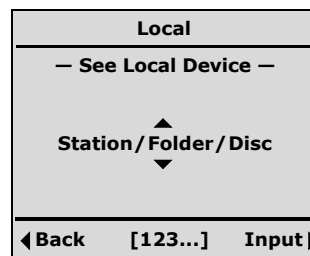

Changes sources or inputs on a local source

## Using Local source auto-detect

When enabled, the Local source auto-detect feature senses when you turn on your Local source. Your system reacts by automatically turning on (if it was off) and selecting the Local source.

One minute after the Local source stops playing, your system will automatically turn off (if it was previously off) or switch back to the previous source (if your system was already on when you turned on your Local source).

**To enable Local source auto-detect**, slide switch B up on the Acoustimass® module connection panel.

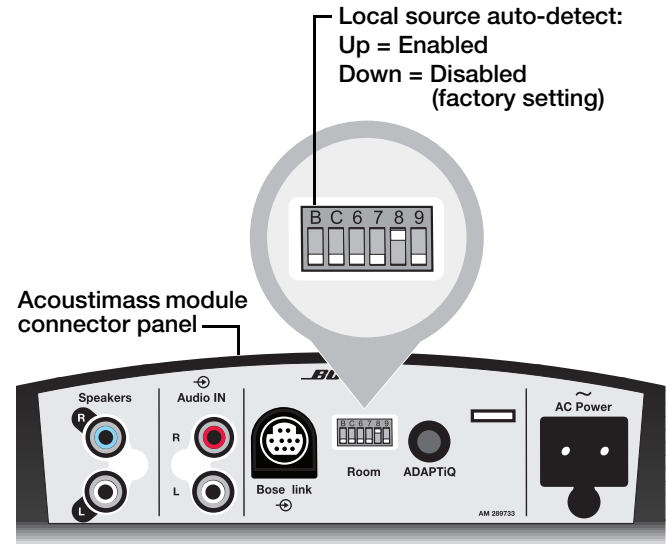

## LISTENING TO YOUR AUDIO SOURCES

---

### Listening to other sources (TV, VCR, CBL-SAT, AUX)

---

If you have other components, such as a TV, VCR, or cable/satellite box, connected to your LIFESTYLE® home entertainment system, you may be able to control them with the PERSONAL® music center II.

To do this, you must first set up your LIFESTYLE® home entertainment system to control other components. See your LIFESTYLE® home entertainment system owner's guide for instructions.

---

**Note:** *The PERSONAL® music center II will not turn components connected to your LIFESTYLE® system on or off.*

---

Once your system is set up and the component is turned on:

- For a video component, use the up and down arrows  on your PERSONAL® music center II to change channels.

Or use numeric entry as described on page 27. You can enter up to 5 digits.

- For other components, you may also be able to seek, pause, and resume play as you can for a CD or DVD playing on the system. However, this depends on the type and brand of the connected equipment.

## USING MULTIPLE SPEAKER SYSTEMS

### Setting up additional rooms

The PERSONAL® music center II and your speaker system must have identical room codes. Both are set at the factory for room code C. If room code C is already used by another Bose® link product in your home, you need to change both items to another room code.

### Using multiple systems set to the same room code

To make multiple systems operate as one system:

- Make sure each system has the same room code.
- Leave switch C (Primary) down on one system and push it up (Secondary) on all other systems.

Primary/Secondary unit:  
Up = Secondary  
Down = Primary

Acoustimass® module  
connector panel

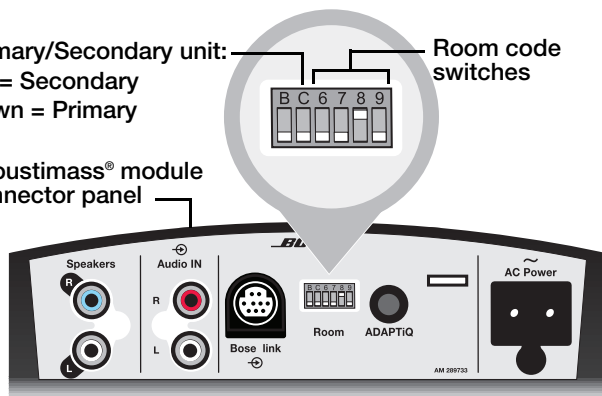

### Changing the room code

To change the speaker system room code, change the switch settings on the connector panel to another room code. Then make sure you change the room code setting in the controller. Refer to “Setup mode” on page 20.

Room



Room



## CARE & MAINTENANCE

### Cleaning

To clean your powered speaker system or PERSONAL® music center II, wipe the enclosure using a soft, dry cloth. You can also lightly vacuum the grille on the speakers.

- DO NOT use solvents, chemicals, or sprays.
- DO NOT allow liquids to spill or objects to drop into any openings.

### Limited warranty

Your LIFESTYLE® homewide powered speaker system and PERSONAL® music center II are covered by a transferable limited warranty. See your product registration card for details. Please be sure to fill out the information section on the card and mail it to Bose. Failure to do so will not affect your limited warranty.

### Replacing the controller batteries

Replace the batteries when you notice a marked decrease in the range or response of your PERSONAL® music center II, or when the battery indicator (  ) on the display reads low.

1. Slide the battery compartment cover off the back of the controller.

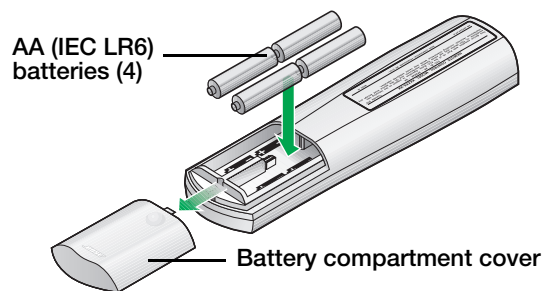

2. Remove the old batteries.
3. Install four new AA (IEC LR6) batteries, matching the polarity markings (+ and -) to the markings inside the battery compartment.
4. Slide the battery cover back into place.

## Troubleshooting

Problem	What to do
My PERSONAL® music center II does not work as expected; response to commands is intermittent	<ul style="list-style-type: none"> <li>• Replace the batteries.</li> <li>• Move it a foot or two to a different location and try again. In some buildings, you may experience dead spots when the PERSONAL® music center II will not operate effectively.</li> <li>• Make sure the cord that connects the power supply to the LIFESTYLE® system media center (which contains the remote antenna) is straightened and separated from other power cords.</li> <li>• Try moving the LIFESTYLE® media center a few feet to see if this provides a better response.</li> <li>• Try connecting an antenna extender to the media center. Refer to your LIFESTYLE® system installation guide.</li> </ul>
No sound	<ul style="list-style-type: none"> <li>• Make sure your powered speaker system is plugged in and that it has a Bose® link connection to the media center.</li> <li>• Make sure the speaker cable plugs are pushed all the way into the Jewel Cube® connectors.</li> <li>• Make sure you have selected a source on the PERSONAL® music center II.</li> <li>• Increase the system volume.</li> <li>• Press <b>Mute</b> on the PERSONAL® music center II.</li> <li>• Make sure the house code setting in the PERSONAL® music center II matches the house code in the main room remote.</li> <li>• Make sure the PERSONAL® music center II room code setting matches the powered speaker system room code setting. Unless you changed it, the room code setting in both rooms should be room C.</li> </ul>

## CARE & MAINTENANCE

Problem	What to do
My system turns on or off unexpectedly or makes changes when no buttons have been pushed on the PERSONAL® music center II	<ul style="list-style-type: none"> <li>• Try changing the house code. You may be experiencing a control conflict with another nearby LIFESTYLE® system.</li> <li>• Refer to your LIFESTYLE® operating guide for details on when and how to change the house code.</li> </ul>
Cannot hear my Local source	<ul style="list-style-type: none"> <li>• Make sure the cable from the external device is plugged into the Audio IN connectors on the Acoustimass® module.</li> <li>• Make sure the external device is turned on.</li> <li>• Turn up the volume on the external device.</li> </ul>

## Customer service

For additional help in solving problems, contact Bose® Customer Service. See the address and phone number list included with your LIFESTYLE® powered speaker system.



## Technical information

---

### Powered Speaker System

#### Dimensions

Jewel Cube® speaker: 4.4" H x 2.2" W x 3.2" D  
(11.2 cm x 5.6 cm x 8.1 cm)

Acoustimass® module: 13.0" H x 8.0" W x 21.7" D  
(33.2 cm x 20.7 cm x 55.2 cm)

#### Weight

Jewel Cube speaker: 1.0 lb (0.5 kg)  
Acoustimass Module: 26.2 lb (11.9 kg)

#### Power rating

100-120/220-240V ~ 50/60 Hz, 350W  
Power consumption (OFF mode): ≤4W

### PERSONAL® music center II

#### Remote control range

80 ft (24.4 m)

#### Dimensions

1" H x 2½" W x 8¼" L (3 cm x 6 cm x 21 cm)

#### Weight with batteries installed

0.7 lb (.3 kg)

#### Battery type

1.5V AA (IEC LR6) batteries (4)

#### Frequency

U.S./Canada: 27.145 MHz  
Europe: 40.685 MHz

#### RF Field Strength

Peak level: 88 dBμV/m @ 3 meters



312936

***BOSE***<sup>®</sup>  
***Better sound through research***<sup>®</sup>

©2008 Bose Corporation, The Mountain,  
Framingham, MA 01701-9168 USA  
AM312936 Rev.00