

INTEGRATED TALL DOUBLE DISHDRAWER™

PLANNING GUIDE

SERIES 11 | DD24DTX6I1 | DD24DTX6HI1

INTRODUCTION

This comprehensive planning guide provides you with the framework and tools to achieve your desired design outcome with Fisher & Paykel appliances. In this guide, you will find a range of conceptual, detailed, and dimensional product information to bring your ideas to life and create spaces that truly reflect your vision.

SUPPORT

For additional design planning and installation support please contact the Fisher & Paykel design support team.
designsupport@fisherpaykel.com

NOTES

The models shown in this Planning Guide may not be available in all markets and are subject to change at any time. Refer to our website fisherpaykel.com for the latest document version. Product specifications may vary from those shown. This Planning Guide should not be used as installation guidance for any product. Specific installation guidance will be available with the product on delivery and on our website.

CONTENTS

CONCEPT DESIGN	PAGE	DEVELOPED AND DETAILED DESIGN	PAGE	DEVELOPED AND DETAILED DESIGN	PAGE
Design choices	3	Specification guide	7	Custom door panel preparation	22
Single drawer	4	Specifications	8	Custom panel preparation	23
Double drawer and door	5				
Integrated dishwashers	6	Data sheets	9	Services	24
		Dishdrawer™ with custom panels	10	Service placement options	25
		Dishdrawer™ with pre-finished panels	11	Service specifications	26
		Dishdrawer™ with recessed handle drawer panels	12	Electrical and plumbing specifications	27
		Accessories	13	Data sheets: Handles	28
		Handles	14	Contemporary square fine handle	29
		Stainless steel panels	15	Contemporary round handle	30
				Classic round handle	31
		Planning considerations	16	Professional round flush handle	32
		Cavity specifications	17		
		Over width cavity specifications	18		
		Pre-finished toe kick	19		
		Custom toe kick specifications	20		
		Custom panel specifications	21		

DESIGN CHOICES

DOUBLE DRAWER INTEGRATED

DOUBLE DRAWER PRE-FINISHED

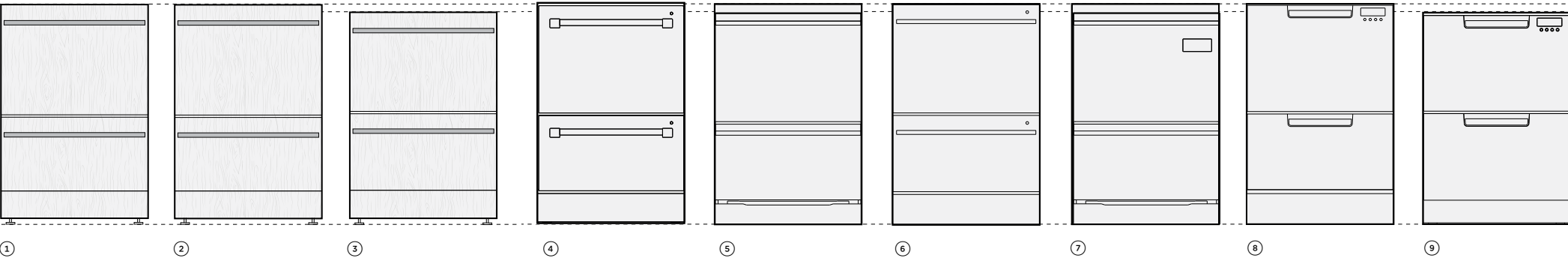

STYLE				MODELS	PANEL OPTIONS	HANDLE OPTIONS	HEIGHT		WIDTH		DEPTH	
							in	mm	in	mm	in	mm
①	Integrated	Tall Double DishDrawer™	Series 11	DD24DTX6I1 DD24DTX6HI1	Custom panel, Brushed Stainless Steel Recessed Handle Black Matte Glass Recessed Handle Brushed Stainless Steel	Contemporary, Professional and Classic, internal control panel	34 - 36 3/8	865-925	23 9/16	599	22 1/2	571
②	Integrated	Tall Double DishDrawer™	Series 9	DD24DTI9 N DD24DHTI9 N	Custom panel, Brushed Stainless Steel Recessed Handle Black Matte Glass Recessed Handle Brushed Stainless Steel	Contemporary, Professional and Classic, internal control panel	34 - 36 3/8	865-925	23 9/16	599	22 1/2	571
③	Integrated	Double DishDrawer™	Series 9	DD24DI9 N	Custom panel Brushed Stainless Steel	Contemporary, Professional and Classic, internal control panel	32 5/16 - 34 5/8	820-880	23 9/16	599	22 1/2	571
④	Professional Professional	Tall Double DishDrawer™ Tall Double DishDrawer™	Series 11 Series 9	DD24DTX6PX1 DD24DV2T9 N	Stainless Steel Stainless Steel	Professional stainless steel handle, internal control panel	34 - 36 3/8	864 - 924	23 9/16	599	22 9/16	573
⑤	Contemporary	Tall Double DishDrawer™	Series 9	DD24DT4NX9	Stainless Steel	Recessed handle, internal control panel	34 - 36 3/8	864 - 924	23 9/16	599	22 9/16	573
⑥	Contemporary	Tall Double DishDrawer™	Series 9	DD24DDFTX9 N	Stainless Steel	Contemporary stainless steel handle, internal control panel	34 - 36 3/8	864 - 924	23 9/16	599	22 9/16	573
⑦	Contemporary	Tall Double DishDrawer™	Series 7	DD24DT2NX9	Stainless Steel	Recessed handle, external control panel	34 - 36 3/8	864 - 924	23 9/16	599	22 9/16	573
⑧	Contemporary	Tall Double DishDrawer™	Series 7	DD24DCTX9 N DD24DCHTX9 N	Stainless Steel Stainless Steel	Pocket handle, external control panel	34 - 36 3/8	864 - 924	23 9/16	599	22 9/16	573
⑨	Contemporary	Double DishDrawer™	Series 7	DD24DAX9 N	Stainless Steel	Pocket handle, external control panel	32 5/16- 34 5/8	820 - 880	23 9/16	599	22 9/16	573

The models shown in this Planning Guide may not be available in all markets and are subject to change at any time. Product specifications may vary from those shown. This Planning Guide should not be used as installation guidance for any product. Further information is required to safely and correctly install the products featured here. Specific installation guidance will be available with the product on delivery and on our website fisherpaykel.com

SPECIFICATION GUIDE



OVERVIEW

Install your DishDrawer™ Dishwasher into an existing kitchen space or integrate into kitchen cabinetry. The touch-sensitive control panel is located inside this Integrated model, leaving an uninterrupted exterior that blends seamlessly with surrounding cabinetry.

PRODUCTS

DD24DTX6I1
Integrated Dishdrawer™, 24" wide

DD24DTX6HI1
Integrated Dishdrawer™ with water softener, 24" wide

ACCESSORIES

PRE-FINISHED PANEL ADDD24DTPX
Brushed stainless steel pre-finished panels

PRE-FINISHED PANEL - RECESSED HANDLE
Black black glass panels ADDD24DTZB
Stainless steel panels ADDD24DTNX

HANDLES

Handles are available for the Dishdrawer™ including Contemporary, Professional, and Classic styles. Options include brushed aluminium, black, and stainless steel finishes. Two handle kits are required for double drawer models.

FEATURES

- ① Eight wash programs including Auto, 60min and Glassware, while modifiers such as Sanitize, Dry+ and Quiet provide added wash flexibility. The Quiet wash modifier reduces the noise on some cycles while maintaining performance - perfect for late night washing.
- ② Tall top drawer fits full-size dinner plates up to 12 3/16", with flexible racking for large cookware.
- ③ Wi-Fi capability and a SmartHQ™ app to see cycle status and notifications.
- ④ Both drawers fit a true half load. Each drawer operates independently, so you can wash one load while stacking the other drawer, or wash simultaneously on separate cycles
- ⑤ For ease-of-use, these DishDrawer™ Dishwashers have a knock to pause function. A knock on the front panel will pause the dishwasher, which can be restarted by using the start button.

The models shown in this Planning Guide may not be available in all markets and are subject to change at any time. Product specifications may vary from those shown. This Planning Guide should not be used as installation guidance for any product. Further information is required to safely and correctly install the products featured here. Specific installation guidance will be available with the product on delivery and on our website fisherpaykel.com

DATA SHEETS

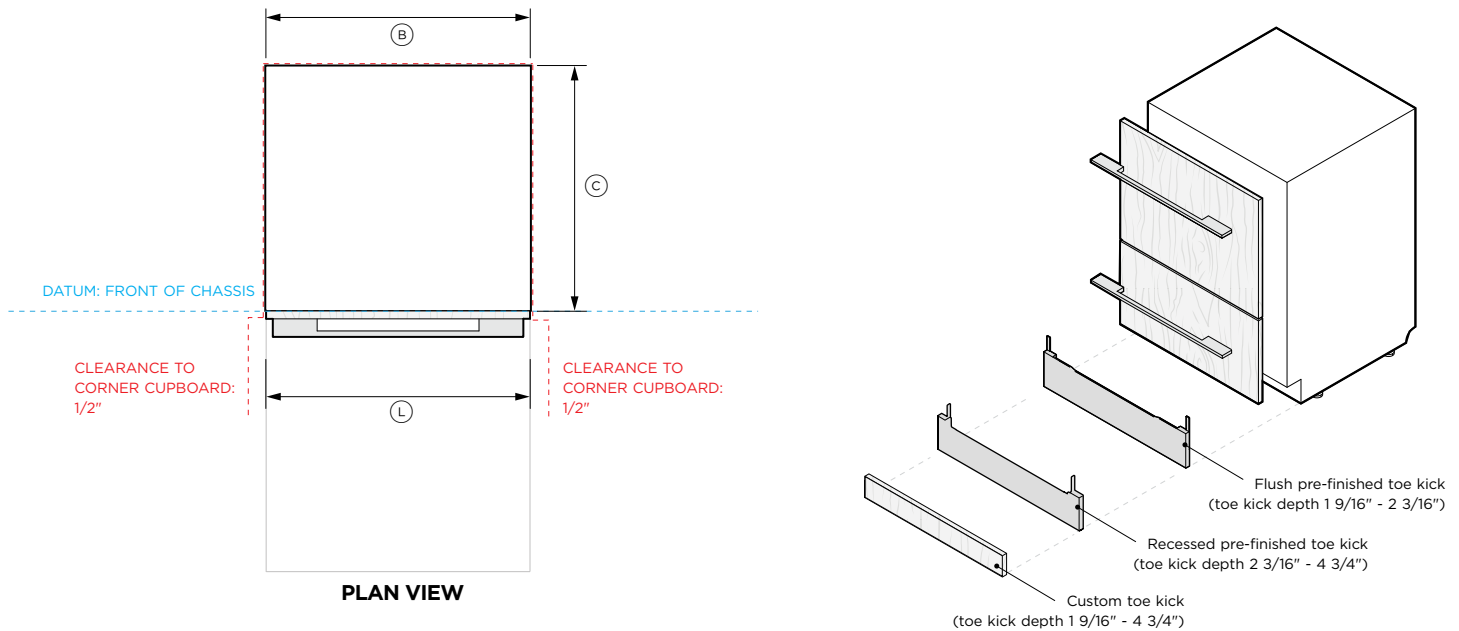

Model nos:
DD24DTX6I1 & DD24DTX6HI1
Shown with Custom Drawer Panels
Shown with Contemporary Square Fine Handle, AHD5-OBDD-60S

Product includes the following Toe Kick options:
Flush Pre-Finished Toe Kick
Recessed Pre-Finished Toe Kick (also used as a Custom toe kick bracket)

Product Dimensions	in	mm
Ⓐ Overall height*	34 - 36 3/8	867 - 925
Ⓑ Overall width of chassis	23 9/16	599
Ⓒ Overall depth of chassis	21 3/4	553
Ⓓ Height of chassis	33 5/8	854
Ⓔ Height of feet*	3/8 - 2 3/4	10 - 70
Ⓕ Height of upper drawer panel - minimum	17 3/8	442
Ⓖ Height of lower drawer panel - minimum	12 1/4	311
Ⓗ Height of toe kick	1 3/4 - 4 7/8	45 - 123
Ⓘ Toe kick depth	1 9/16 - 4 3/4	40 - 120
Ⓣ Maximum extension of drawer	20 3/4	527
Ⓚ Ventilation gap between drawers	5/16	8
Ⓛ Drawer panel width	23 1/2	596

*Depending on adjustment of leveling feet

Minimum Clearances	in	mm
Minimum inside height of cavity*	34 1/4	869
Minimum inside width of cavity	23 5/8	600
Minimum overall depth of cavity**	22 3/4	578
Minimum clearance to corner cupboard	1/2	13
Minimum clearance to adjacent cupboard door	1/16	2
Minimum clearance between drawer panels	5/16	8

*Depending on adjustment of leveling feet

**Assumes 3/4" drawer panels on adjacent cabinetry

NOTE: Custom drawer panel and toe kicks to be manufactured/fitted by cabinetmaker.

INDICATES PRODUCT DATUM -----
INDICATES CABINETRY CLEARANCES -----

IMPORTANT NOTE: Throughout this guide, dimensions may vary by ±2mm (1/16"). Please read the Installation Guide for detailed information on installing the product. For full installation instructions visit fisherpaykel.com

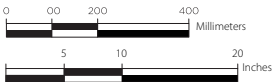

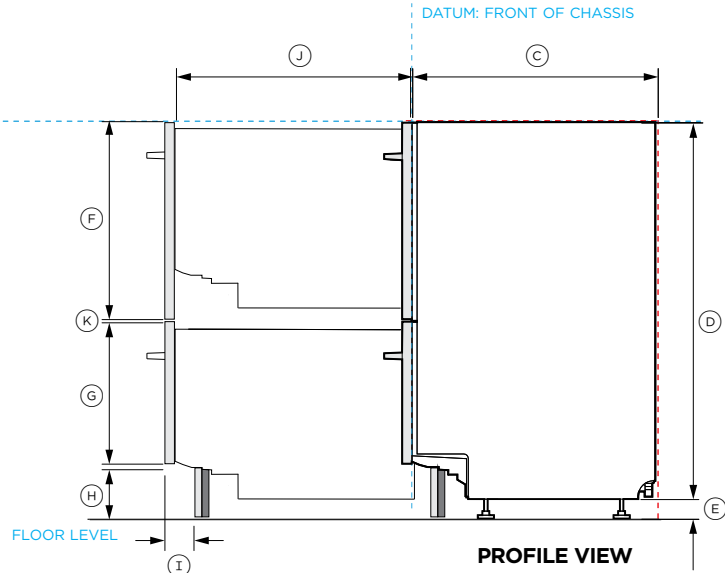
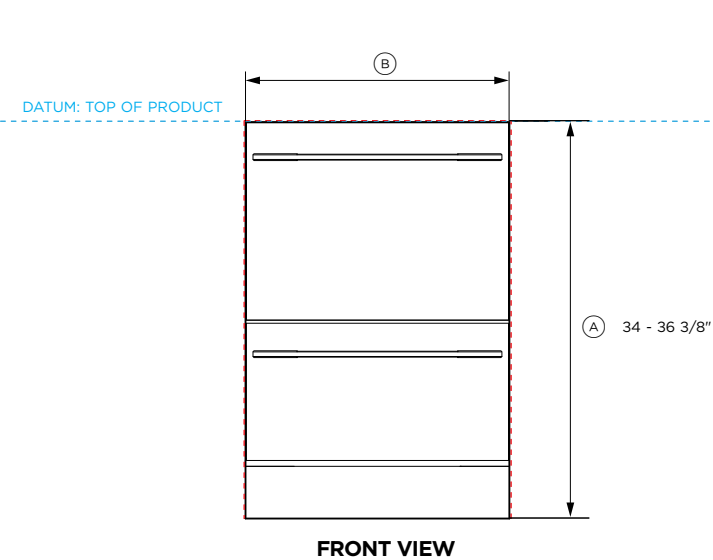
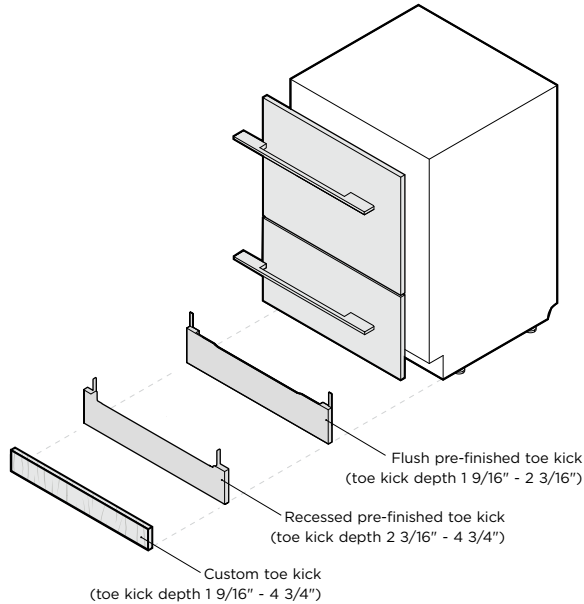
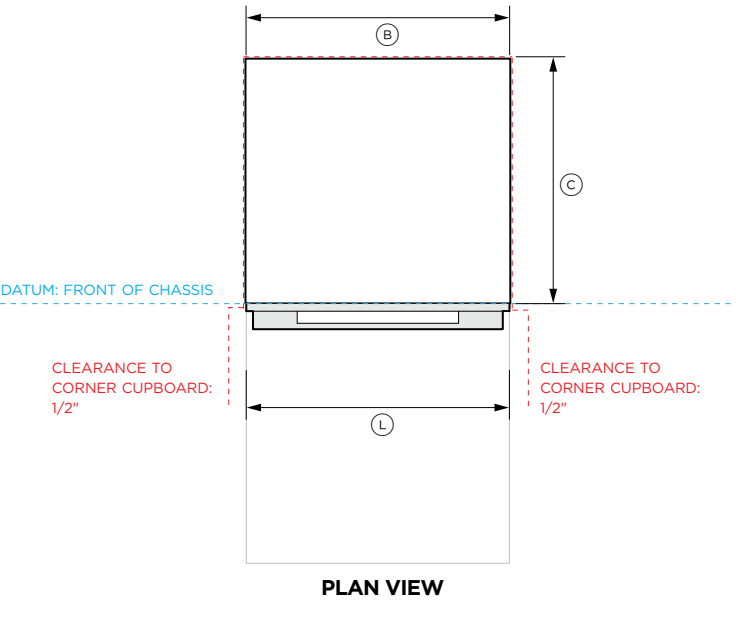

Model nos:
DD24DTX6I1 & DD24DTX6HI1
Shown with Stainless Steel Drawer Panels, ADDD24DTPX
Shown with Contemporary Square Fine Handle, AHD5-OBDD-60

Product includes the following Toe Kick options:
Flush Pre-Finished Toe Kick
Recessed Pre-Finished Toe Kick (also used as a Custom toe kick bracket)

Product Dimensions		in	mm
A	Overall height*	34 - 36 3/8	867 - 925
B	Overall width of chassis	23 9/16	599
C	Overall depth of chassis	21 3/4	553
D	Height of chassis	33 5/8	854
E	Height of feet*	3/8 - 2 3/4	10 - 70
F	Height of upper drawer panel - minimum	17 3/8	442
G	Height of lower drawer panel - minimum	12 1/4	311
H	Height of toe kick	1 3/4 - 4 7/8	45 - 123
I	Toe kick depth	1 9/16 - 4 3/4	40 - 120
J	Maximum extension of drawer	20 3/4	527
K	Ventilation gap between drawers	5/16	8
L	Drawer panel width	23 1/2	596

*Depending on adjustment of leveling feet

Minimum Clearances		in	mm
Minimum inside height of cavity*		34 1/4	869
Minimum inside width of cavity		23 5/8	600
Minimum overall depth of cavity (includes panels)		22 3/4	578
Minimum clearance to corner cupboard		1/2	13
Minimum clearance to adjacent cupboard door		1/16	2
Minimum clearance between drawer panels		5/16	8

*Depending on adjustment of leveling feet

INDICATES PRODUCT DATUM -----
INDICATES CABINETRY CLEARANCES -----

IMPORTANT NOTE: Throughout this guide, dimensions may vary by ±2mm (1/16"). Please read the Installation Guide for detailed information on installing the product. For full installation instructions visit fisherpaykel.com

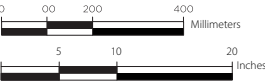

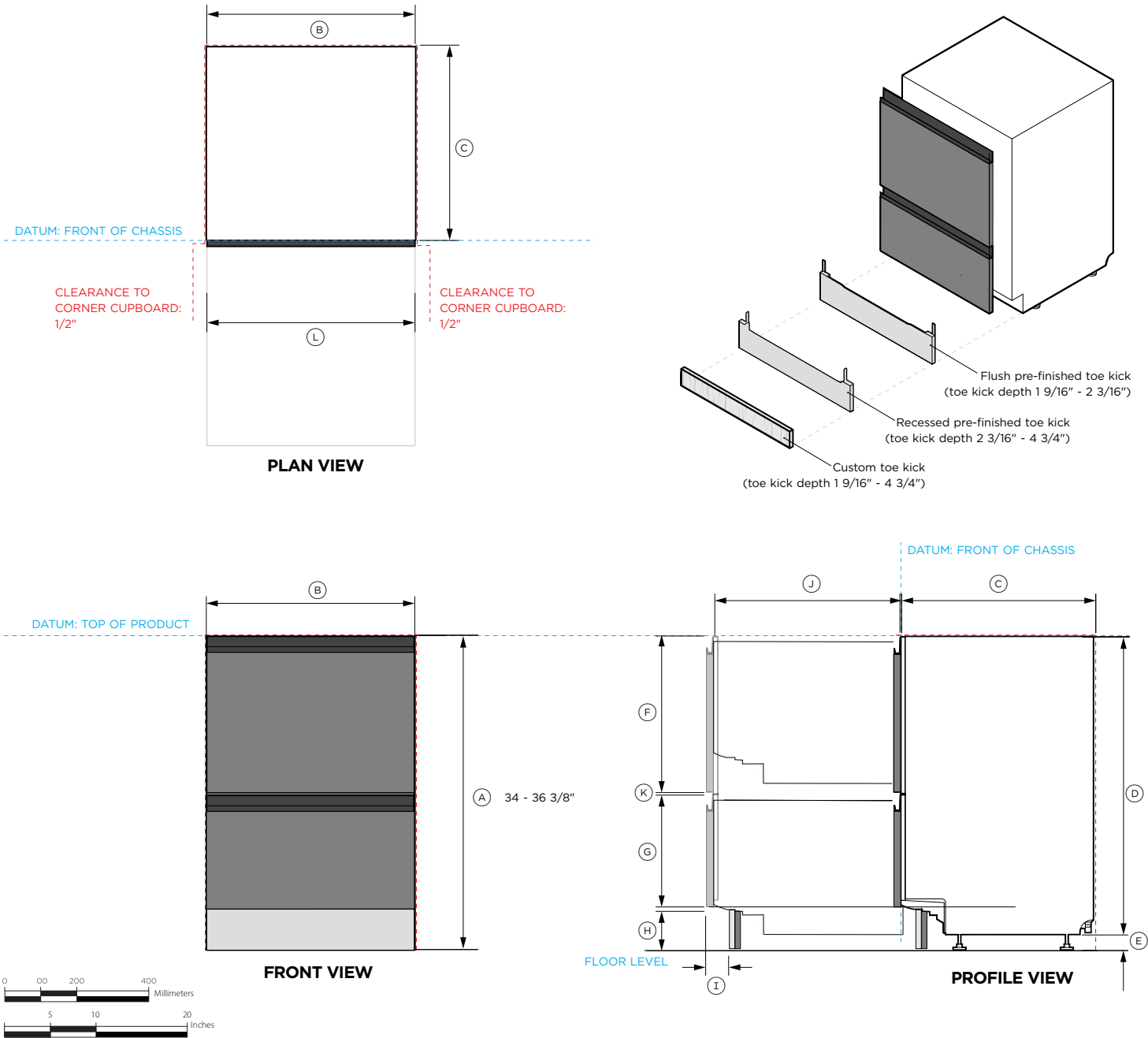

Model nos:

DD24DTX6I1 & DD24DTX6HI1

Shown with Matte Black Glass Recessed Handle Drawer Panels, ADDD24DTZB
Available Stainless Steel Recessed Handle Drawer Panels, ADDD24DTNX

Product includes the following Toe Kick options:

Flush Pre-Finished Toe Kick
Recessed Pre-Finished Toe Kick (also used as a Custom toe kick bracket)

Product Dimensions	in	mm
A Overall height*	34 - 36 3/8	867 - 925
B Overall width of chassis	23 9/16	599
C Overall depth of chassis	21 3/4	553
D Height of chassis	33 5/8	854
E Height of feet*	3/8 - 2 3/4	10 - 70
F Height of upper drawer panel - minimum	17 6/16	442
G Height of lower drawer panel - minimum	12 1/4	311
H Height of toe kick	1 3/4 - 4 7/8	45-123
I Toe kick depth	1 9/16 - 4 3/4	40-120
J Maximum extension of drawer	20 3/4	527
K Ventilation gap between drawers	5/16	8
L Drawer panel width	23 1/2	596

*Depending on adjustment of leveling feet

Minimum Clearances	in	mm
Minimum inside height of cavity*	34 1/4	869
Minimum inside width of cavity	23 5/8	600
Minimum overall depth of cavity (includes panels)	22 3/4	578
Minimum clearance to corner cupboard	1/2	13
Minimum clearance to adjacent cupboard door	1/16	2
Minimum clearance between drawer panels	5/16	8

*Depending on adjustment of leveling feet

INDICATES PRODUCT DATUM -----
INDICATES CABINETRY CLEARANCES -----

IMPORTANT NOTE: Throughout this guide, dimensions may vary by ±2mm (1/16"). Please read the Installation Guide for detailed information on installing the product. For full installation instructions visit fisherpaykel.com

ACCESSORIES

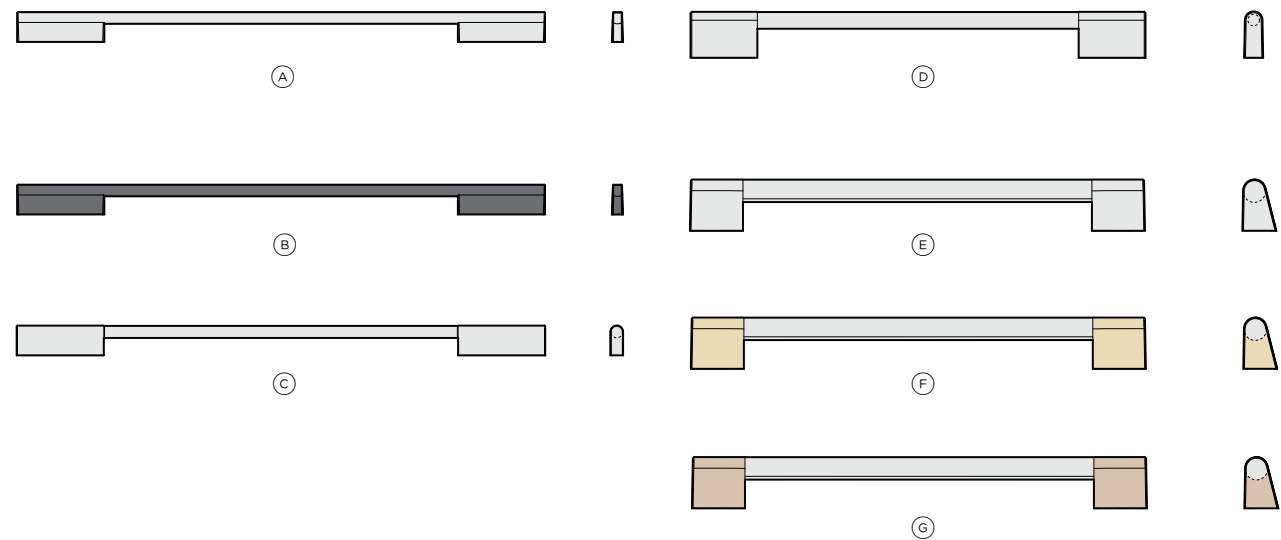

Handle kits		
Style	Model	Finish
Ⓐ Contemporary square fine	AHD5-OBDD-60SX	Brushed aluminium
Ⓑ Contemporary square fine black	AHD5-OBDD-60SB	Brushed black aluminium
Ⓒ Contemporary round	AHS-OBDD-60S	Stainless steel
Ⓓ Classic round	AHCL-DDDW-24X	Stainless steel
Ⓔ Professional round flush	AHP3-DWDD-SX	Stainless steel
Ⓕ Professional round flush	AHP3DDDW24BA	Stainless steel rail with brass off-stands
Ⓖ Professional round flush	AHP3DDDW24DC	Stainless steel rail with dark copper off-stands

Note: Double Dishwasher requires two handle kits.

The models shown in this Planning Guide may not be available in all markets and are subject to change at any time. Product specifications may vary from those shown. This Planning Guide should not be used as installation guidance for any product. Further information is required to safely and correctly install the products featured here. Specific installation guidance will be available on our website fisherpaykel.com

PRE-FINISHED PANELS

Stainless Steel - ADDD24DTPX
Recessed Handle Matte Black Glass - ADDD24DTZB
Recessed Handle Stainless Steel - ADDD24DTNX

Panel Dimensions	in	mm
Ⓐ Width of panels	23 1/2	596
Ⓑ Height of top drawer panel	17 3/8	442
Ⓒ Height of bottom drawer panel	12 1/4	311
Ⓓ Handle fixing point from top of panel	2 27/32	72
Ⓔ Handle fixing point from side of panel	3 7/32	81.5
Panel depth	23/32	18

Note: Custom toe kick panels can installed alongside pre-finished panels using the recessed pre-finished toe kick as a mounting jig.

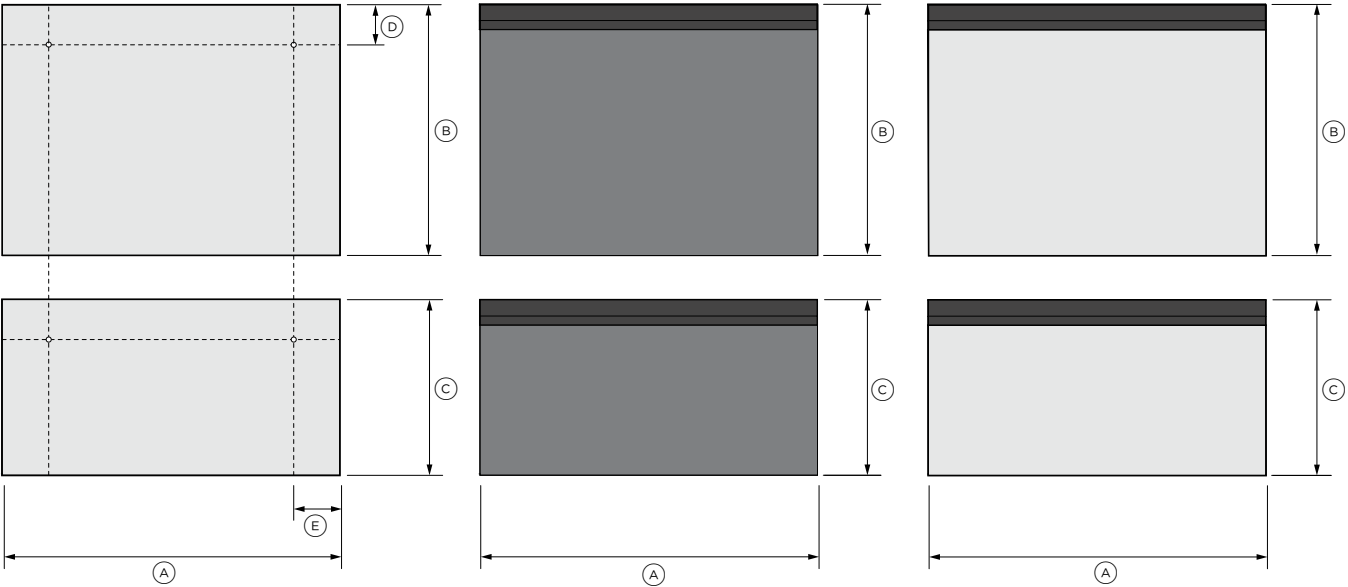

The models shown in this Planning Guide may not be available in all markets and are subject to change at any time. Product specifications may vary from those shown. This Planning Guide should not be used as installation guidance for any product. Further information is required to safely and correctly install the products featured here. Specific installation guidance will be available on our website fisherpaykel.com

PLANNING CONSIDERATIONS

CAVITY SPECIFICATIONS

The cavity height will vary according to your cabinetry design.

Cavity Dimensions	in	mm
Ⓐ Cavity height*	34 1/4-36 1/2	869-927
Ⓑ Minimum cavity width	23 5/8	600
Ⓒ Minimum cavity depth**	22 3/4	578

*Cavity height depends on adjustment of levelling feet.
**Ensure there are no obstructions in the cavity if minimum cavity depth, width or height are specified.

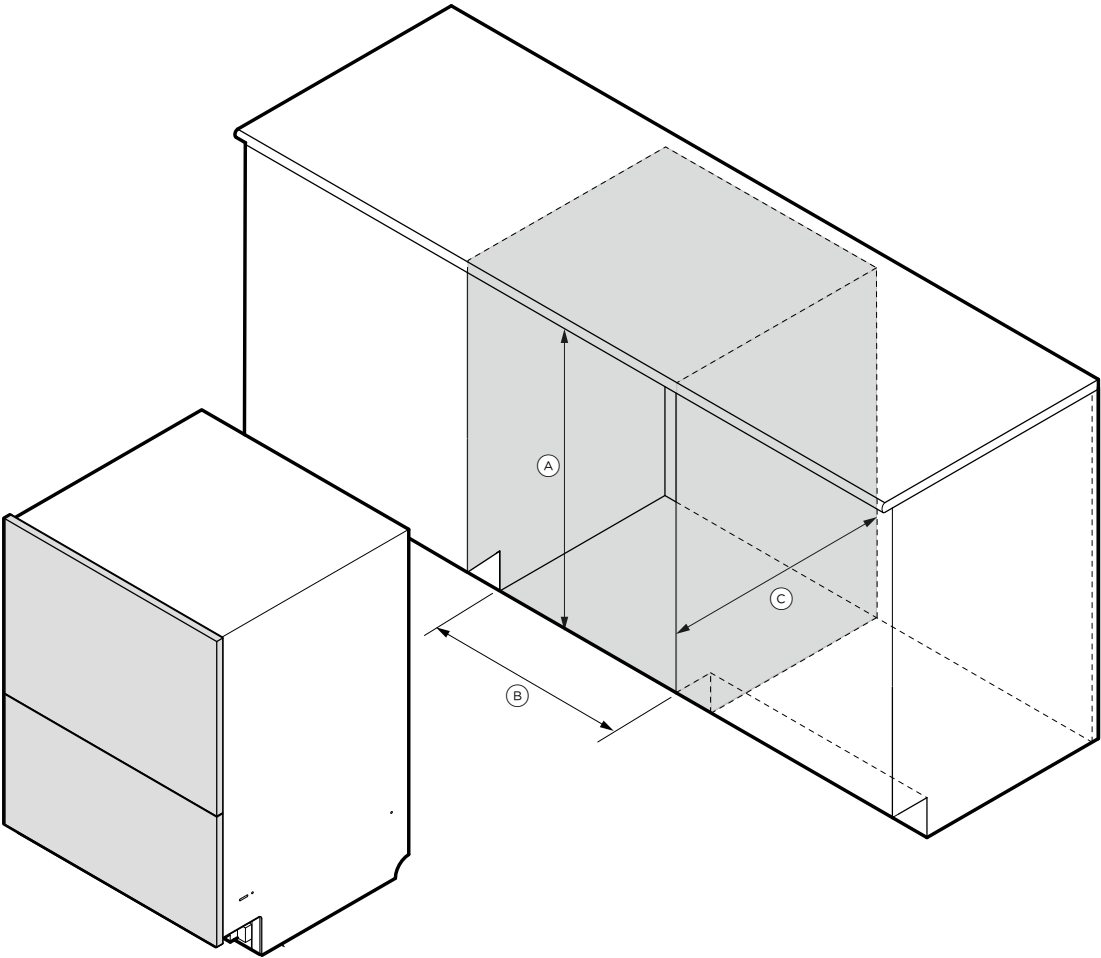

The models shown in this Planning Guide may not be available in all markets and are subject to change at any time. Product specifications may vary from those shown. This Planning Guide should not be used as installation guidance for any product. Further information is required to safely and correctly install the products featured here. Specific installation guidance will be available with the product on delivery and on our website fisherpaykel.com

CAVITY PACKING PLACEMENT

The dishwasher must be secured through chassis and into the cabinet sides. If the cavity is over width, packers must be installed to avoid bowing the chassis.

Side and top brackets may be installed and fixed to the edge of the cabinet.

Dimensions		in	mm
Ⓐ	Width between packers	23 5/8	600
Ⓑ	Center of fixing points from top of chassis	25 3/16	640

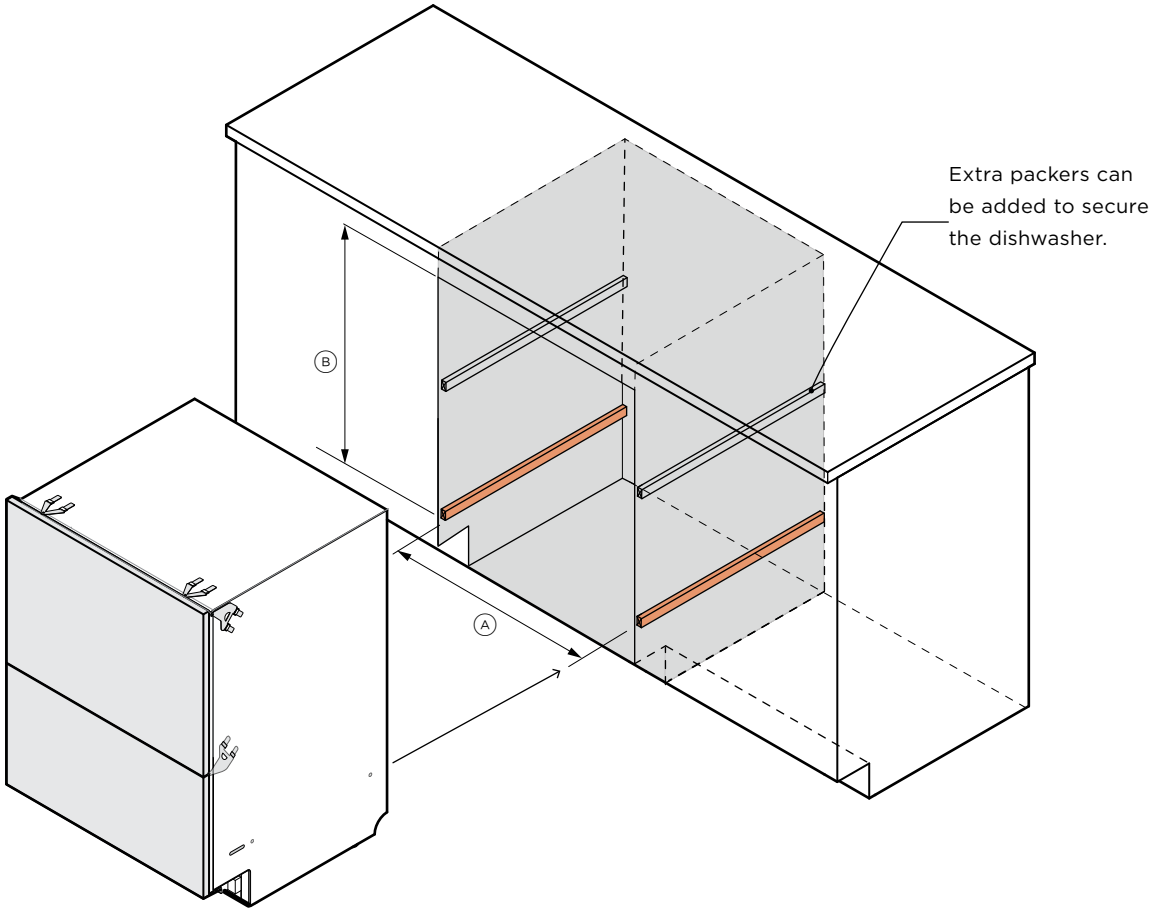

The models shown in this Planning Guide may not be available in all markets and are subject to change at any time. Product specifications may vary from those shown. This Planning Guide should not be used as installation guidance for any product. Further information is required to safely and correctly install the products featured here. Specific installation guidance will be available with the product on delivery and on our website fisherpaykel.com

FLUSH PRE-FINISHED TOE KICK

Suitable for a toe kick depth of 1 9/16 - 2 3/16". The pre-finished toe kick height can be cut to fit as needed.

Dimensions	in	mm
Ⓐ Toe kick height	1 3/4 - 4 7/8	45 - 123
Ⓑ Toe kick width	23 7/16	595
Ⓒ Minimum clearance between toe kick panel and floor	1/2	12
Ⓓ Depth of toe kick recess*	1 9/16 - 2 3/16	40 - 56

*Back of drawer to front of toe kick

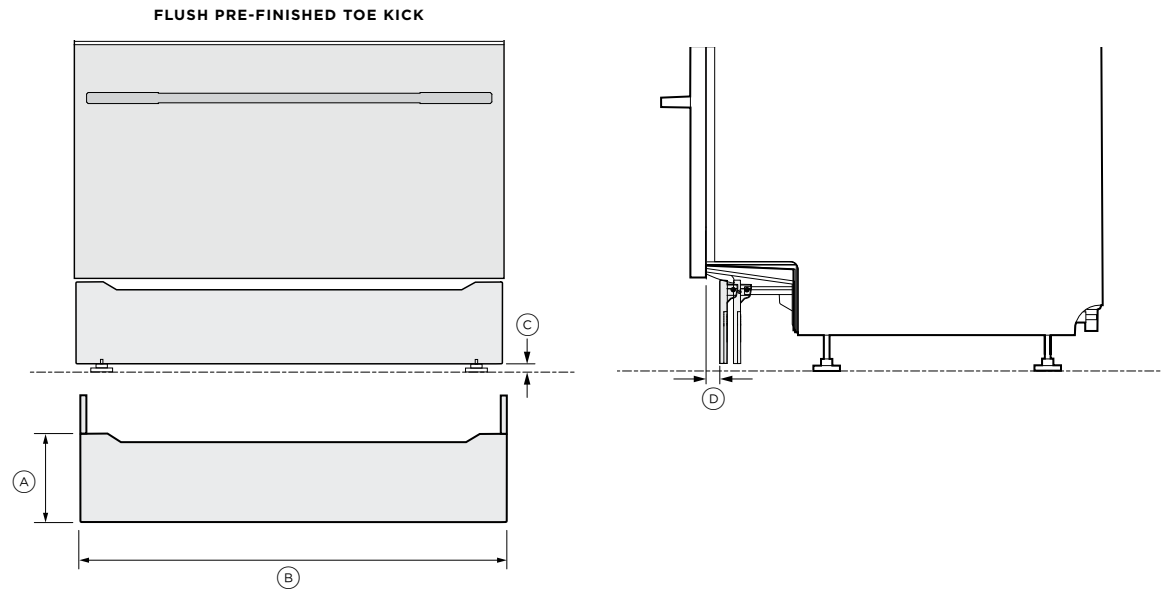

RECESSED PRE-FINISHED TOE KICK

Suitable for a toe kick depth of 2 3/16 - 4 3/4". The pre-finished toe kick height can be cut to fit as needed.

The recessed toe kick is also used as a mount for custom panels.

Dimensions	in	mm
Ⓔ Toe kick height	1 3/4 - 4 7/8	45 - 123
Ⓕ Toe kick width	23 7/16	595
Ⓖ Minimum clearance between toe kick panel and floor	1/2	12
Ⓗ Depth of toe kick recess*	2 3/16 - 4 3/4	56 - 120

*Back of drawer to front of toe kick

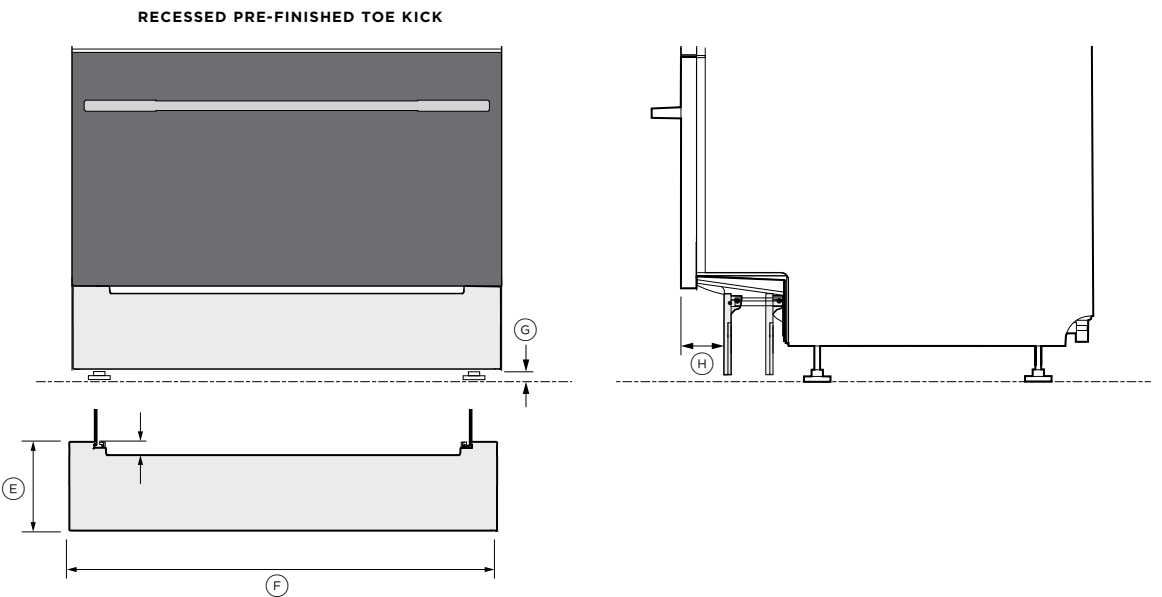

The models shown in this Planning Guide may not be available in all markets and are subject to change at any time. Product specifications may vary from those shown. This Planning Guide should not be used as installation guidance for any product. Further information is required to safely and correctly install the products featured here. Specific installation guidance will be available on our website fisherpaykel.com

PLANNING CONSIDERATIONS | CUSTOM TOE KICK SPECIFICATIONS

CUSTOM TOE KICK SPECIFICATIONS

The custom panel is fixed to the recessed pre-finished panel.
The finished toe kick height will vary according to the toe kick depth and the adjusted height of the dishwasher.

The bottom drawer panel can be extended over the toe kick up to a maximum of 2".

Toe kick Dimensions	in	mm
A Product height	34 - 36 3/8	867 - 925
B Top panel height minimum	17 3/8	442
C Bottom panel height minimum	12 1/4	311
D Bottom panel maximum extension	2	50
E Minimum toe kick clearance to floor	1/2	12
F Toe kick panel height*	1 3/4 - 4 7/8	45 - 123
G Toe kick depth	1 9/16 - 4 3/4	40 - 120

*For overall cabinet toe kick height include the 1/2" clearance gap from the bottom of the toe kick to the floor.

Custom drawer panel and toe kicks should be manufactured and fitted by a cabinetmaker.

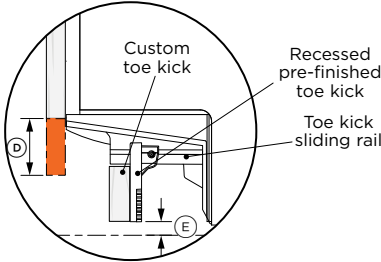
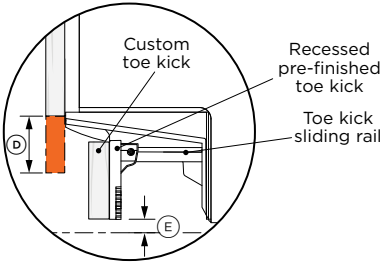
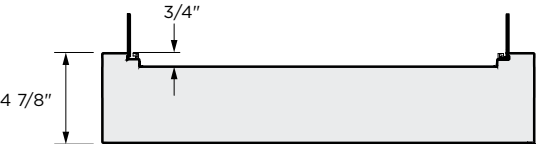
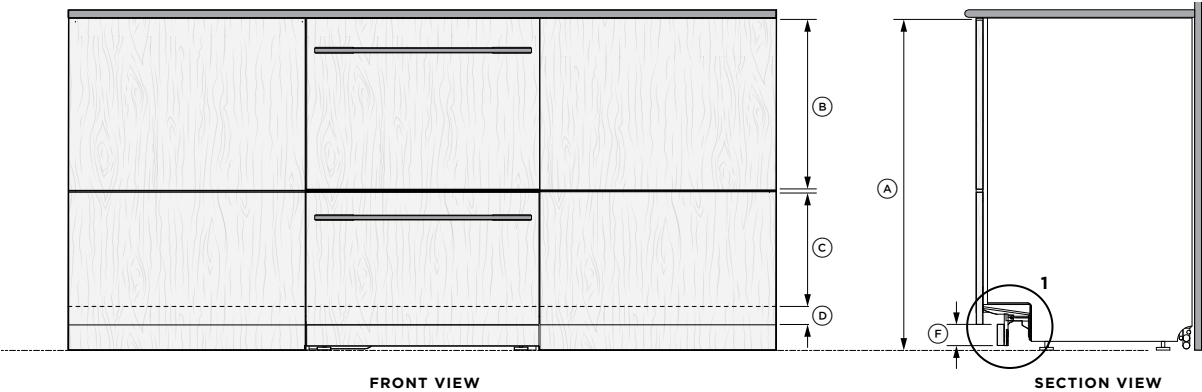

The models shown in this Planning Guide may not be available in all markets and are subject to change at any time. Product specifications may vary from those shown. This Planning Guide should not be used as installation guidance for any product. Further information is required to safely and correctly install the products featured here. Specific installation guidance will be available with the product on delivery and on our website fisherpaykel.com

PLANNING CONSIDERATIONS | CUSTOM PANEL SPECIFICATIONS

CUSTOM PANEL SPECIFICATIONS

Ensure that there are no obstructions under the counter top if the dishwasher is installed directly below.

Dimensions	mm	mm
A Height of cavity	34 1/4-36 1/2	869-927
B Minimum panel width	23 1/2	596
C Minimum top panel height	17 3/8	442
D Minimum clearance gap to adjacent cabinetry	1/16	2
E Minimum bottom panel height	12 1/4	311
F Maximum bottom panel extension	2	50
G Minimum ventilation gap	5/16	8

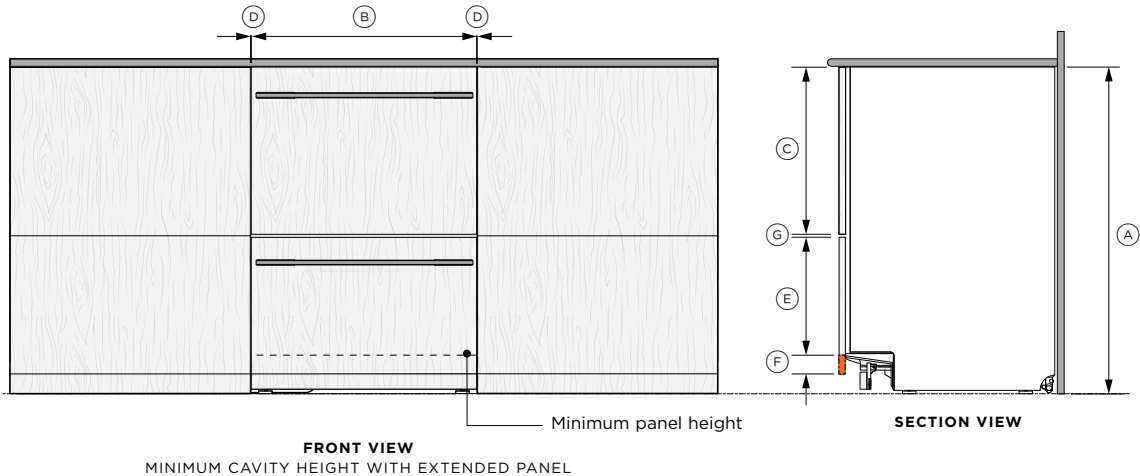

EXTENDING CUSTOM PANELS

Custom panels may need to extend to cover cabinet side walls or frames, or to create recessed handles.

Make sure the dishwasher drawer can always close securely against the seals on the chassis.

The dishwasher drawers must seal properly when closed to prevent humidity escape and condensation, which can damage the custom panel.

If the custom drawer panel contacts any cabinetry, the seal may be compromised, allowing humidity to escape and damage the drawer panels or cabinetry.

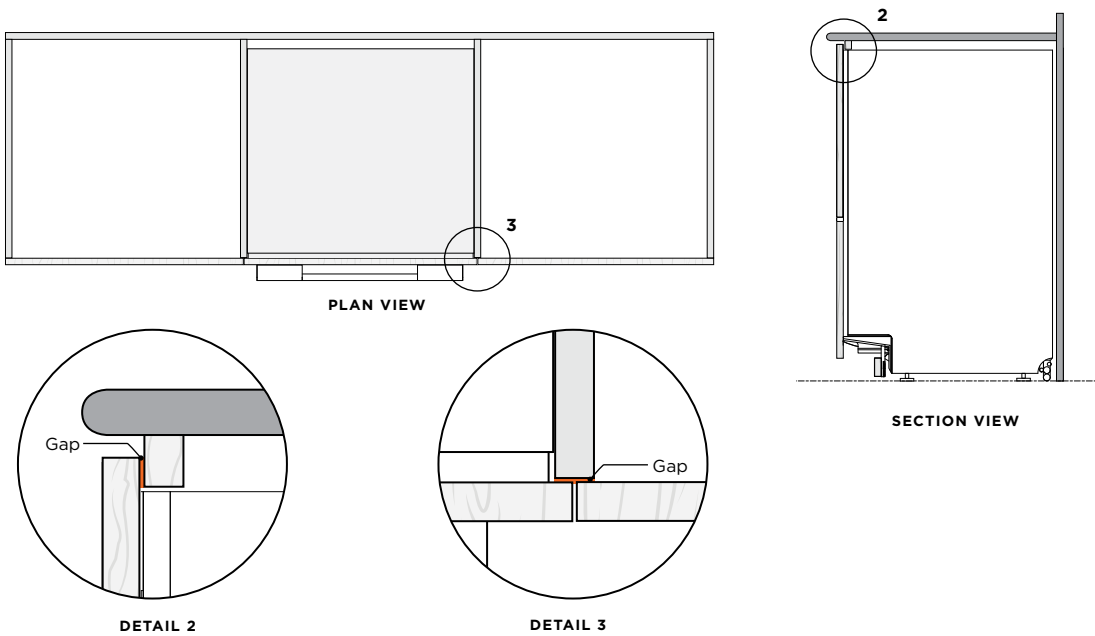

The models shown in this Planning Guide may not be available in all markets and are subject to change at any time. Product specifications may vary from those shown. This Planning Guide should not be used as installation guidance for any product. Further information is required to safely and correctly install the products featured here. Specific installation guidance will be available on our website fisherpaykel.com

CUSTOM DRAWER PANEL PREPARATION

CUSTOM PANEL SPECIFICATIONS

Panel width and height will vary according to your cabinet specifications.

Custom drawer panel and toe kicks should be manufactured and fitted by a cabinetmaker.

Panel Dimensions	in	mm
A Minimum panel width	23 1/2	596
B Top drawer panel minimum height	17 3/8	442
C Bottom drawer panel minimum height	12 1/4	311
D Maximum bottom drawer panel extension	2	50
Maximum panel weight per drawer panel including handle	20lb	9kg

TOP PANEL EXTENSION

The top panel can be extended upwards. This can affect the ease of using the internal control panel.

For additional support please contact the Fisher & Paykel design support team at designsupport@fisherpaykel.com

TOP PANEL - BACK VIEW

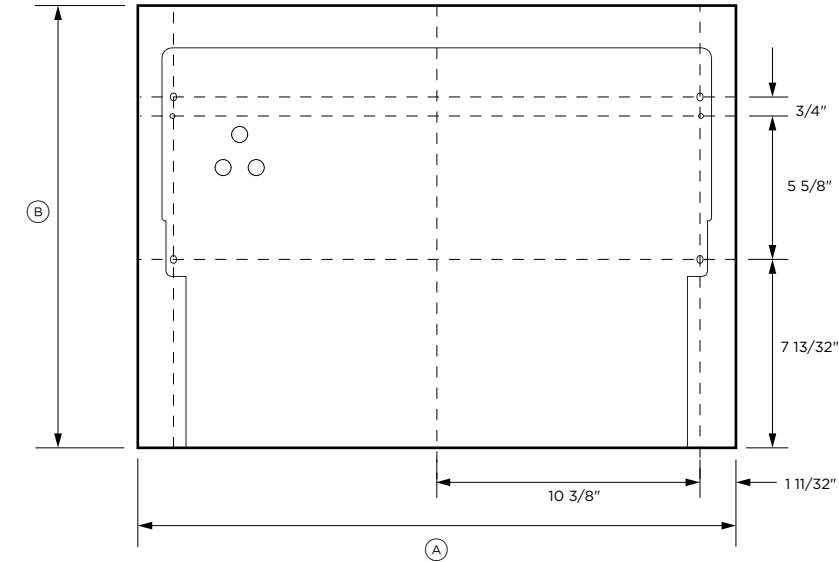

BOTTOM PANEL - BACK VIEW

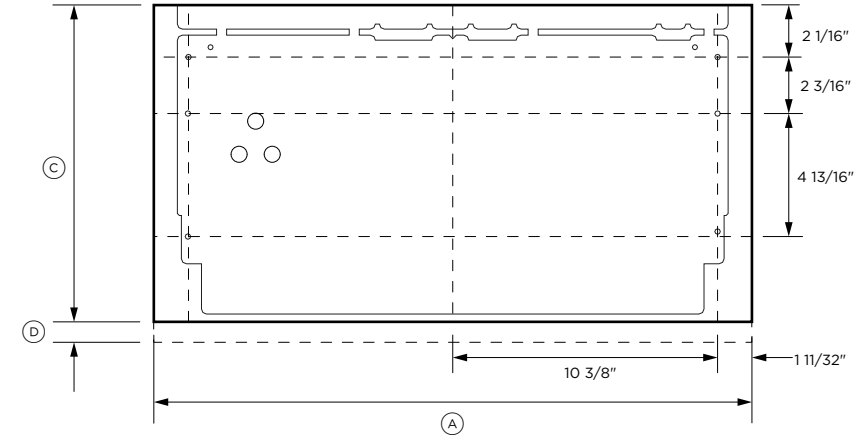

The models shown in this Planning Guide may not be available in all markets and are subject to change at any time. Product specifications may vary from those shown. This Planning Guide should not be used as installation guidance for any product. Further information is required to safely and correctly install the products featured here. Specific installation guidance will be available with the product on delivery and on our website fisherpaykel.com

SERVICES

SERVICE REQUIREMENTS

The power cable must be routed through a service hole separate from the water and drainage.

The drain hose support should be placed as close to the underside of the counter top as possible.

Drain hoses must be installed higher than standing water with an air gap between to avoid drainage issues. Hoses can be shortened to achieve the air gap.

Hoses must not extend into a standpipe more than 4 3/4". If the drain hoses supplied are not long enough, a Fisher & Paykel 11ft 8" (part number 525798). drain hose extension kit is available

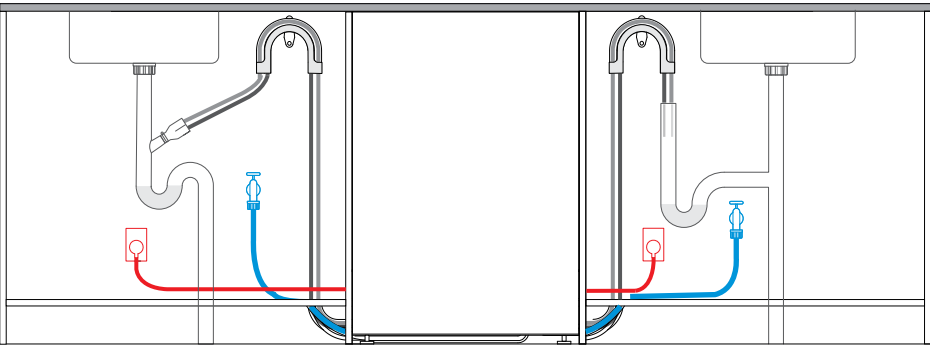

FRONT SECTION VIEW - SERVICES THROUGH TOE KICK

Water services can be routed left or right through the toe kick and into the adjacent cabinet. Drainage can be routed to a spigot or stand pipe. The power cable must be routed through a separate hole.

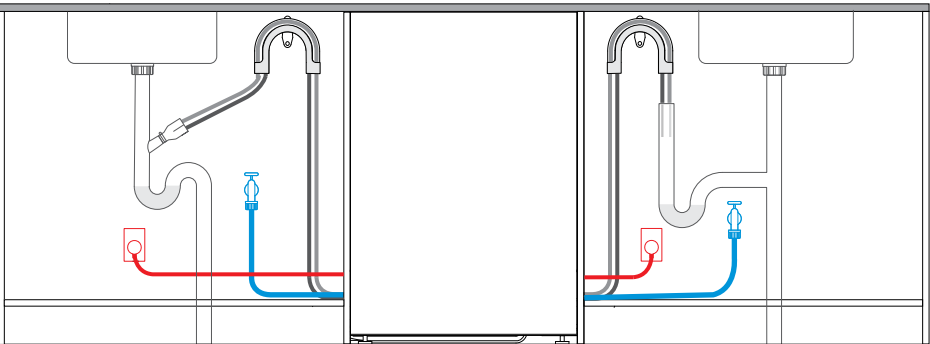

FRONT SECTION VIEW - SERVICES THROUGH CABINET SIDE

If routing directly through the cabinet side is necessary, ensure that the service hole is raised. There must be space behind the dishwasher for feeding hoses and cords.

The models shown in this Planning Guide may not be available in all markets and are subject to change at any time. Product specifications may vary from those shown. This Planning Guide should not be used as installation guidance for any product. Further information is required to safely and correctly install the products featured here. Specific installation guidance will be available on our website fisherpaykel.com

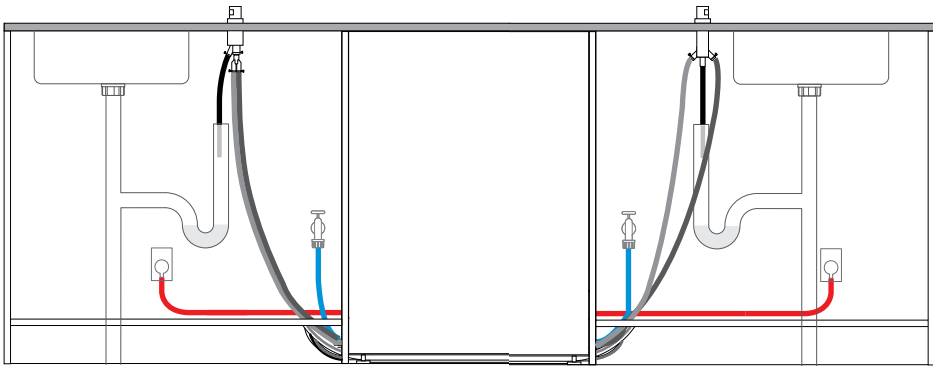

SINGLE AIR GAP INSTALLATION

Drainage can be routed to a single air gap fitting. See the installation guide for details

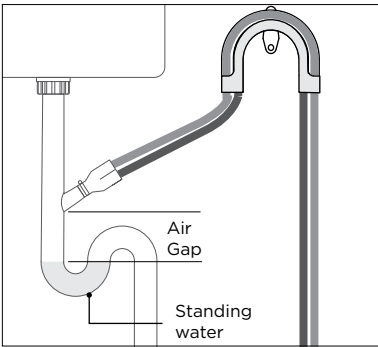

DETAIL VIEW - SPIGOT INSTALL

The spigot must be installed above the standing water with an air gap in between.

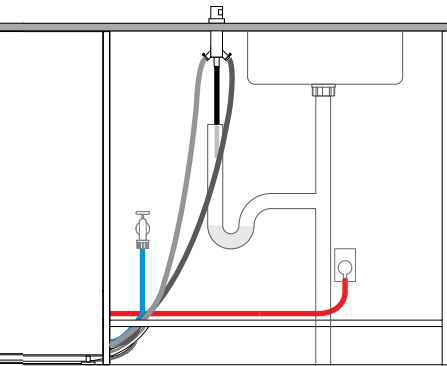

DUAL AIR GAP INSTALLATION

Drainage can be routed to a dual air gap fitting. See the installation guide for details

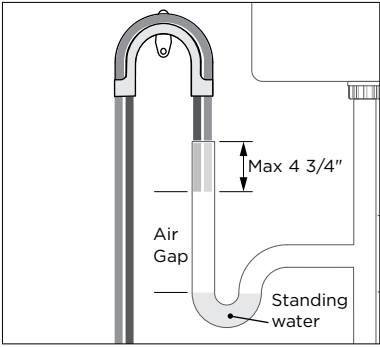

DETAIL VIEW - STAND PIPE INSTALL

The dishwasher drain must be installed no more than 4 3/4" into the stand pipe. An air gap between drain ends and standing water is required.

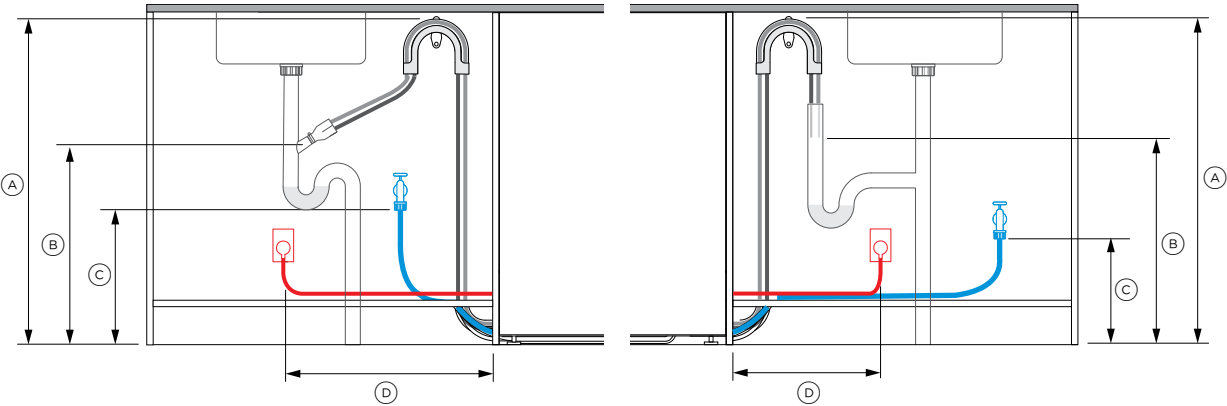

FRONT SECTION VIEW - SPIGOT INSTALL

FRONT SECTION VIEW - STAND PIPE INSTALL

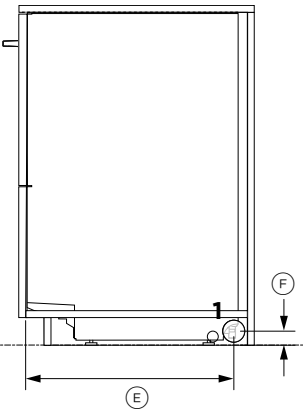

SIDE SECTION VIEW - SERVICE HOLES

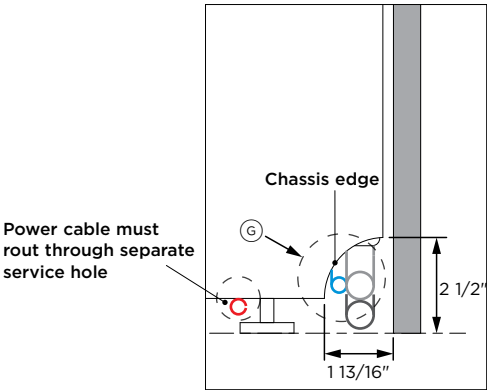

DETAIL 1 - SERVICE HOLES

Service dimensions		in	mm
A	Minimum distance from floor to top of hose support	29 9/16	750
B	Minimum distance from floor to end of drain hoses*	19 11/16	500
C	Minimum distance from floor to inlet hose connection	7 7/8	200
D	Maximum distance from cabinetry to the centre of electrical outlet	17 3/4	450

*Distances are the same for standpipe and waste tee installation.

Minimum service hole dimensions		in	mm
E	Minimum distance between front of product* and center of service hole	21 3/16	538
F	Maximum distance between floor and center of service hole	1 1/2	38
G	Minimum diameter of all service holes	2 1/4	57

*Not including dishwasher panels

The models shown in this Planning Guide may not be available in all markets and are subject to change at any time. Product specifications may vary from those shown. This Planning Guide should not be used as installation guidance for any product. Further information is required to safely and correctly install the products featured here. Specific installation guidance will be available on our website fisherpaykel.com

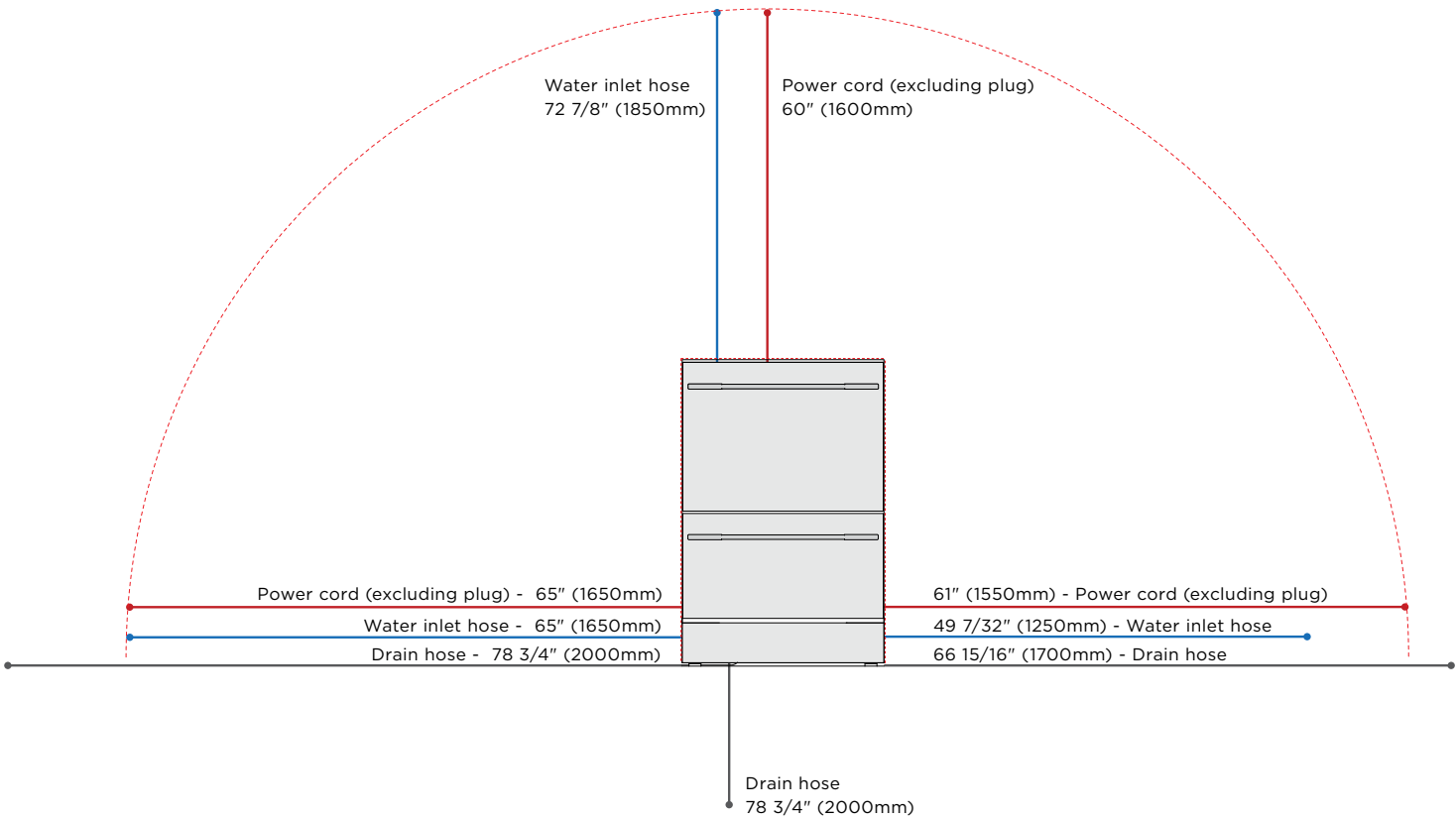

Electrical and plumbing specifications

DD24DTX6I1, DD24DTX6HI1

Electrical

Supply	120V, 60Hz,
Service	Min 8.7A

Plumbing

Supply	3/8" (9 mm) male compression fitting
Pressure	
Water softener model (DD24DTX6HI1)	Min. 0.1 MPa (14.5 psi)
	Max. 1 MPa (145 psi)
Non water softener model (DD24DTX6I1)	Min. 0.03 MPa (4.3 psi)
	Max. 1 MPa (145 psi)
Recommended temperature	Hot (max 140°F/60°C)

Hose and cord lengths

	in	mm
Drain hoses*	78 3/4	2000
Water inlet	72 7/8	1850
Power	60	1600

*The Fisher & Paykel 11ft 9" drain hose extension kit (part number 525798) is available for purchase from fisherpaykel.com

IMPORTANT NOTE: Throughout this guide, dimensions may vary by ±2mm (1/16"). Please read the Installation Guide for detailed information on installing the product. For full installation instructions visit fisherpaykel.com

DATA SHEETS: HANDLES

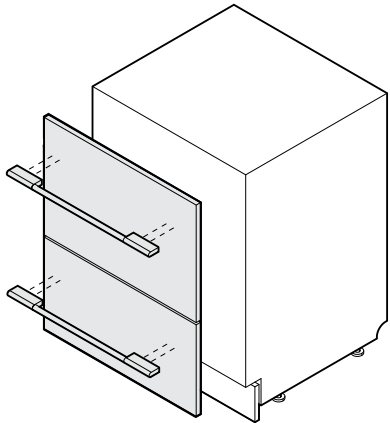
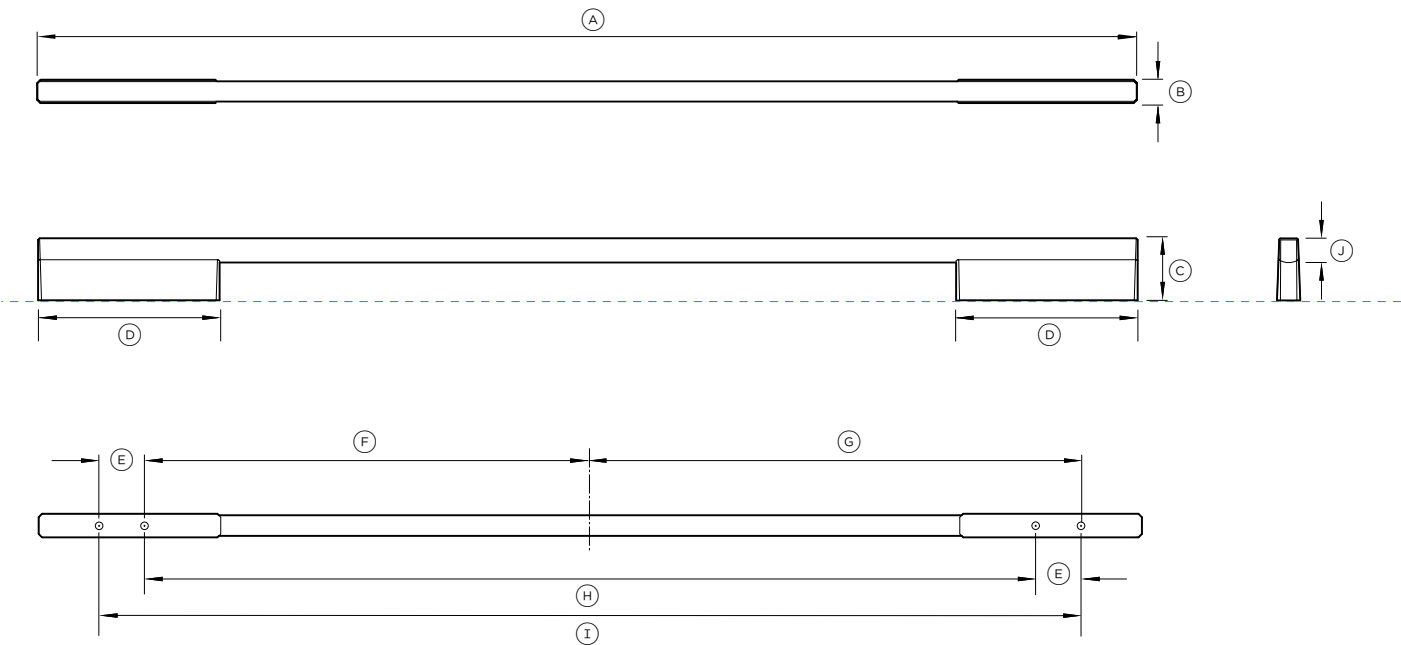

*M6 X 25mm Pan Head Socket Screw (2 per handle)

Model no:
Square Fine Handle AHD5-OBDD-60SX
Black Square Fine Handle AHD5-OBDD-60SB

For Models:
DD24DTX6I1, DD24DTX6HI1, DD24DTI9 N, DD24DHTI9 N

Compatible with drawer panel kits:
Square Fine Handle for drawer Panel Kit ADDD24DTPX
Black Square Fine Handle for drawer Panel Kit ADDD24DTPX
Custom drawer panels

Handle Dimensions	in	mm
A Overall length of handle	22 1/4	565
B Overall depth of handle	19/32	15
C Overall height of handle	1 5/8	41
D Length of off-stand	13 15/16	100
E Distance between attachment holes	1 1/4	32
F Distance from centreline to inner attachment holes	8 1/2	216
G Distance from centreline to outer attachment holes	9 25/32	248.5
H Distance between inner attachment holes	17	432
I Distance between outer attachment holes	19 9/16	497
J Thickness of handle rail	5/8	16

*Suits standard 3/4" drawer panel. Thicker drawer panels may require counter boring or longer screws.

Note: Single Dishwasher requires one handle kit. Double Dishwasher requires two handle kits.

IMPORTANT NOTE: Throughout this guide, dimensions may vary by ±2mm (1/16"). Please read the Installation Guide for detailed information on installing the product. For full installation instructions visit fisherpaykel.com

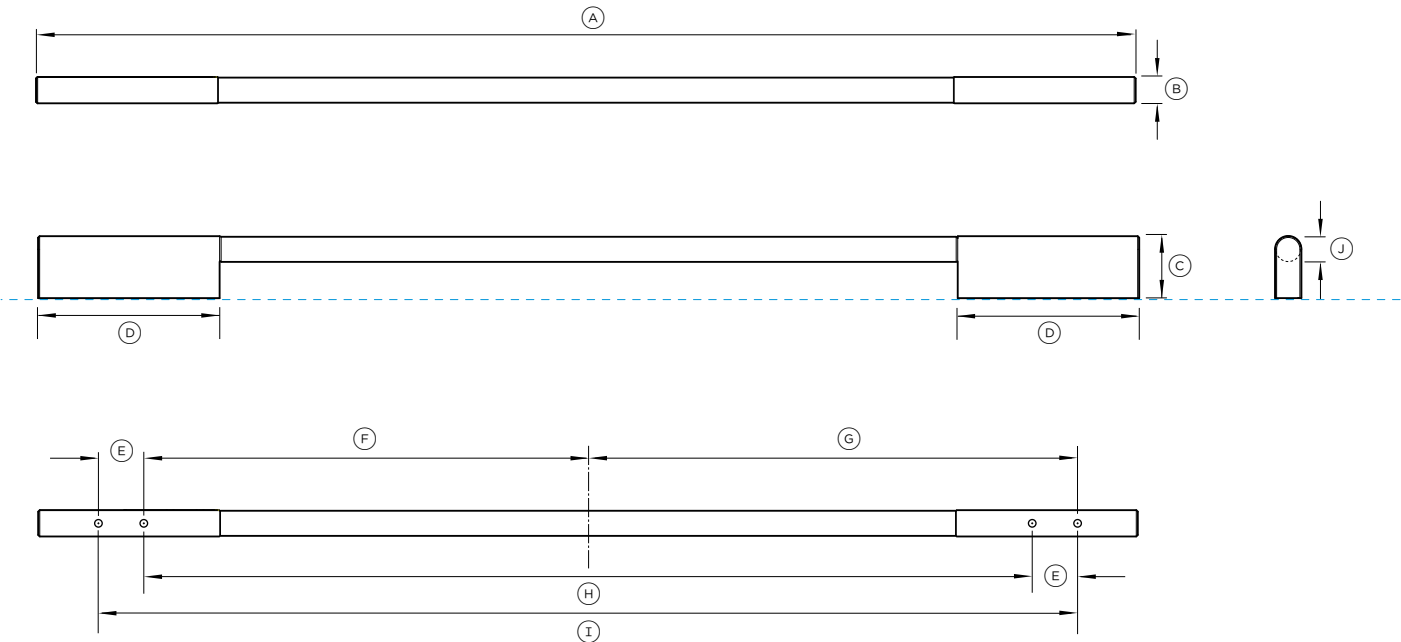

Model no:
Round Handle AHS-OBDD-60S

For Models:
DD24DTX6I1, DD24DTX6HI1, DD24DTI9 N, DD24DHTI9 N

Compatible with drawer panel kits:
Round Handle for Drawer Panel Kit ADDD24DTPX
Custom drawer panels

Handle Dimensions	in	mm
A Overall length of handle	22 1/4	565
B Overall depth of handle	11/16	17
C Overall height of handle	1 5/8	41
D Length of off-stand	13 15/16	100
E Distance between attachment holes	1 1/4	32
F Distance from centreline to inner attachment holes	8 1/2	216
G Distance from centreline to outer attachment holes	9 25/32	248.5
H Distance between inner attachment holes	17	432
I Distance between outer attachment holes	19 9/16	497
J Thickness of handle rail	5/8	16

*Suits standard 3/4" drawer panel. Thicker drawer panels may require counter boring or longer screws.

Note: Single Dishwasher requires one handle kit. Double Dishwasher requires two handle kits.

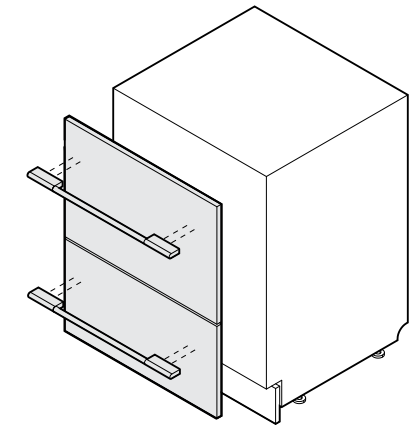

*M6 X 25mm Pan Head Socket Screw (2 per handle)

IMPORTANT NOTE: Throughout this guide, dimensions may vary by ±2mm (1/16"). Please read the Installation Guide for detailed information on installing the product. For full installation instructions visit fisherpaykel.com

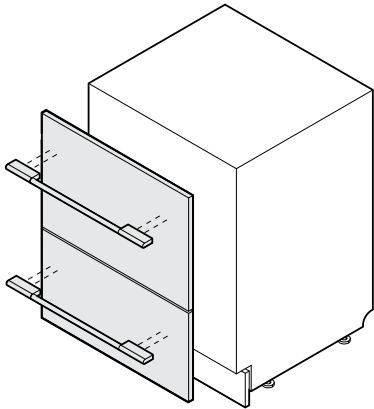
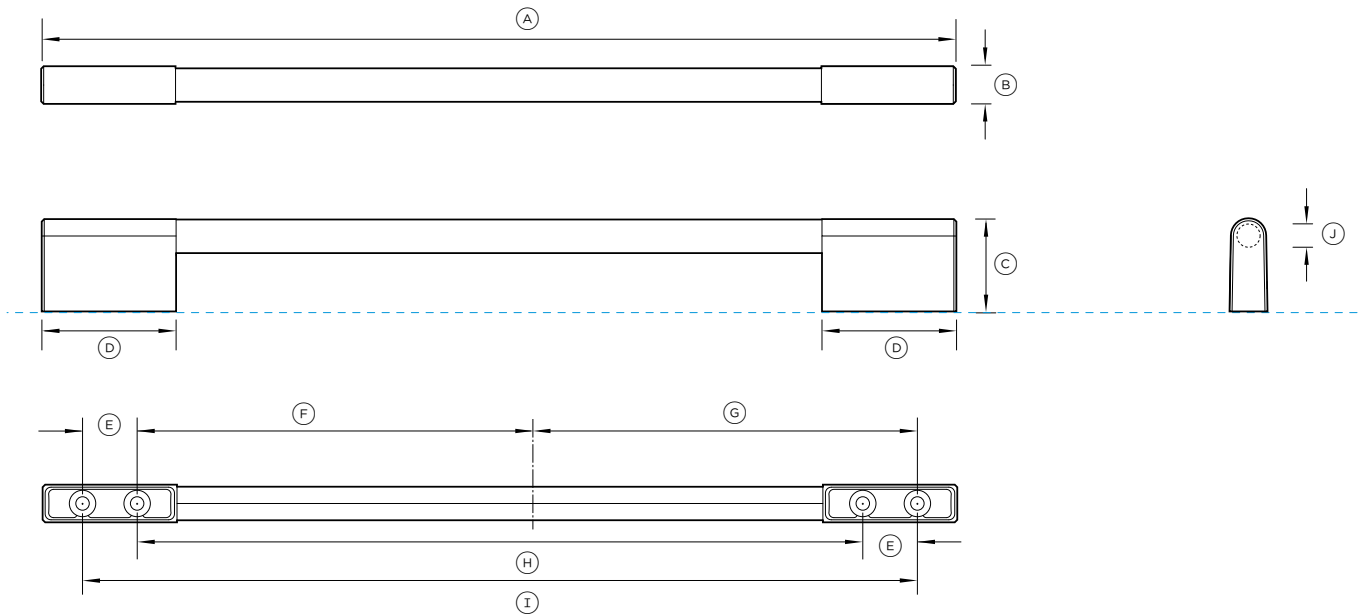

*M6 X 25mm Pan Head Socket Screw (2 per handle)

Model no:
Classic Round Handle AHCL-DDDW-24X

For Models:
DD24DTX6I1, DD24DTX6HI1, DD24DTI9 N, DD24DHTI9 N

Compatible with drawer panel kits:
Classic Round Handle for Drawer Panel Kit ADDD24DTPX
Custom drawer panels

Handle Dimensions	in	mm
A Overall length of handle	21 13/32	544
B Overall depth of handle	7/8	22
C Overall height of handle	2 5/32	55
D Length of off-stand	3 5/32	80
E Distance between attachment holes	1 1/4	32
F Distance from centreline to inner attachment holes	8 1/2	216
G Distance from centreline to outer attachment holes	9 25/32	248.5
H Distance between inner attachment holes	17	432
I Distance between outer attachment holes	19 9/16	497
J Diameter of handle rail	25/32	20

*Suits standard 19mm drawer panel. Thicker drawer panels may require counter boring or longer screws.

Note: Single Dishwasher requires one handle kit. Double Dishwasher requires two handle kits.

IMPORTANT NOTE: Throughout this guide, dimensions may vary by ±2mm (1/16"). Please read the Installation Guide for detailed information on installing the product. For full installation instructions visit fisherpaykel.com

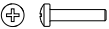
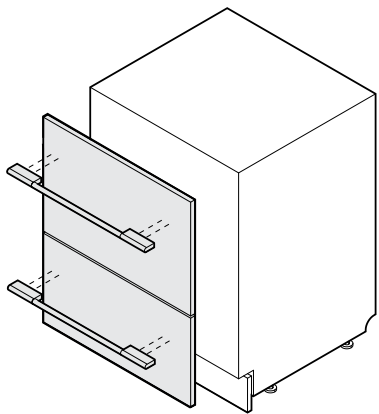
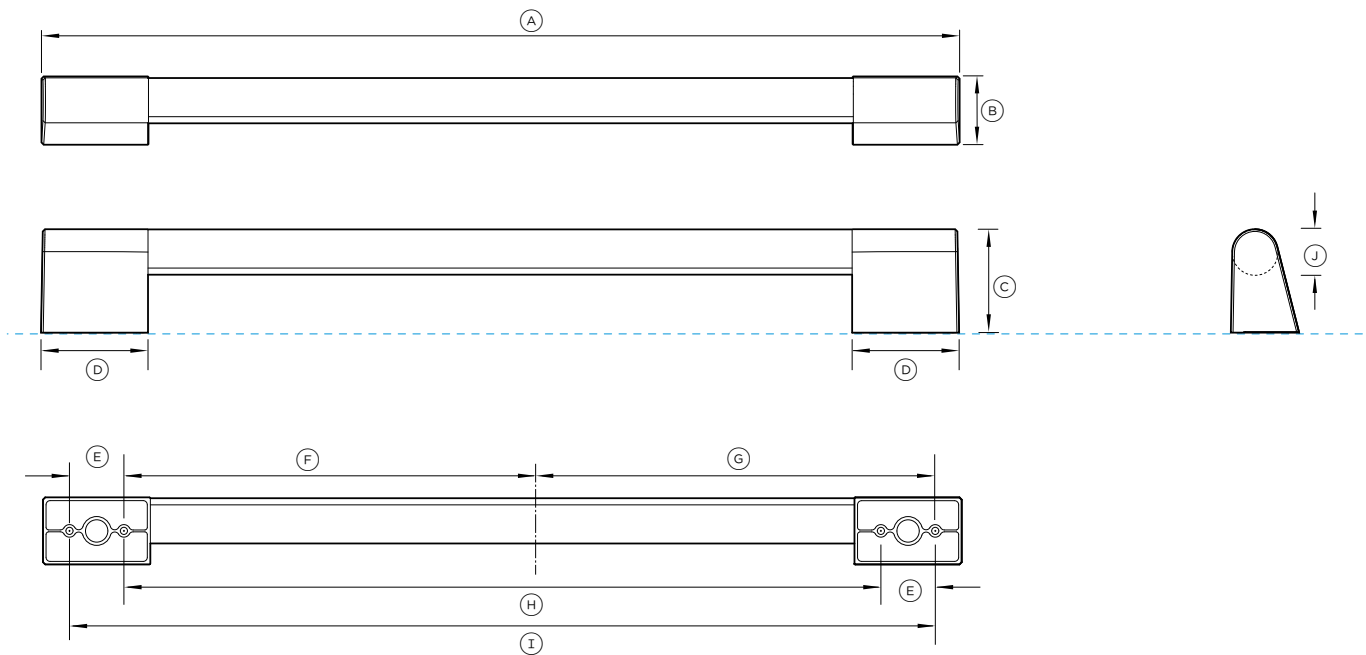

*M6 X 25mm Pan Head Socket Screw (2 per handle)

Model no:
Stainless steel AHP3-DWDD-SX
Stainless steel rail with brass off-stands AHP3DDDW24BA
Stainless steel rail with dark copper off-stands AHP3DDDW24DC

For Models:
DD24DTX6I1, DD24DTX6HI1, DD24DTI9 N, DD24DHTI9 N

Compatible with drawer panel kits:
Professional Flush Handle for drawer Panel Kit ADDD24DTPX
Custom Drawer Panels

Handle Dimensions	in	mm
A Overall length of handle	20 9/32	515
B Overall depth of handle	1 1/2	38
C Overall height of handle	2 9/32	58
D Length of off-stand	2 3/8	60
E Distance between attachment holes	1 1/4	32
F Distance from centreline to inner attachment holes	8 1/2	216
G Distance from centreline to outer attachment holes	9 25/32	248.5
H Distance between inner attachment holes	17	432
I Distance between outer attachment holes	19 9/16	497
J Diameter of handle rail	5/8	25

*Suits standard 19mm drawer panel. Thicker drawer panels may require counter boring or longer screws.

Note: Single Dishwasher requires one handle kit. Double Dishwasher requires two handle kits.

IMPORTANT NOTE: Throughout this guide, dimensions may vary by ±2mm (1/16"). Please read the Installation Guide for detailed information on installing the product. For full installation instructions visit fisherpaykel.com

