

**24" 11.4 cu.ft. Counter-Depth Bottom Freezer Refrigerator,
ENERGY STAR®****BRFB1045WH****Key Features & Benefits****Counter-Depth**

These Counter-Depth Refrigerators are designed to blend seamlessly with your countertop, featuring hidden hinges and discreet, tucked-away feet for a truly built-in look and feel.

Duo Cycle Frost-Free Cooling

Duo Cycle Frost-Free Cooling maintains consistent air temperature and humidity in both the freezer and fresh food compartments, ensuring optimal food preservation and maximum energy efficiency.

Field Reversible Door

Flexibility in kitchen design is key. Reversible Doors give you the freedom to choose the direction in which your refrigerator opens, making it easier to integrate seamlessly into any layout.

Freezer Guard

With Freezer Guard technology, your freezer operates seamlessly in temperatures as low as -15°C (5°F), ensuring reliable performance in any environment.

GENERAL PROPERTIES

Type	Free Standing
Style	Counter-Depth
Exterior Finish	White
Reversible Door Hinge	Yes
Door Configuration - Freezer	Swing Door
Cooling System	Duo Cycle Frost Free Cooling
Water Filter	Electronic Controls
Control Type	Digital LED Display
Display Type	Side Wall
Display Location	Variable Speed VCC
Compressor	No
Automatic Ice Maker	No
Internal Water Dispenser	N/A
Freezer Guard – Garage Ready	Yes

FRESH FOOD SECTION FEATURES

Defrost Process	Frost Free
Lighting	LED - Side Walls
Modes	Temp. Control, Vacation, Econo
# of Shelves	3 - Full Depth
# of Adjustable Shelves	2 - Adjustable
Shelf Material	Tempered Glass Shelves
# of Door Bins	3
# of Gallon Sized Door Bins	None
Dairy Compartment	No
Full Width Drawer	No
Blue Light Technology	No
Humidity Controlled Crispers	1 Full Width (Humidity Controlled)

FREEZER SECTION FEATURES

Defrost Process	Frost Free
# of Drawers / Baskets / Bins	3 Removable Drawers
Lighting	No
Ice Cube Tray	Yes

CAPACITY

Total Capacity	11.42 cu.ft.
Fresh Food Capacity	8.23 cu.ft.
Freezer Capacity	3.19 cu.ft.

TECHNICAL DETAILS

Rated Current	1 A
Minimum Circuit Breaker Size	15 Amps
Volts	120 V
Frequency	60 Hz
Power Cord Length	6 ft.
Plug Type	NEMA 3-Prong
Sound Level	39 dBA

DIMENSIONS & WEIGHT

Appliance Dimensions (H x W x D)	67 1/8" x 23 5/8" x 27 15/16"
Minimum Clearance Needed - Top	2"
Minimum Clearance Needed - Sides	1 9/16"
Minimum Clearance Needed - Back	2"
Product Weight	154 lbs.

EFFICIENCY

ENERGY STAR® Certified	Yes - Most Efficient
Energy Consumption	340 kwh/year

**24" 11.4 cu.ft. Counter-Depth Bottom Freezer Refrigerator,
ENERGY STAR®****BRFB1045WH**

Dimensions and Installation

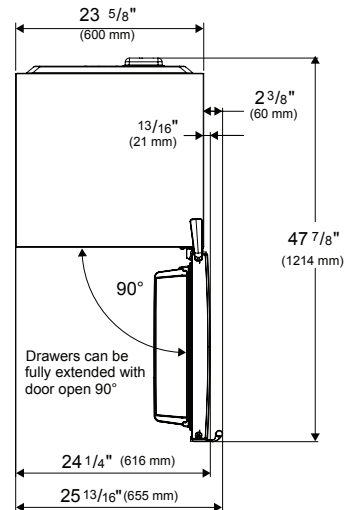
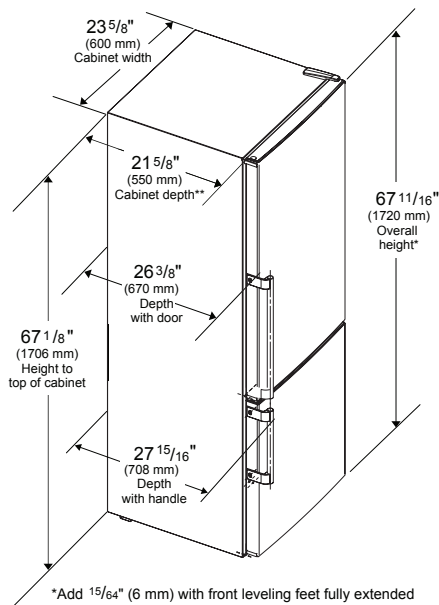

Electrical Location

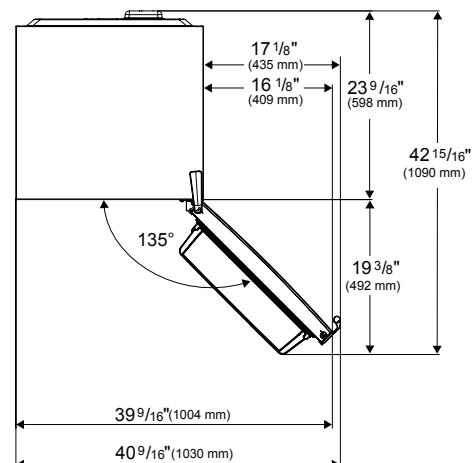
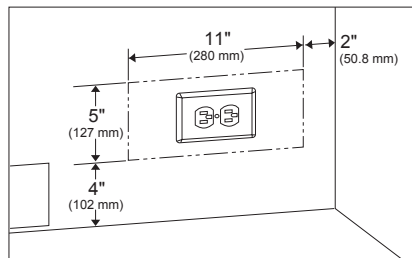

1 YEAR	2 YEARS	5 YEARS
FULL WARRANTY	PARTS WARRANTY	SEALED SYSTEM

NOTE TO THE INSTALLER: All height, width and depth dimensions are shown in inches (as well as metric). Beko Canada Inc. reserves the absolute and unrestricted right to change product materials and specifications, at any time, without notice. Please visit our website www.blombergappliances.ca or call 855-643-2356 to verify the latest specifications with final dimensional data and other details prior to installation and making a cutout. Applicable product limited warranty information may be found in accompanying product materials or you may contact your account manager for further details. Proper installation is the responsibility of the installer. Product failure due to improper installation is not covered under the Limited Warranty.

Canada: 855-643-2356 | www.blombergappliances.ca
USA: 888-352-2356 | www.blombergappliances.com

**24" 11.4 cu.ft. Counter-Depth Bottom Freezer Refrigerator,
ENERGY STAR®****BRFB1045WH**

Dimensions and Installation

