

Installation

Location and Function of Controls

This following is the general figure of the design of the drive.
The drive's appearance and specifications may change without prior notice.

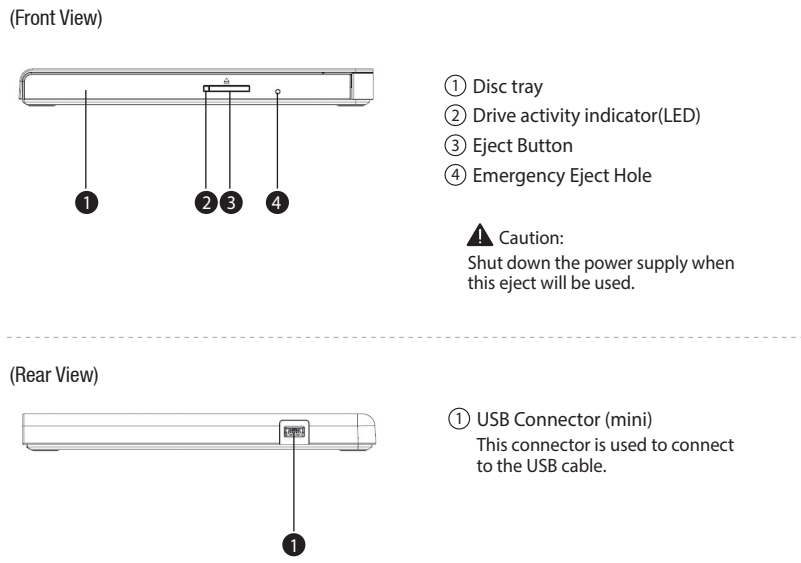

Hardware Installation

- Notes:
- Please pay attention to handling Electrostatic Sensitive Devices, you may use anti-static products such as wrist straps, heel straps, mats to protect your body from electrostatic.
 - Make sure you have a personal computer with any open USB ports before connecting the drive to your computer.

Connecting to computer or A/V Device.

- Connect the drive to the computer as shown in figure.
- ① Connect the USB cable (mini plug) to the drive.
 - ② Connect the other end of the USB cable to your computer.
- ※ The drive may get its power from the PC USB power. All systems may not meet USB power requirements and full performance may not be achieved. In this case, connect to the USB Y type cable (not supplied.).

When the computer is ready, confirm that the drive is detected. And then, insert the supplied software CD into the drive and install the software.

Features

- Universal Serial Bus (USB) 2.0 interface for high-speed data transfer.
- Buffer Under Run error protection technology.
- Emergency eject support.
- Combination of CD-R/RW, DVD-R/RW, DVD+R/RW, DVD-R DL, DVD+R DL, M-Disc (DVD+R SL) and DVD-RAM drive functions into one drive.
- Supports region playback control Phase II.
- PC USB powered, no AC adapter needed.
- Supports TV Connectivity.

System Environment

Computer

This unit can be operated in the system environment explained here.

System requirements	CPU	Pentium IV 2.4 GHz or Higher(with USB 2.0) for basic performance (Recommended for optimal performance: Pentium IV 3.2 GHz or Higher).
	Memory	256 MB or larger (Recommended: 512 MB).
Hard disk		20 GB or more free space. (The free space needed for writing depends on the quantity of data.)
Video Memory		64 MB (Recommended: 128 MB).
Interface		USB 2.0 (3.0 Compatible)
Software Required OS		Windows 10/8.1/8/7/Vista/XP(SP3), Mac OS X v.10.7.5 or Higher

- For Windows Vista or later, 1 GB of RAM or large is recommended.
- Under Windows 8 operating system, a specific mainboard with nVidia GeForce 7025 Chipset may cause an abnormal operation.

Specifications

Supported Discs	DVD-ROM(Single/Dual), DVD-RW, DVD-R, DVD+RW, DVD+R, DVD+R Double layer, DVD-R Dual layer, DVD- RAM, M-Disc (DVD+R SL), CD-Digital Audio & CD-Extra, CD-Plus, CD-ROM, CD-ROM XA-Ready, CD-I FMV, CD-TEXT, CD-Bridge, CD-R, CD-RW, Photo-CD (Single & Multi-Session), Video CD, DVD-VIDEO		
	Media	Write :	Read :
DVD-ROM	DVD-ROM	-	8 x max.
	DVD-R	2 x, 4 x, 8 x	8 x max.
	DVD-R DL	2 x, 4 x, 6 x	8 x max.
	DVD-RW	2 x, 4 x, 6 x	8 x max.
	DVD-RAM (Ver.2.2)	2 x, 3 x, 5 x	6 x max.
	DVD+R	2.4 x, 4 x, 8 x	8 x max.
	M-Disc (DVD+R SL)	4 x	8 x max.
	DVD+R DL	2.4 x, 4 x, 6 x	8 x max.
	DVD+RW	2.4 x, 4 x, 8 x	8 x max.
	CD-R	10 x, 16 x, 24 x	24 x max.
	CD-RW	4 x, 10 x, 16 x, 24 x	24 x max.
	CD-ROM	-	24 x max.
	CD-DA(DAE)	-	24 x max.

Notes:

- Please do not connect the USB cables by any means other than specified above. Using the wrong type of cable with this drive can cause it to malfunction.
- The appliance is not intended for use by young children or infirm persons without supervision. Young Children should be supervised to ensure that they do not play with appliance.
- If the appliance is supplied from a cord extension set or an electrical portable outlet device, the cord extension set on electrical portable outlet device must be positioned so that it is not subject to splashing or ingress of moisture.

- The drive supports both Windows and Mac . To use it properly, please follow directions below.
- How to Eject Disc from the drive
- When using with Mac
 - Click the eject button located on Mac OS menu or toolbar.
 - When using with Windows
 - Press the eject button in the front of the product.
- * Software CD (for Windows only)
- The Software CD includes DVD software for usage for Windows.

What is TV Connectivity?

TV Connectivity is a function that allows you to enjoy videos, pictures and music by connecting this product to a compatible A/V device (e.g.DIGITAL TV, DIGITAL PHOTO FRAME, PC) that supports USB connectivity.

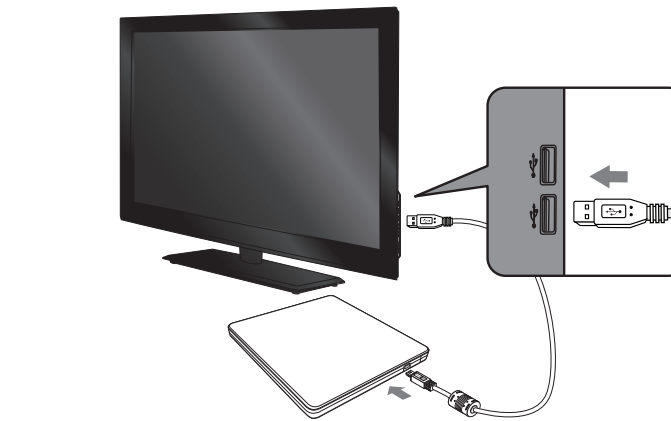

How to Use TV Connectivity

- * This product is defaulted to ODD mode when it is powered on.
1. With the tray open, press and hold the 'Eject' button for 2 seconds. (The LED indicator will turn on, switching to TV mode. Press and hold the button again for 2 seconds with the tray open to return to ODD mode).
 2. Insert your supported media into the drive. The disc file system will be converted to FAT32 and will be recognized as USB flash memory.
 3. Select and play the files from your A/V device to enjoy videos, pictures and music. Refer to your A/V device owner's manual for more information.

Notes:

- Normal operation is not guaranteed if you use a USB hub or unspecified USB extension cables.
- Due to compatibility issue of some AV devices and disc, may not work.

Recommended discs

Recommended media manufacturer	CD-R : LG, Mitsubishi Kagaku Media, Verbatim, That's, TDK, Ritek or HP discs are recommended. CD-RW : LG, Mitsubishi Kagaku Media, Verbatim are recommended. DVD-R : Mitsubishi Kagaku Media, Maxell, That's are recommended. DVD-RW : Victor, JVC, Mitsubishi Kagaku Media, TDK are recommended. DVD+R : Mitsubishi Kagaku Media, That's, Maxell are recommended. DVD+RW : TDK, Mitsubishi Kagaku Media, Ricoh are recommended. DVD-RAM : Maxell, Mitsubishi Kagaku Media are recommended. M-Disc (DVD+R SL) : Millenniata DVD±R DL : Mitsubishi Kagaku Media, Verbatim are recommended.
--------------------------------	---

- * Compatibility problem in write/read function may occur with some media depending on the media manufacturing quality.
* To achieve maximum Record & Write speed your system may require data to be copied first to the computer's hard drive rather than directly from another source disc or drive.
* Please visit <http://www.m-disc.com> to learn more about the M-DISC.™

- Microsoft® and Windows® are trademarks registered in the United States and other countries by the Microsoft Corporation.
- The company names and product names written in this manual are trademarks or registered trademarks of the respective companies.



Quick Set-up Guide
Slim Portable DVD Writer
GP55

To install of your product, please read this guide manual carefully and completely.

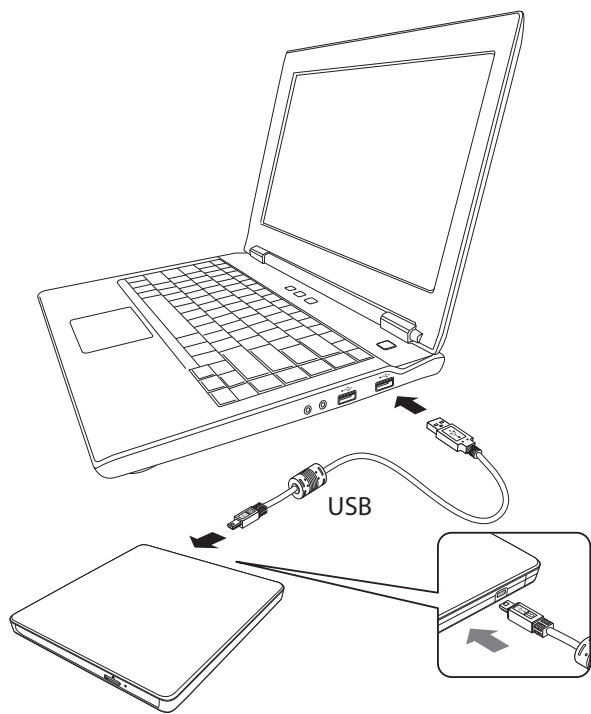

• 'Surface Pro 3, 4' Compatibility – The drive can work with 'Surface Pro 3, 4' via single USB connection.

Safety Instructions

- ⚠ CAUTION : The laser used in the Writer can damage your eyes.
Do not attempt to open the cover. To reduce the risk of electric shock, do not remove the cover (or back). There are no user-serviceable parts inside. Refer servicing to qualified service personnel. Use of controls or performance of procedures other than those specified herein may result in hazardous radiation exposure.
- ⚠ WARNING : To reduce the risk of fire or electric shock, do not expose this appliance to rain or moisture.

CLASS 1	LASER PRODUCT
KLASSE 1	LASER PRODUKT
LUOKAN 1	LASER LAITE
KLASS 1	LASER APPARAT
CLASSE 1	PRODUCTO LASER
CLASSE 1	PRODOTTO LASER

- CAUTION : CLASS 3B VISIBLE AND INVISIBLE LASER RADIATION WHEN OPEN AND INTERLOCKS DEFEATED.AVOID EXPOSURE TO THE BEAM.
ADVARSEL : KLASSE 3B SYNLIG OG USYNLIG LASERSTRÅLING I ÅBENT TILSTAND OG VED AFBRIJDT LÅSEFFUNKTION. UNDGÅ ATBLIVE RAMT AF LASERSTRÅLEN.
VARO! : LUOKKA 3B AVATTAESSAJA KUUMOTTAASSALUKITUS NÄKYVÄÄ JA NÄKYMÄTÖNTÄ LASERSÄTEILYÄ. VÄLTÄ LASERSÄTEILLE ALTISTUMISTA.
ATTENTION : CLASSE 3B RAYONNEMENT LASER VISIBLE ET INVISIBLE EN CAS D'OUVERTURE ET ENLENCHEMENTS DEFECTUEUX. EVITER L'EXPOSITION AU FAISCEAU.
VORSICHT : SICHTBARE UND UNSICHTBARE LASERSTRÄHLUNG DER KLASSE 3B WENN ABECKUNG GEÖFFNET UND SICHERHEITSVERREGELUNG ÜBERBRÜCKT VERMEIDEN SIE ES, SICH DEM STRAHL AUSZUSETZEN.
ADVARSEL : KLASSE 3B SYNLIG OG USYNLIG LASERSTRÅLING NÄR ÅPNES OG LÅS BRYTES. UNNGÅ EKSPONERING FOR STRÅLEN.
VARNING : KLASS 3B SYNLIG OCH OSYNLIG LASERSTRÅLNING FÖREKOMMER NÄR OCH MELLANLÅSET FÖRSTÖRS. UNDVIK EKSPONERING UNDER STRÅLEN.

FCC COMPLIANCE STATEMENT

- Note : This equipment has been tested and found to comply with the limits for a Class B digital device, pursuant to Part 15 of the FCC Rules. These limits are designed to provide reasonable protection against harmful interference in a residential installation. This equipment generates, uses, and can radiate radio frequency energy and, if not installed and used in accordance with the instructions, may cause harmful interference to radio communications. However, there is no guarantee that interference will not occur in a particular installation. If this equipment does cause harmful interference to radio or television reception, which can be determined by turning the equipment off and on, the user is encouraged to try to correct the interference by one or more of the following measures:
- Reorient or relocate the receiving antenna.
 - Increase the separation between the equipment and receiver.
 - Connect the equipment into an outlet on a circuit different from that to which the receiver is connected.
 - Consult the dealer or an Authorized Service Center for help.
- FCC WARNING
Changes or modifications not expressly approved by the party responsible for compliance could void the user's authority to operate the equipment.
- This product is for use only with UL listed personal computers that have installation instructions detailing user-installation of card cage accessory.

Declaration of Conformity

This device complies with Part 15 of the FCC Rules. Operation is subject to the following two conditions : (1) this device may not cause harmful interference, and (2) this device must accept any interference received, including interference that may cause undesired operation.

Model : GP65NB60, GP65NG60, GP65NS60, GP65NW60, GP55EX70, GP65NB70, GP65NG70, GP65NW70, GP65NS70
Responsible Party : Hitachi-LG Data Storage, Austin FA Center
Address : 11801 Stonehollow Dr. Suite 125 Austin, TX 78758
Telephone Number : (512) 832-8082