

Craft
Cube:

Stainless Solid

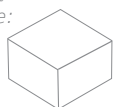

Integrated Solid

BrightShield®

BrightShield® protects against viruses, bacteria, mold, & mildew.



Key Features

- **Industry-exclusive slow melting clear ice cubes perfect for whiskeys and cocktails**
- **High production rate of 160 cubes per day**
- **Up to 25 lbs in ice storage capacity**
- **Industry leading BrightShield® antimicrobial lighting creates a clean environment for ice**
- Designed for built-in or freestanding applications
- Easy clean process only lasts 45 minutes
- Environmentally friendly R600a refrigerant (1.976 oz)
- Factory installed drain pump
- Field reversible door is shipped right-hand hinged
- Four adjustable leveling legs
- High efficiency variable speed compressor with 1.7 running amps
- Ice scoop included
- Indicator alert notifies when cleaning is needed
- Integrated model requires ¾" custom door panel and handle (not supplied by U-Line)
- Makes square cubes 1 7/8" L x 1 7/8" W x 1 1/4" H
- Silent setting temporarily suspends ice making for 3 hrs
- Soft close door with articulating hinge
- Stainless steel handle (7/8" diameter)

Model Details

Model	Description	Voltage/Hz	Shipping Weight
URCC115-SS81A	Craft Clear Ice Machine 15" Reversible Hinge Stainless Solid	115v / 60hz	125 lb
URCC115-IS81A	Craft Clear Ice Machine 15" Reversible Hinge Integrated Solid	115v / 60hz	121 lb

Accessories

Accessories	Description	Shipping Weight
ULAWATERHOOKUP	Braided Water Supply Line Kit	2 lb
80-55667-00	Clear Ice Machine Cleaner (Single 4 oz. Bottle)	1 lb

RCC115 • 15" Craft Clear Ice Machine

Front

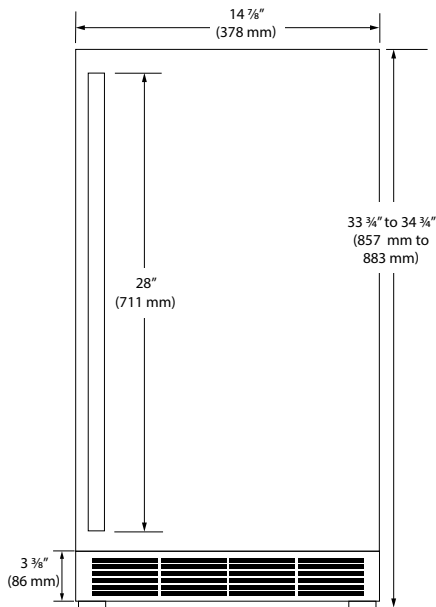

Side

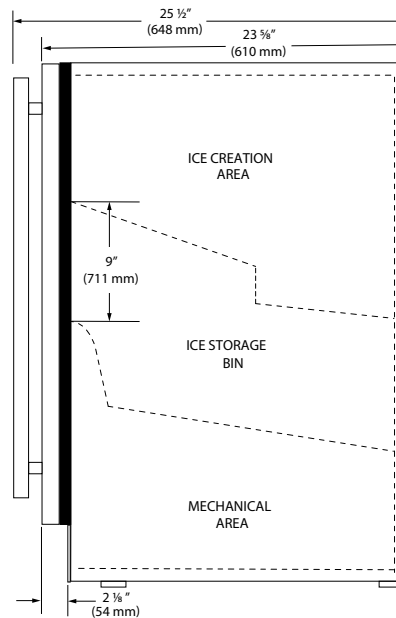

Top

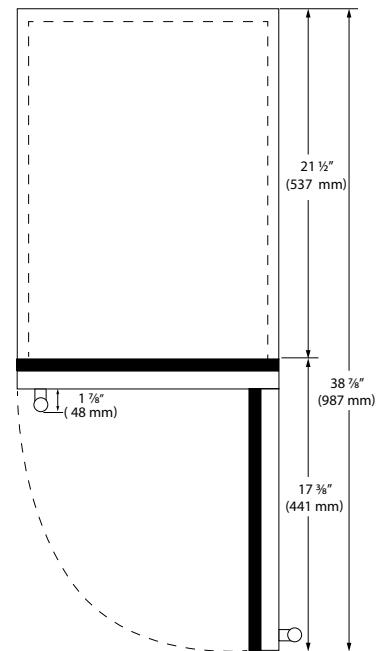

Specifications

Model	RCC115
Amps: Running	1.7
Dimensions: Product Depth	23 5/8" / 600 mm
Dimensions: Product Height	33 3/4" to 34 3/4" / 857 mm to 883 mm
Dimensions: Product Width	14 3/4" / 375 mm
ENERGY STAR	No
Ice Production Per Day	160 Cubes
Ice Storage	25 lb
Panel Height	30 7/16" / 773mm
Panel Thickness	3/4" 20mm
Panel Type	Solid Panel
Panel Width	14 3/4" / 375 mm
Product Weight: Max	122 lb
Refrigerant Type:	R600a

Back

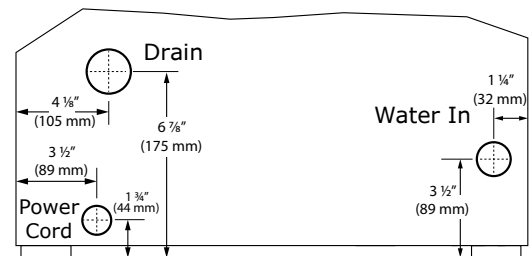

Cabinet Cut-Out

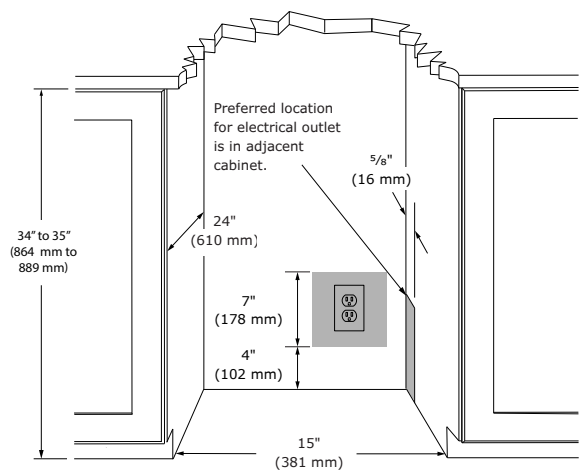

Installation Notes

- No additional clearance is needed for ventilation
- Do not obstruct front grille air flow

Warranty

- 1 Year (parts & labor) / 5 year sealed system (parts)

+ Additional 1 year (parts & labor) warranty at no cost with product registration.

See complete warranty for details



Please visit u-line.com to view this model's User Guide & Service Manual. All Specifications are subject to change without notice.

8900 North 55th Street • Milwaukee, Wisconsin 53223 USA • +1.414.354.0300 • sales@u-line.com • u-line.com