

WWD30



FEATURES

- Distributes heat evenly from 80 to 200 degrees Fahrenheit using fans
- Tested and approved for warming towels
- Fits entrées and sides easily in its generous 30 inch drawer cavity
- Includes hidden electronic controls
- Offers automatic shut-off

ACCESSORIES

- 30" Stainless Professional Front Panel - 2" Thick
- 36" Stainless Professional Front Panel - 2" Thick
- 6-Piece Container Set
- Contemporary Handle- E Series
- Contemporary/Transitional Handle
- Professional Handle-E Series
- Professional Handle-M Series
- Transitional Handle- M Series
- Warming Drawer Front Panel - Integrated
- Warming Drawer Front Panels - M Series
- Warming Drawer Front Panels - E Series

Accessories available through an authorized dealer.  
For local dealer information, visit [subzero-wolf.com/locator](https://subzero-wolf.com/locator).



FRONT PANEL OPTIONS



30" E SERIES TRANSITIONAL



30" E SERIES PROFESSIONAL



30" M SERIES CONTEMPORARY



30" M SERIES CONTEMPORARY STAINLESS



30" M SERIES TRANSITIONAL



30" M SERIES PROFESSIONAL



30" INTEGRATED



PRODUCT SPECIFICATIONS

Model	WWD30
Dimensions	29 7/8"W x 10 3/8"H x 22 3/4"D
Capacity	1.6 cu. ft.
Weight	75 lbs
Electrical Supply	120 VAC, 60 Hz
Electrical Service	15 amp dedicated circuit
Power Cord Length	3 Feet
Receptacle	3-prong grounding-type

ELECTRICAL

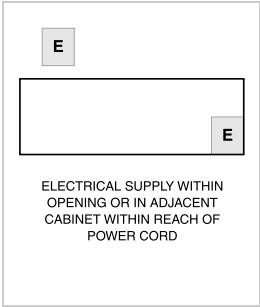

**INSTALLATION WITH FRONT PANEL** Accessory front panels may affect overall product dimensions and opening dimensions. Refer to Reveal for more information: [subzero-wolf.com/reveal](https://subzero-wolf.com/reveal)

**NOTE:** Dimensions in parenthesis are in millimeters unless otherwise specified

DIMENSIONS

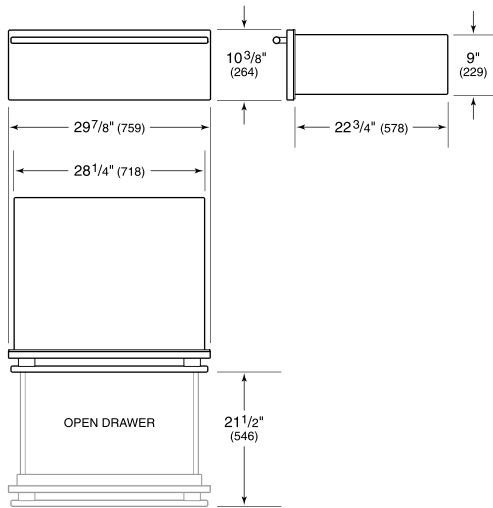

STANDARD INSTALLATION

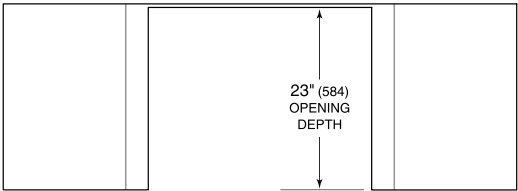

TOP VIEW

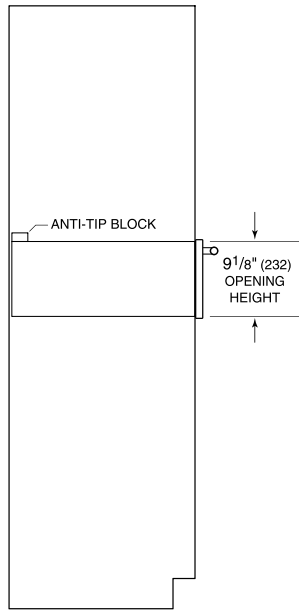

SIDE VIEW

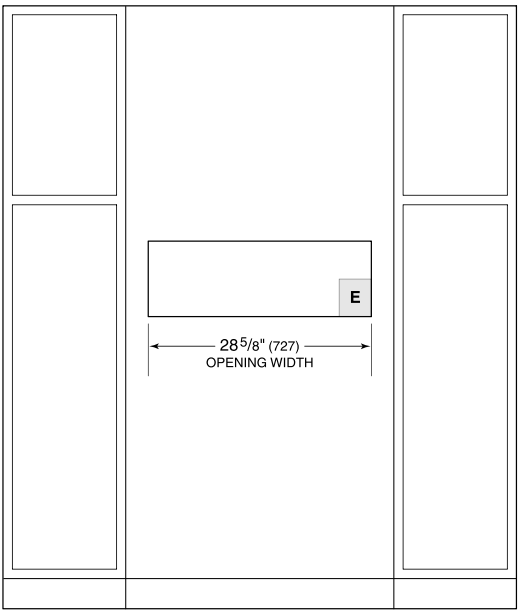

FRONT VIEW

**NOTE:** Location of electrical supply within opening may require additional cabinet depth.