

**24" 3.7 cu.ft. Vented Front Load Dryer, ENERGY STAR®****DV17600W2****Key Features & Benefits****OptiSense Technology**

OptiSense Technology offers precise control over water usage, energy efficiency, detergent levels, and wash time, ensuring the perfect wash every time while maximizing resource savings.

**AntiCrease Option**

The gentle Anti-Crease Option separates and smooths each garment as it dries, ensuring your clothes come out wrinkle-free and ready to wear at the end of the cycle.

**Large Capacity**

Blomberg's Large Capacity Dryers allow you to dry more in each load, reducing the number of cycles needed and saving you time and energy while ensuring optimal drying performance.

**Quick Dry**

The Quick Dry Cycle on Blomberg's dryers delivers fast, efficient drying for smaller loads, saving you time without compromising on performance. Perfect for when you need your clothes dry in a hurry.

**GENERAL PROPERTIES**

Dryer Type	Vented
Drum Material	Galvanized Steel
Style	Front Loading
Capacity	3.7 cu.ft.
Connectivity	No
Stackable	Yes
Stacking Kit Included	Yes
Matching Washer	WM72200X
CFM	120 CFM (without duct connection)

**MAIN FEATURES**

Interior Light	No
Clean Filter Indicator	Yes
Delay Start Time	0-24 Hours
Time Remaining Indicator	Yes
End of Cycle Buzzer	Yes
Child Lock	Yes
Adjustable Leveling Legs	4

**PROGRAMS**

# of Programs	15
Cottons/Normal	Yes
Permanent Press	Yes
Heavy Duty	Yes
Mixed Fabric	Yes
Sanitize	Yes
Air Fluff	Yes
Wool	Yes
Towels	Yes
Wrinkle Free	Yes
Delicates	Yes
Sportswear	Yes
Bedding	Yes
Quick Dry	Yes
Timed Dry (High Temperature)	Yes
Timed Dry (Low Temperature)	Yes
OptiSense Sensor Drying	Yes
AntiCrease+	Yes

**DIMENSIONS**

Product Dimensions (H x W x D)	33 11/16" x 23 9/16" x 25 1/2"
Product Weight	73.4 lbs.

**TECHNICAL DETAILS**

Energy Source	Electric
Minimum Circuit Breaker / Rated Amps	9.1-10.5 / 15 Amps
Volts	208-240 V
Frequency	60 Hz
Plug	4-Pin, 208-240 V
Door Hinge Location	Right
Reversible Door	No

**EFFICIENCY**

ENERGY STAR® Certified	No
Total Annual Energy Consumption (kWh)	260



**24" 3.7 cu.ft. Vented Front Load Dryer, ENERGY STAR®**

**DV17600W2**

**Dimensions and Installation**

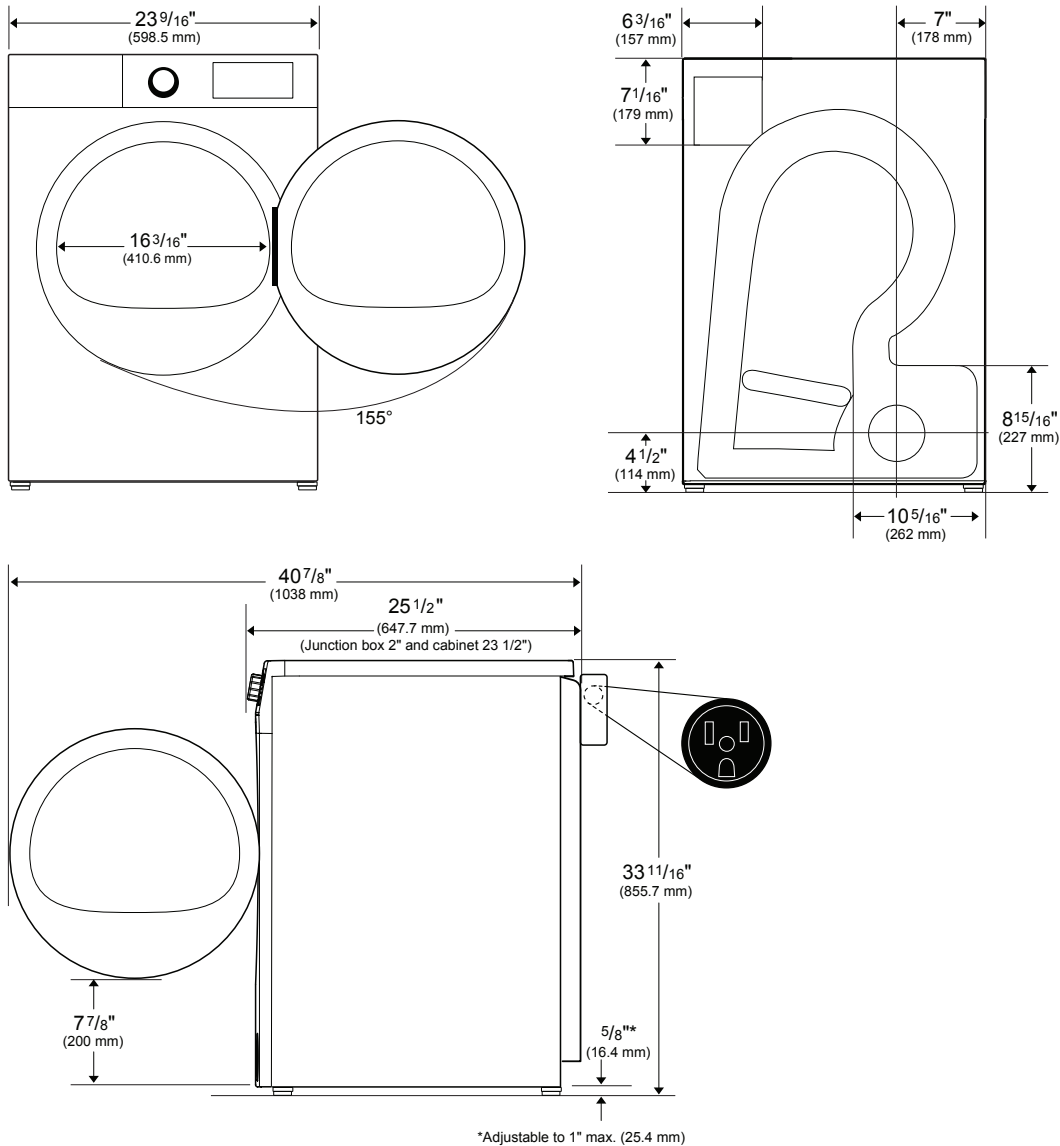

1 YEAR	2 YEARS
FULL WARRANTY	PARTS WARRANTY

NOTE TO THE INSTALLER: All height, width and depth dimensions are shown in inches (as well as metric). Beko Canada Inc. and Beko US Inc., reserves the absolute and unrestricted right to change product materials and specifications, at any time, without notice. Please visit our website (Canada) [www.blombergappliances.ca](http://www.blombergappliances.ca) / (USA) [www.blombergappliances.com](http://www.blombergappliances.com) or call (Canada) 855-643-2356 / (USA) 888-352-2356 to verify the latest specifications with final dimensional data and other details prior to installation and making a cutout. Applicable product limited warranty information may be found in accompanying product materials or you may contact your account manager for further details. Proper installation is the responsibility of the installer. Product failure due to improper installation is not covered under the Limited Warranty.

Canada: 855-643-2356 | [www.blombergappliances.ca](http://www.blombergappliances.ca)  
USA: 888-352-2356 | [www.blombergappliances.com](http://www.blombergappliances.com)

**24" 3.7 cu.ft. Vented Front Load Dryer, ENERGY STAR®****DV17600W2**

## Dimensions and Installation

## Clearances for Undercounter Installation

Only Vented Dryer

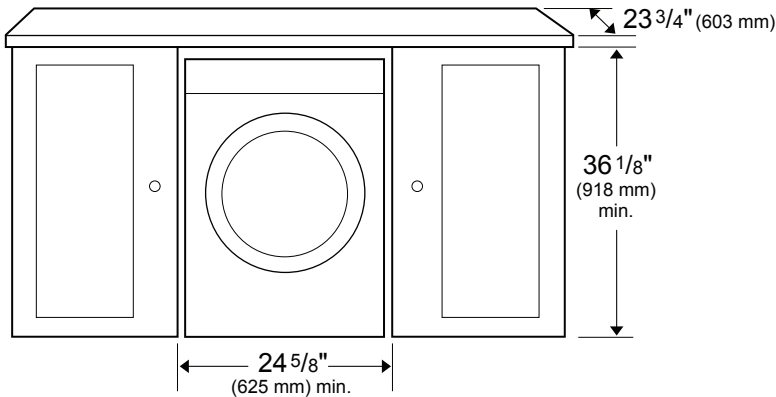
Required Minimum Clearances:  
(Stand Alone, Side by Side, or Stacked)

Washer	Vented Dryer
Top: 1" (25 mm)	Top: 1" (25 mm)
Sides: 1/2" (13 mm)	Sides: 3/16" (4 mm)
Rear: 1/2" (13 mm)	Rear: 4" (101.6 mm)
Front: 1/2" (13 mm)	Front: 3/16" (5 mm)

## Clearances for Undercounter Installation

Both Washer and Vented Dryer

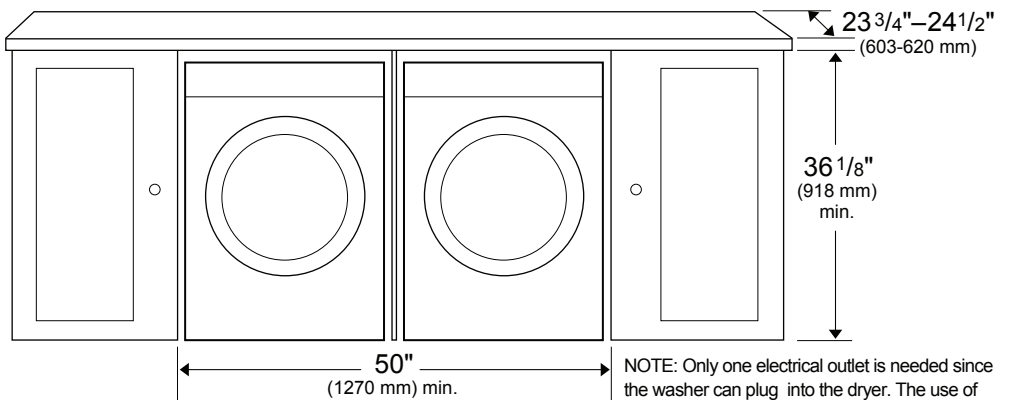

## Closet Door Ventilation Requirement

Washer:

A louver having minimum 23 in<sup>2</sup> (148 cm<sup>2</sup>) air opening located at 3 in (7.62 cm) distance from the bottom of closet door.

Vented Dryer:

A louver having minimum 46 in<sup>2</sup> (297 cm<sup>2</sup>) air opening located at 3 in (7.62 cm) distance from the top of closet door.

Heat Pump Dryer:

Closet door must have 2 openings, one located 3.2 inches (8 cm) from bottom of door having a minimum area of 16 in<sup>2</sup> (103 cm<sup>2</sup>) and the other one located 3 inches (7.5 cm) from top of door having a minimum area of 46 in<sup>2</sup> (294 cm<sup>2</sup>).

**24" 3.7 cu.ft. Vented Front Load Dryer, ENERGY STAR®****DV17600W2**

## Dimensions and Installation

Stacked Installation – Washer and Vented Dryer

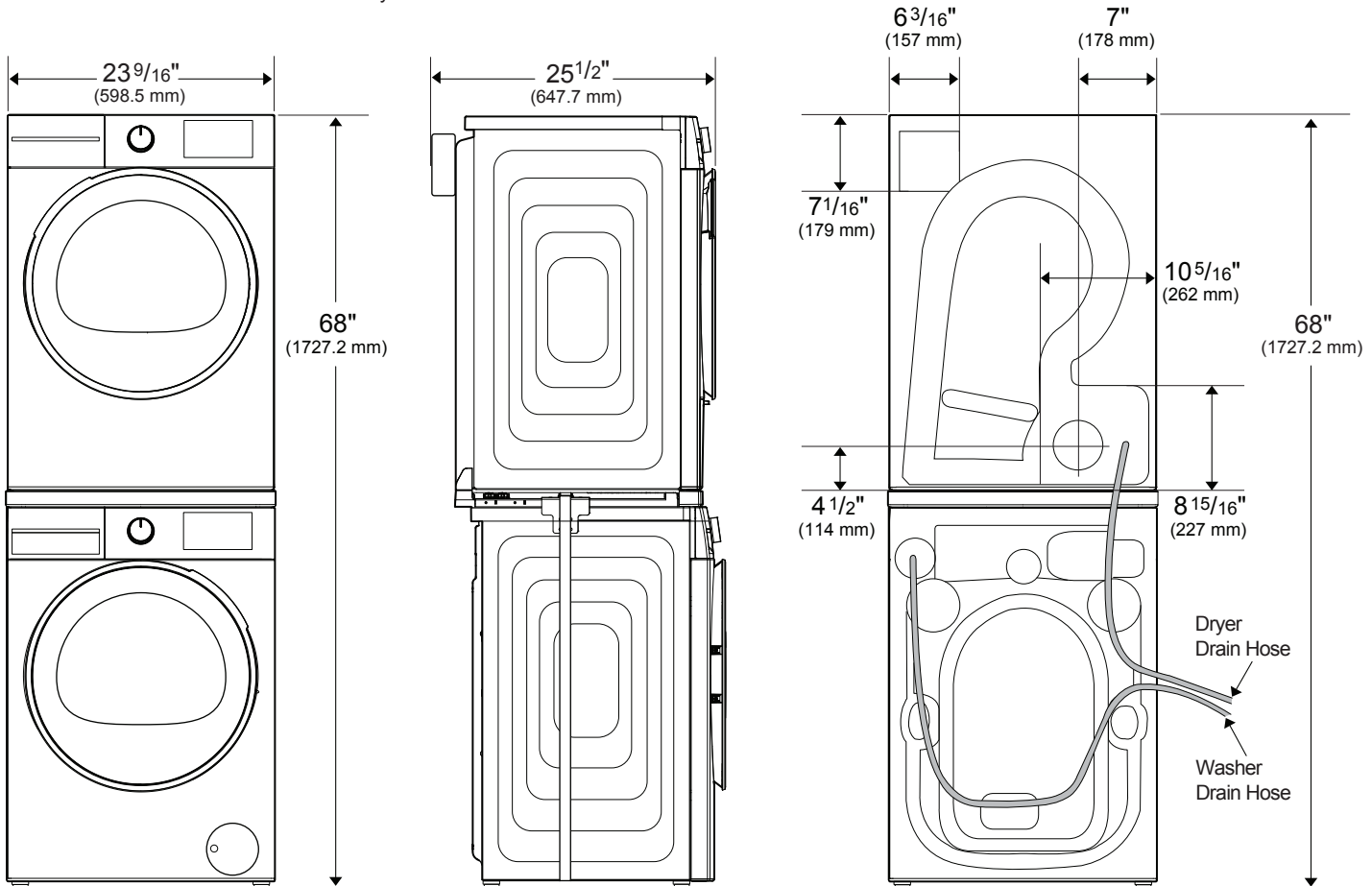

NOTE: Only one electrical outlet is needed since the washer can plug into the dryer. The use of two electrical outlets may be used as an alternative.

Metal rigid duct	
Number of Elbows	Length
0	92ft (28.0m)
1	82ft (25.0m)
2	72ft (21.9m)
3	62ft (18.9m)
4	52ft (15.8m)

Air Flow : 120 CFM (without duct connection)

**24" 3.7 cu.ft. Vented Front Load Dryer, ENERGY STAR®****DV17600W2**

## Dimensions and Installation

Stacked Installation in Closet or Enclosed Space – Washer and Vented Dryer

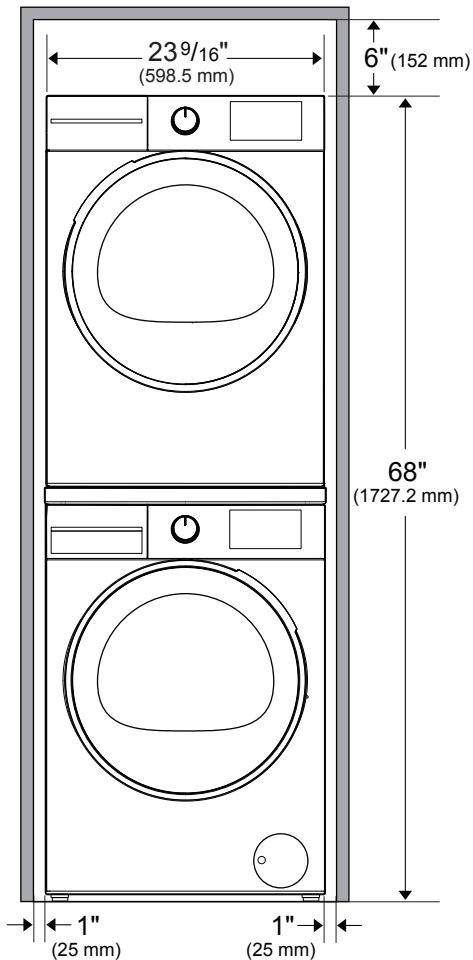

NOTE: Only one electrical outlet is needed since the washer can plug into the dryer. The use of two electrical outlets may be used as an alternative.

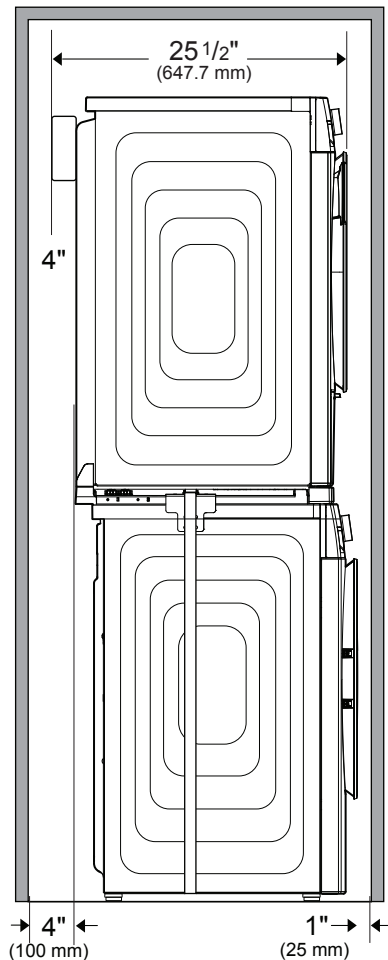

NOTE: The 4" clearance that is required should be measured from the back of the dryer cabinet, NOT from the junction box located at the top rear of the dryer.

NOTE: The 4" clearance is NOT measured from the back of the washer cabinet.

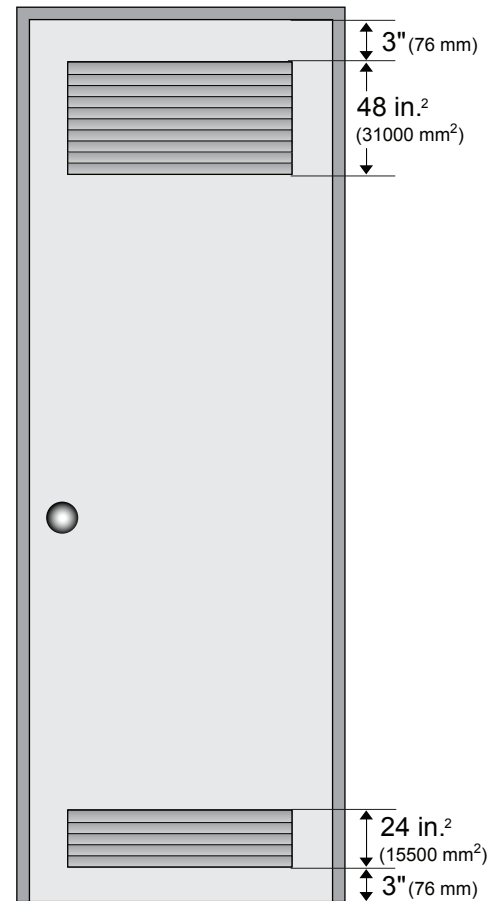

NOTE: The front of the closet must have two unobstructed air openings for a combined minimum total area of 72 sq.in. (465 sq.cm) with a minimum clearance of 3 in. (76 mm) at the top and bottom. A slatted door with equivalent space clearance is acceptable.