

LG SideKick® Pedestal Washer for 27" Front Load Washers with Detergent and Softener Dispensers

- 1.0 cu. ft. Capacity Pedestal Washer
- Perfect for Intimates, Hand Wash, and Small Loads
- Detergent and Fabric Softener Dispensers
- Touch Button Electronic Control Panel with LED Display
- NeveRust® Stainless Steel Tub
- Transparent Tinted Glass Door Cover
- Direct Drive Motor with 10-Year Limited Warranty

AVAILABLE COLORS

- BLACK STEEL
- GRAPHITE STEEL
- WHITE
- ALPINE WHITE



CAPACITY

Capacity 1.0 cu.ft.

APPEARANCE

Electronic Control Panel with LED Display Yes
Touch Button Yes

WASH PROGRAMS

No. of Programs 6
Normal, Intimates, Hand Wash, Rinse+Spin, Tub Clean, Downloaded

WASH OPTIONS

No. of Options 5
Warm Water, Rinse, Control Lock, Wi-Fi, Remote Start
No. of Wash/Rinse Temps 2 (Warm, Cold)
Twin Wash@Compatible Yes

CONVENIENCE FEATURES

End of Cycle Signal Yes
Child Lock Yes
Auto Suds Removal Yes
Forced Drain System Yes
Leveling Legs Yes
Smart Diagnosis™ Yes

MOTOR AND AGITATOR

Motor Type Direct Drive Motor
Motor Speed Variable
Max RPM 700

MATERIALS AND FINISHES

NeveRust® Stainless Steel Drum Yes
Cabinet Painted Steel
Control Panel Plastic
Door Rim Glass / Black
Door Cover Transparent Tinted Glass
Available Colors Black Steel (B), Graphite Steel (V), White (W), Alpine White (A)

POWER SOURCE

Ratings UL Listed
Electrical Requirements 120V, 5 Amps
Type Electric

DIMENSIONS

Product (WxHxD) 27" x 14 1/8" x 30 3/4"
(50 1/2" with drawer open)
Carton (WxHxD) 29 3/4" x 16 3/8" x 31 3/32"
Weight (Product/Carton) 105 lbs / 115 lbs

LIMITED WARRANTY

Parts and Labor 1 Year
Direct Drive Motor 10 Year
Drum Limited Lifetime

UPC

WD300CB (Black Steel) 195174038291
WD300CV (Graphite Steel) 195174043271
WD300CW (White) 195174038314
WD300CA (Alpine White) 048231349871

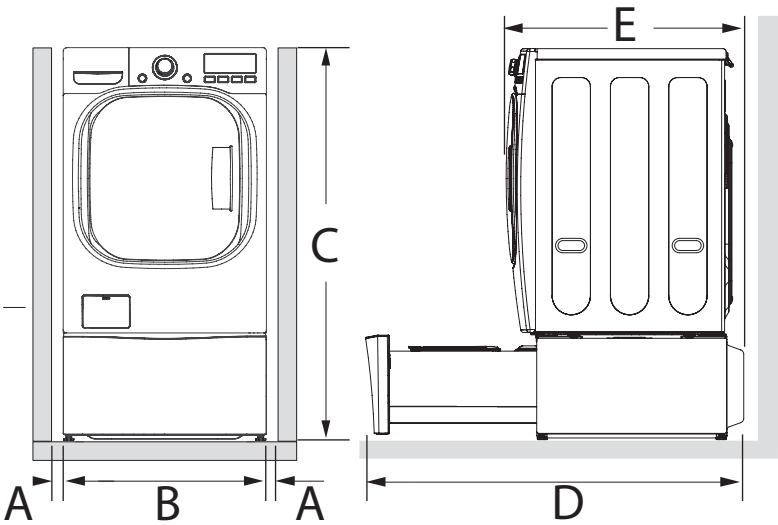

DIMENSIONS and CLEARANCES

A	1" (25cm)
B	27" (68.9cm) or 29" (73.7cm)
C	52 5/16" (132.9cm) or 54 1/4" (137.8cm)
D(+)	50 1/2" (128.3cm) or 52 3/4" (134cm)
E	29 3/4" (75.6cm) or 32" (82.1cm)

(+) 20" (50.8cm) additional needed for service

FLOORING

- To minimize noise and vibration, install the washer on a level, solidly constructed floor capable of supporting the washer without flexing or bouncing.
- The washer must be installed on firm flooring to minimize vibration during the spin cycle. Concrete flooring is best, but a wood floor is sufficient, provided it is built to FHA standards.
- The floor under the washer must not slope more than 1 inch (2.5 cm) from front to back or side to side.
- Installing on carpeting and soft tile surfaces is not recommended.
- Never install the washer on a platform or weakly supported structure.

FLOOR INSTALLATION

To ensure sufficient clearance for water inlet hoses, drain hose and airflow, allow minimum clearances of at least 1 inch (2.5 cm) at the sides and 4 inches (10 cm) behind the washer. Be sure to allow for wall, door, or floor moldings that may increase the required clearances

Front-Loading Washer and Pedestal Washer with Dryer

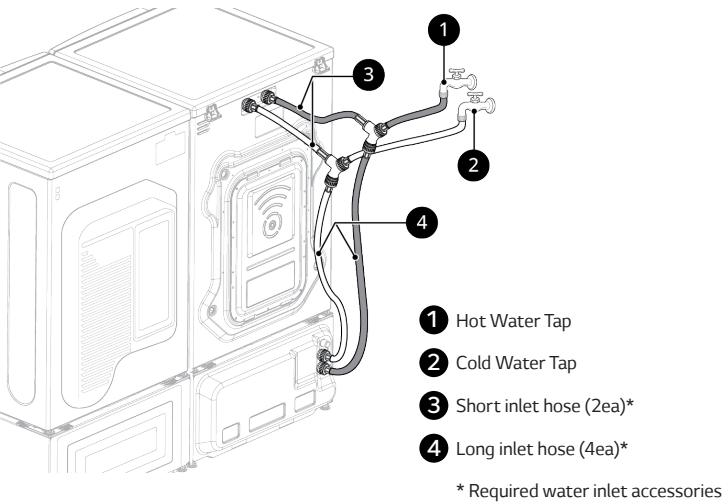

Front-Loading Washer and Pedestal Washer with Turbo Steam Dryer

