

TWD 360 WP 8kg

T1 Heat-Pump Dryer:

With Miele@home and FragranceDos for laundry that smells great.



- Ventless, up to 60% energy savings with heat-pump technology
- Precision drying of all fabrics – PerfectDry
- Quickly switch between 2 favorite fragrances – FragranceDos²
- ENERGY STAR® qualified
- Easy fingertip operation – DirectSensor

EAN: 4002516379409 / Material number: 11619730 / Old Material Number: 12WD3602USA

Construction type	
Stackable	•
Side-by-side	•
Slot-in	•
Door hinging	right, Reversible
Convertible door hinge	•
Model	
Product brand	T1 White Edition
Heat-pump dryer	•
Design	
Appliance color	Lotus white
Control panel color	Lotus white
Door design	Obsidian black with white ring
Rotary selector color	Lotus White
Fascia panel version	5° incline
Control type	Rotary selector
Display	DirectSensor yellow, 7 segment
Drying results	
PerfectDry precision drying	•
FragranceDos ² fragrance system	•
Intelligent drum reversal	•
Gentle laundry care	
Honeycomb drum	•
Load in lbs. (kg)	8.0
Control panel	
Networking with Miele@home	•
Delay start up to 24 hours	•
Countdown indicator	•
Drum lighting	LED
Condensed water container	•
Integrated condensed water drainage	•
AddLoad	•
Efficiency and sustainability	
EcoDry technology	•
Maintenance-free heat exchanger	•
ProfiEco motor	•
Drying programmes	
Delicates	•
Express	•
Outerwear	•
Proofing	•
Warm air/DryFresh	•
Normal	•
Woolens/Silks	•
Dress Shirts	•
Denims	•
Bed Linens	•

TWD 360 WP 8kg

T1 Heat-Pump Dryer:

With Miele@home and FragranceDos for laundry that smells great.



EAN: 4002516379409 / Material number: 11619730 / Old Material Number: 12WD3602USA

Options

Anti-crease action

•

Gentle tumble

•

Acoustic signal

•

Quality

Soft ribs

•

Safety

Lock code

•

Empty out container" indicator

•

Clean filter" indication

•

Optical interface

•

Technical data

Dimensions (width) in in. (mm)

23 1/2 (596)

Dimensions (height) in in. (mm)

33 1/2 (850)

Dimensions (depth) in in. (mm)

25 3/8 (643)

Depth with door open in in. (mm)

42 1/2 (1077)

Weight in lbs. (kg)

133 (60)

Total connected load in kW

1.00

Voltage in V

120

Fuse rating in A

15

Frequency in Hz

60

Length of supply lead in ft. (m)

6 (2.0)

Type of coolant

R134a

Refrigerant quantity in lbs

0.47

Accessories supplied

Fragrance flacon

•

TWD 360 WP 8kg

T1 Heat-Pump Dryer:

With Miele@home and FragranceDos for laundry that smells great.

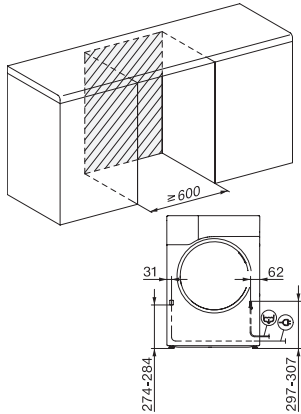

T1 installation drawing, facia 5 degree, measures in mm

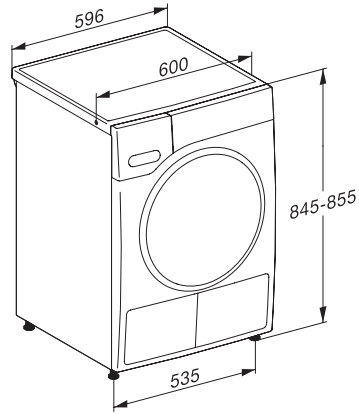

T1 drawing, facia 5 degree, measures in mm

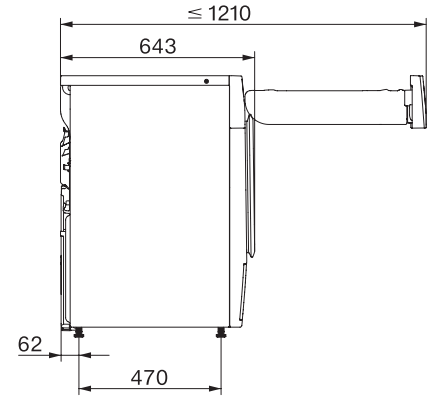

T1 drawing, facia 5 degree, with porthole, measures in mm

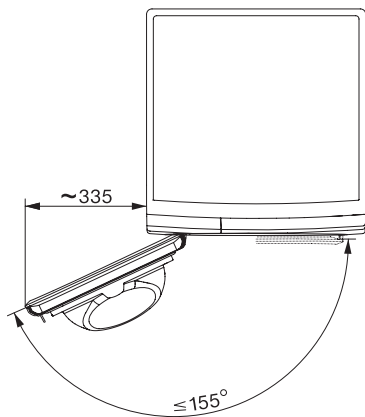

T1 drawing, facia 5 degree, measures in mm