

## WashTower™ with Center Control® & Dual Inverter HeatPump™ Technology

- Single Unit WashTower™ Design with Center Control
- 5.0 cu. ft. Washer / 7.8 cu. ft. Dryer
- TurboWash® 360° Wash Technology and Steam Technology
- DUAL Inverter HeatPump™ Technology
- Built-In Intelligence: AI Fabric Sensor / Infrared Sensor / Smart Pairing™
- Auto Cleaning Condenser™ & 3-Stage Lint Filter
- 6 Wash Cycles / 9 Wash Options
- 6 Dry Cycles / 8 Dry Options
- Allergiene™ Cycle
- Direct Drive Motor (10-Year Limited Warranty)
- NeveRust™ Stainless Steel Drum (Washer & Dryer)
- LG ThinQ® Technology (Wi-Fi)



**Heat Pump  
Dryer**  
(No Venting  
Required)

### COLOR AVAILABILITY

● WKHC252HBA – Black Steel

○ WKHC252HWA – White

### CAPACITY

Washer Capacity (cu. ft.) 5.0

Dryer Capacity (cu. ft.) 7.8

### APPEARANCE

Center Control® Yes

Electronic Controls with LED Display Yes

Touch Buttons Yes

### ENERGY & WATER

ENERGY STAR® Certified Yes (Most Efficient)

CEE Qualified Tier 2

Integrated Modified Energy Factor (IMEF) 2.92

Integrated Water Factor (IWF) 2.9

CEF 9.0

### WASH CYCLES

Number of Cycles 6

Wash Cycles Normal, Bedding, Delicates, Heavy Duty, Quick Wash, Downloaded

### WASH OPTIONS

Number of Options 9

Options TurboWash®, Steam, Extra Rinse, Pre-wash, Tub Clean\*, Drum Light\*, Control Lock\*, Signal\*, Wi-Fi\* / Remote Start\*

### WASH DETAILS

Internal Heater Yes

Number of Wash/Rinse Temps 5

Wash/Rinse Temps Hot, Very Warm, Warm, Cool, Cold

Number of Spin Speeds 5

Spin Speeds High, Medium/High, Medium, Low, No Spin

Max RPM 1300

Water Levels Load Sensing

Number of Soil Levels 5

AAFA Certified Yes

### DRYER CYCLES

Number of Cycles 6

Sensor Dry Cycles Normal, Bedding Delicates, Heavy Duty, Small Load, Downloaded

### DRYER OPTIONS

Number of Options 8

Options Wrinkle Care, More Time, Less Time Condenser Care, Drum Light\*, Control Lock\*, Signal\*, Wi-Fi\* / Remote Start\*

Dry Modes Energy Saver, Normal, Speed

Drying Levels Very, More, Normal, Less, Damp

Manual Dry Times 70 Min., 60 Min., 50 Min., 40 Min., 30 Min.

### FABRIC CARE (WASHER)

AI DD® Yes

Wash Technology TurboWash® 360°

Steam Technology Yes

Allergiene® Cycle Yes

Sanitary Cycle No

## FABRIC CARE (DRYER)

Steam Technology	Yes
AI Sensor Dry™	Yes (2.0 - with IR Sensor)
Sensor Dry	Yes
Precise Temperature Control with Variable Compressor	Yes

## CONVENIENCE

TrueBalance™ Anti-Vibration System	Yes
Dispenser Type	4 Tray (Prewash, Main Wash [with Liquid Detergent Cup], Bleach, Fabric Softener)
End of Cycle Signal	Yes
LoadSense	Yes
Control Lock	Yes
Auto Suds Removal	Yes
Drum Light	Yes
Lint Filter	Yes
Auto Cleaning Condenser™	Yes
Wrinkle Care Option	Yes
Remaining Time Display/Status Indicator(s)	Yes
Reversible Doors	No
Venting Option	NA (Ventless)
3 Minute Installation Check	NA
4 Adjustable Leveling Legs	Yes
ADA Compliant	No

## SMART FEATURES

Wi-Fi Enabled	Yes
ThinQ® Technology	Yes
ThinQ Care	No
ThinQ Up	Yes
Voice Control	Google Assistant, Amazon Alexa
SmartDiagnosis™	Yes
Remote Start (On/Off)	Yes
Remote Monitoring & Notifications	Yes
Energy Monitoring	Yes
Smart Learner	Yes
Smart Pairing	Yes
Tub Clean Coach	Yes

## MOTOR AND AGITATOR

Motor Type	Inverter Direct Drive Motor
Axis	Horizontal

## MATERIALS AND FINISHES

Drum Material – Washer	NeveRust™ Stainless Steel Drum
Drum Material – Dryer	NeveRust™ Stainless Steel Drum
Door / Rim	Tinted Large Circle /Chrome Rim
Tempered Glass Doors	Yes

## TECHNICAL SPECS

Electrical Requirements – Washer	120V, 10 Amps
Electrical Requirements – Dryer	240V, 15 Amps
Power Outlet Location	Within 60" of Either Side of Unit
Plug Type – Washer	3-Prong (Cord Attached to Unit)
Plug Type – Dryer	Electric: 4-Wire (Cord Required)
Min. / Max. Water Pressure	20 - 120 psi

## OPTIONAL ACCESSORIES

Pet Care Accessories Kit	PETK1W
--------------------------	--------

## DIMENSIONS

Product (W x H x D)	27" x 74 3/8" x 32 3/4"
Depth with Door Open	57 1/2"
Cutout Dimensions (W x H x D)	29" x 75 3/8" x 36 3/4"
Carton Dimensions (W x H x D)	29 1/4" x 77 1/2" x 33 1/4"
Approx. Weight (Product / Carton)	353.0 lbs / 380.0 lbs

## LIMITED WARRANTY

Parts and Labor	1 Year
Direct Drive Motor	10 Years
Drum	3 Years
Inverter Compressor & Motor	10 Years

## DIMENSIONS / CLEARANCES

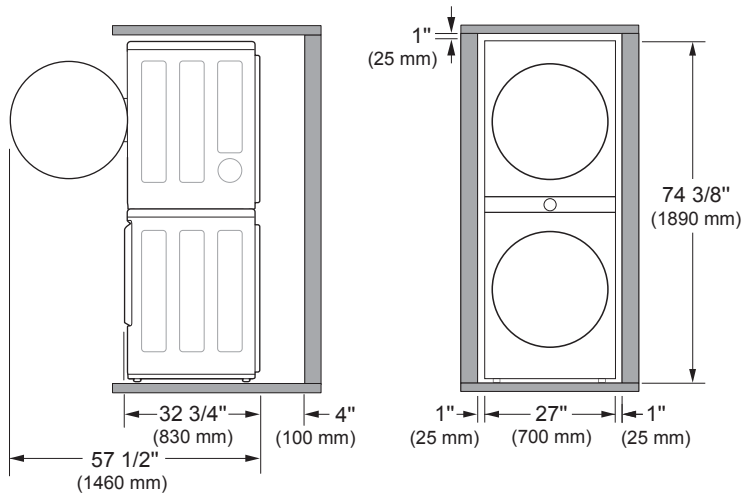

### Dimensions / Clearances

To ensure sufficient clearance for water inlet hoses, drain hose and airflow, allow minimum clearances of at least 1" (2.5 cm) at the sides and 4" (10 cm) behind the appliance. Be sure to allow for wall, door, or floor moldings that may increase the required clearances.

## SPACING FOR RECESSED AREA OR CLOSET INSTALLATION

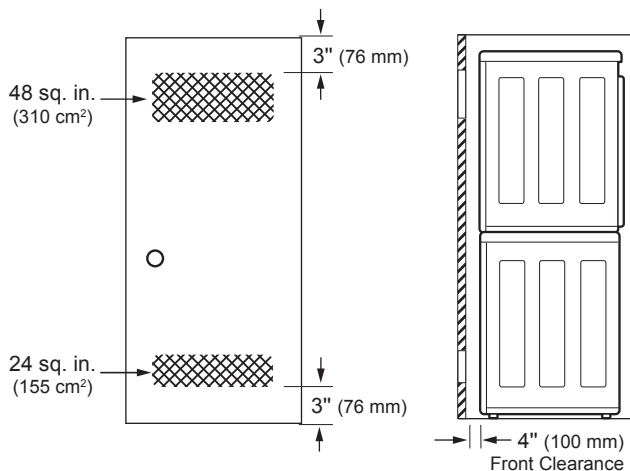

### Closet Ventilation Requirements

Closets with doors must have both an upper and lower vent to prevent heat and moisture buildup in the closet. One upper vent opening with a minimum opening of 48 sq. in. (310 cm²) must be installed no lower than 6 feet above the floor. One lower vent opening with a minimum opening of 24 sq. in. (155 cm²) must be installed no more than one foot above the floor. Install vent grills in the door or cut down the door at the top and bottom to form openings. Louvered doors with equivalent ventilation openings are also acceptable.

## ELECTRIC CONNECTION LOCATIONS (REAR VIEW)

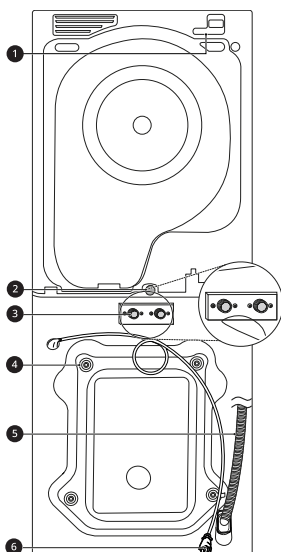

- 1 Terminal Block Access Panel
- 2 Dryer Drain Outlet (behind stacking bracket)
- 3 Hot and Cold Water Inlets
- 4 Shipping Bolts
- 5 Drain Hose (for Washer)
- 6 Power Cord (for Washer)

## CONNECTING THE WATER INLET HOSE

- Connect the water inlet hoses to the hot and cold water faucets tightly by hand and then tighten another 2/3 turn with pliers.
- Connect the blue hose to the cold water faucet and the red hose to the hot water faucet.

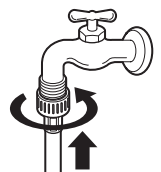

**CONNECTING ELECTRIC DRYERS****Electrical Requirements for Electric Models Only**

- This dryer must be connected to a grounded metal, permanent wiring system, or an equipment-grounding conductor must be run with the circuit conductors and connected to the equipment-grounding terminal or lead on the dryer.
- The dryer has its own terminal block that must be connected to a separate 240 VAC, 60-Hertz, single-phase circuit, fused at 15 amperes (the circuit must be fused on both sides of the line). ELECTRICAL SERVICE FOR THE DRYER SHOULD BE OF THE MAXIMUM RATE VOLTAGE LISTED ON THE NAMEPLATE. DO NOT CONNECT THE DRYER TO 110-, 115-, OR 120-VOLT CIRCUIT.
- If the branch circuit to dryer is 15 ft. (4.5 m) or less in length, use UL (Underwriters Laboratories) listed No.-10 AWG wire (copper wire only), or as required by local codes. If over 15 ft. (4.5 m), use UL-listed No.-8 AWG wire (copper wire only), or as required by local codes. Allow sufficient slack in wiring so the dryer can be moved from its normal location when necessary.
- The power cord (pigtail) connection between the wall receptacle and the dryer terminal block IS NOT supplied with the dryer. Type of pigtail and gauge of wire must conform to local codes.

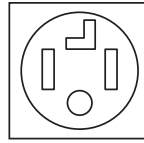
**FOUR-WIRE POWER CORD**

- A 4-wire connection is required for all mobile and manufactured home installations, as well as all new construction after January 1, 1996.
- A UL-listed strain relief is required.
- Use a 30-amp, 240-volt, 4-wire, UL-listed power cord with #10 AWG-minimum copper conductor and closed loop or forked terminals with upturned ends.

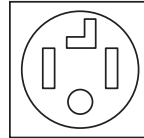
**FOUR-WIRE DIRECT WIRE**

- A 4-wire connection is required for all mobile and manufactured home installations, as well as all new construction after January 1, 1996.
- A UL-listed strain relief is required.
- Use UL-listed 4-wire #10 AWG minimum copper conductor cable. Allow at least 5 ft. (1.5 m) of wire to allow for removal and reinstallation of the dryer.