



OWNER'S MANUAL

LG Digital Signage

(MONITOR SIGNAGE)

Please read this manual carefully before operating your set and retain it for future reference.

65TR3PN-B	65TR3PN-I
75TR3PN-B	75TR3PN-I
86TR3PN-B	86TR3PN-I

Table of Contents

Getting to Know the Product 3

Checking Components.....	3
--------------------------	---

Checking Optional Components.....	5
-----------------------------------	---

Installing the Product 6

Installing on Wall.....	6
-------------------------	---

Checking Wall Mount Support Specifications	6
--	---

Installing the Product	7
------------------------	---

Connecting to Power.....	8
--------------------------	---

Exploring the Product 9

Names of Each Part.....	9
-------------------------	---

Front	9
-------	---

Back	10
------	----

Side	11
------	----

Checking the Input/Output Terminals	12
-------------------------------------	----

Front Cable Terminal	12
----------------------	----

Side Cable Terminal	13
---------------------	----

Bottom Cable Terminal	14
-----------------------	----

Using the Touch Pen	15
---------------------------	----

Getting to Know the Touch Pen Functions	15
---	----

Storing the Pen	16
-----------------	----

Replacing the Pen Tip	16
-----------------------	----

Using the Wi-Fi Module	17
------------------------------	----

Installation Procedure	17
------------------------	----

Feature	17
---------	----

Precautions for Use 18

Glass Breakage.....	18
---------------------	----

Dust.....	18
-----------	----

Afterimage	18
------------------	----

Recommended Usage Condition	19
-----------------------------	----

Product Specifications 20

Touch screen.....	21
-------------------	----

Speaker	21
---------------	----

Specifications by Model	22
-------------------------------	----

Resolution.....	23
-----------------	----

HDMI / USB Type-C / DP Supported Mode	23
---------------------------------------	----

Wireless module Specifications.....	25
-------------------------------------	----

Licence 26

WARNING - This equipment is compliant with Class A of CISPR 32. In a residential environment this equipment may cause radio interference.

| Getting to Know the Product

Checking Components

An electronic blackboard is a display product that can be used by touching the screen. A touch pen, remote control and others are provided with the product. If any of the listed components are missing, contact customer support. LG Electronics also sells optional components that can help you use the product more effectively as separate purchases.

Product specifications or components may change without prior notice according to the quality improvements or feature upgrades.



Caution

- To ensure user safety and product longevity, do not use counterfeit products. If the product is damaged as a result of using counterfeits, the warranty does not apply. In such cases, the user cannot be compensated even if injured.
- If the product is used in an environment with excessive dust, the warranty does not apply.



Note

- Remove all tapes attached to the front before connecting the product to power.
- Cables used when connecting to external devices must be purchased separately.
- Keep the product box and do not discard it. It can be used when moving the product.

Checking Components

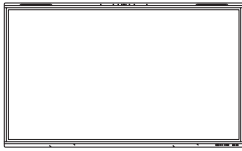

Electronic blackboard

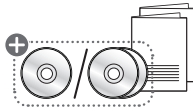

User manual and warranty

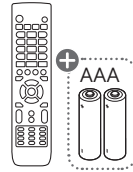

Remote control and batteries
(AAA, 2 pieces)



HDMI cable



Power cable



TOUCH cable



USB Type-C cable



Touch pens and pen tips



Wi-Fi Module

Note

- : Availability may vary depending on your geographic location.
- The components provided in the box may vary depending on the region and model.
- Component images shown in the user manual are for the user's understanding and may differ from actual components.

Checking Optional Components

Optional components may change without prior notice to improve product performance. New components may be added.

Note

- All optional components are separate purchases. Contact LG Electronics if you wish to purchase them.
- Component images shown in the user manual are for the user's understanding and may differ from actual components.

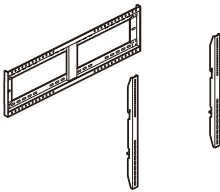

Wall Mount Holder (WM-L000S)

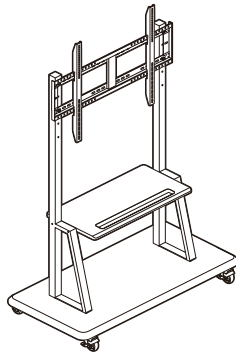

Floor stand (ST-000F)

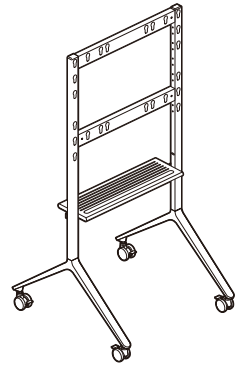

Universal stand (ST-860F)

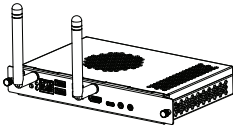

OPSJ-5LDJA

Note

- After connecting the cable to the port, mount the OPS (Open Pluggable Specification) PC.

Installing the Product

Installing on Wall

The electronic blackboard can be used in a wall-mounted format by securing it to a wall. To install it on a wall, first attach a wall mount support (optional) to the back of the product body.

The wall mount support is a separate purchase and can be purchased from a nearby dealer. For more information on installing a wall mount support, see the installation guide provided with your wall mount support purchase.

Checking Wall Mount Support Specifications

When installing a wall mount support, you must use screws and brackets that comply with VESA (Video Electronics Standards Association) standard specifications.

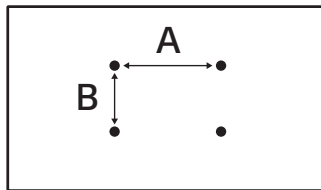

Model Name	VESA Dimensions (A x B) (mm)	Screw Specifications	Length (Maximum) (mm)	Quantity
	VESA Dimensions (A x B) (inches)		Length (Maximum) (inches)	
65TR3PN-B	600 x 400	M8	25	4
65TR3PN-I	23.6 x 15.7		0.9	
75TR3PN-B	800 x 400	M8	25	4
75TR3PN-I	31.4 x 15.7		0.9	
86TR3PN-B	800 x 600	M8	25	4
86TR3PN-I	31.4 x 23.6		0.9	

**Caution**

- Disconnect the power cord first before moving or installing the product. There is risk of electric shock.
- Do not install the product on a ceiling or sloped wall. There is a risk of falling and injury.
- If you tighten the screws too tightly and damage the product, the warranty may not apply.
- Use screws and brackets for wall mounting that meet the VESA standard specifications. The warranty does not apply to the breakage or personal injury due to the use of incorrect components.
- Using screws longer than VESA standard specifications when installing a wall mount support may damage the interior of the product. In such cases, we do not take responsibility for any damage or issues that may arise with the product.

Installing the Product

Allow at least 10 cm (3.9 inches) of clearance from the wall for ventilation, and install the product with care to prevent it from falling. When purchasing a wall mount support, the installation guide and all necessary parts are included. A wall mount support can be purchased separately from a nearby dealer.

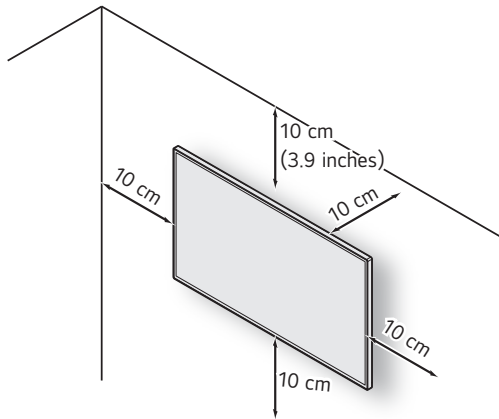

Connecting to Power

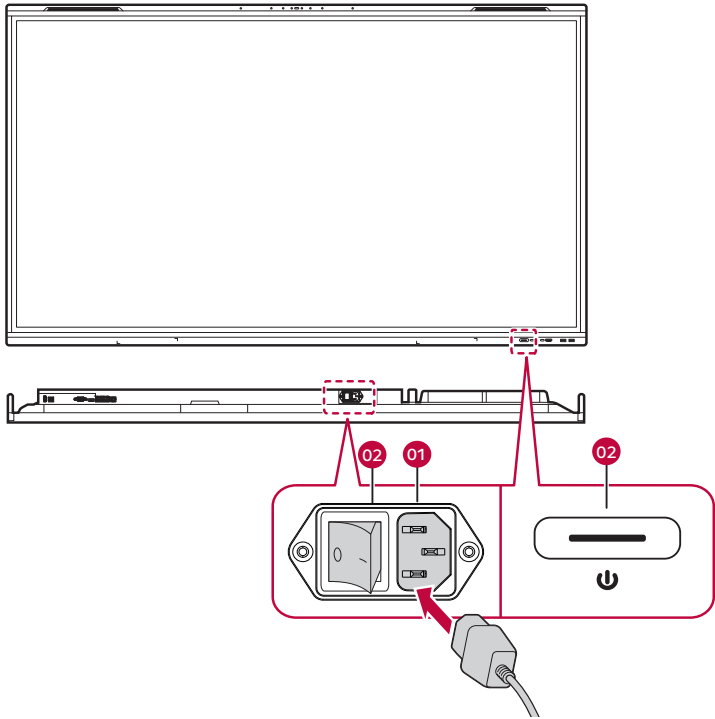

- 1 Connect the power cable provided as a component to the power terminal at the bottom of the product.
- 2 Press the power switch on the front of the product or next to the power terminal to turn the power on.

! Note

- The screen may flicker if the product is turned on when it is cold. This is normal, so there is no need to worry.

No.	Name	Explanation
01	Power Cable Terminal	Connects the power cord.
02	Power switch	Turns the power on or off. - "I" means power on, and "O" means power off.

Exploring the Product

Names of Each Part

Front

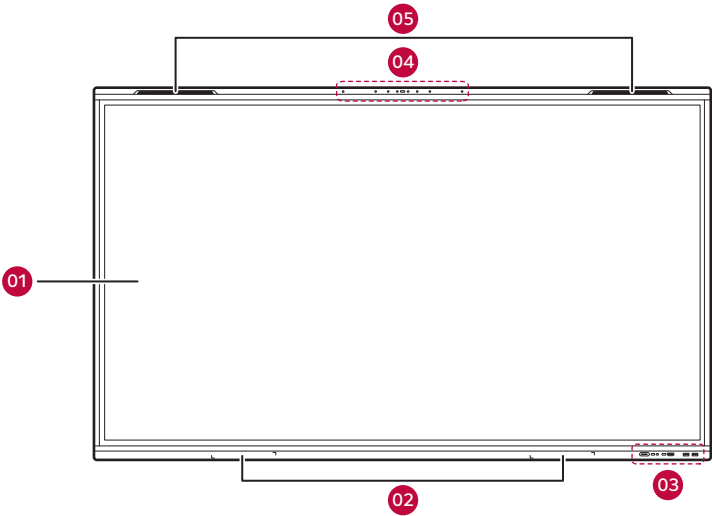

No.	Name	Explanation
01	Touch screen	Screen that displays the contents of the electronic blackboard and can be operated by touching it with your hand or with a touch pen.
02	Touch Pen Holder	Holds a touch pen by attaching it magnetically.
03	Front Cable Terminal	Terminals that allow you to connect each of the external devices of the following specifications. <ul style="list-style-type: none">• ⚡ IN• HDMI™ 4• 3.0
04	Microphone	Collects sound when the microphone is on. The white indicator means the microphone is on.
05	Speaker	Outputs the sound.

Back

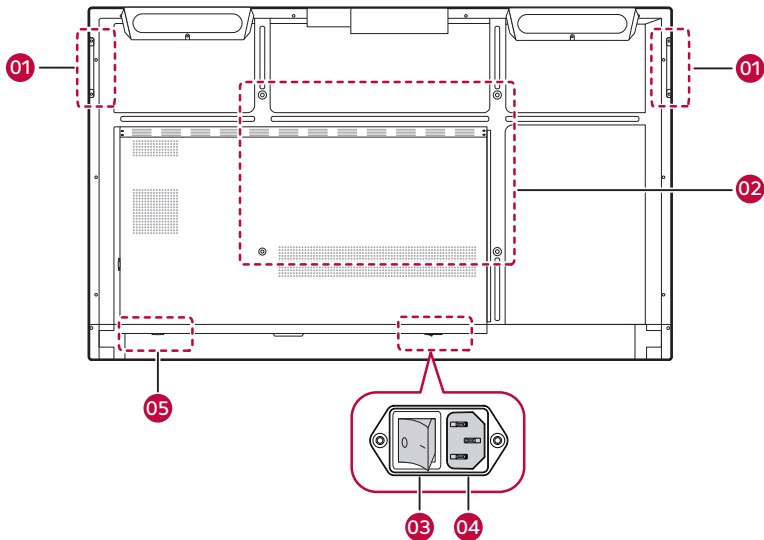

No.	Name	Explanation
01	Handle for Transportation	Used for moving the electronic blackboard.
02	Screw Holes	Used for mounting the electronic blackboard on a stand or installing it on a wall with a wall mount.
03	Power Sources	Turns the power on or off.
04	Power Cable Terminal	Connects the power cord.
05	Bottom Cable Terminal	<p>Terminals that allow you to connect each of the external devices of the following specifications.</p> <ul style="list-style-type: none">• 2.0• TOUCH 2• RS232• IN• LAN• SPDIF

Side

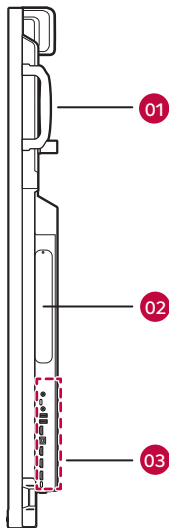

No.	Name	Explanation
01	Handle for Transportation	Used for moving the electronic blackboard.
02	Built-in PC (OPS) Slot	Inserts the built-in PC (OPS).
03	Side Cable Terminal	<p>Terminals that allow you to connect each of the external devices of the following specifications.</p> <ul style="list-style-type: none">• AUDIO / AUDIO OUT• OUT• 3.0• HDMI™ OUT• TOUCH 1• HDMI™ 1/2/3• ⚡ IN

Checking the Input/Output Terminals

Check the location and function of the input/output terminals for connecting external devices to the electronic blackboard.

Front Cable Terminal

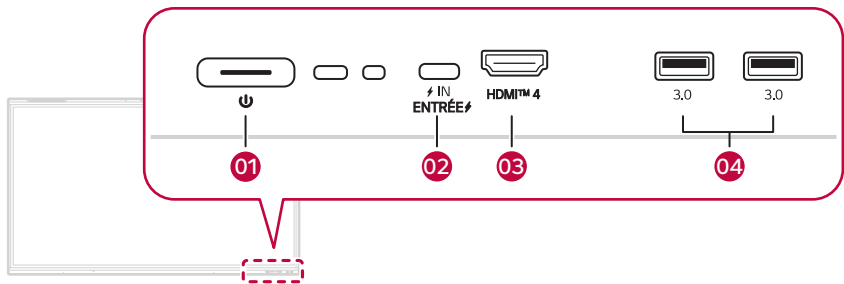

No.	Name	Explanation
01	Power Sources	Turns the power on or off.
02	⚡ IN	Used to connect external devices with a USB Type-C cable. Supports charging, data transfer, audio and video output interface expansion, etc.
03	HDMI™ 4	Used to connect external devices with a HDMI cable.
04	3.0	Used for data transfer or connecting USB devices such as a mouse or keyboard with a USB cable.

Side Cable Terminal

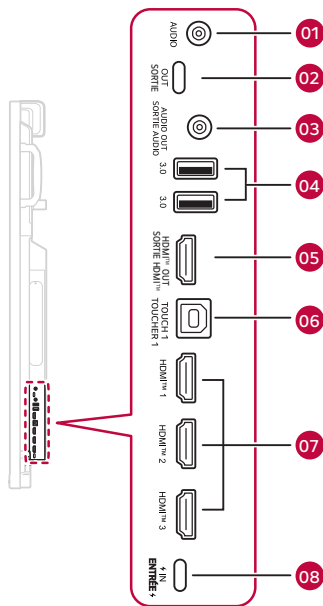

No.	Name	Explanation
01	AUDIO	Used to input audio from an external device.
02	OUT	Used to connect external devices with a USB Type-C cable. Supports data transfer, audio and video output interface expansion, etc.
03	AUDIO OUT	Used to output audio to an external device.
04	3.0	Used for data transfer or connecting USB devices such as a mouse or keyboard with a USB cable.
05	HDMI™ OUT	Used to export the screen to an external device with an HDMI cable.
06	TOUCH 1	Used for touch control of the PC screen input through the HDMI™ 1 / HDMI™ 2 terminal. Used to connect the TOUCH 1 terminal and PC with a TOUCH cable.
07	HDMI™ 1/2/3	Used to connect external devices with a HDMI cable.
08	⚡ IN	Used to connect external devices with a USB Type-C cable. Supports charging, data transfer, audio and video output interface expansion, etc.

Bottom Cable Terminal

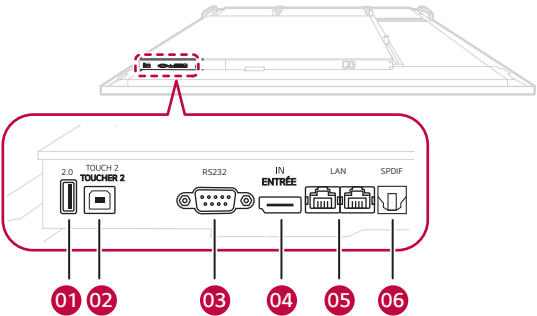

No.	Name	Explanation
01	2.0	Used for data transfer or connecting USB devices such as a mouse or keyboard with a USB cable.
02	TOUCH 2	Used for touch control of the PC screen input through the HDMI™ 3 terminal. Used to connect the TOUCH 2 terminal and PC with a TOUCH cable.
03	RS232	Used to connect an RS232 cable.
04	IN	Used to connect external devices with a DP cable.
05	LAN	Used for wired internet connection.
06	SPDIF	Used to output audio to an external device using an SPDIF cable.

Using the Touch Pen

The touch pen can be used for various purposes, such as touching the screen to launch menus or to take notes, annotate, and draw on data.

Getting to Know the Touch Pen Functions

Two pens can be used simultaneously to write or draw together. Different colors can be assigned to each pen.

A pen has a 3 mm (0.1 inches) and 8 mm (0.3 inches) tip at each end, allowing you to use two modes separately with one pen.

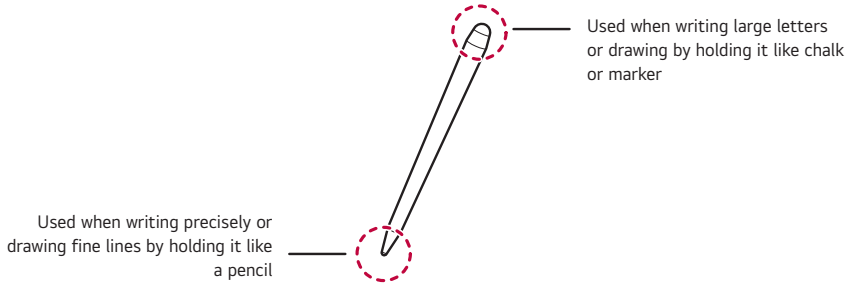

! Note

- If you press the pen on the screen for about 2 seconds and release it after you open a built-in PC (OPS), PDF viewer, or Word document, the same pop-up menu as when you right-click on the mouse will appear.

Using the Touch Pen

Storing the Pen

The touch pen can be attached to the magnetic touch pen holder to keep it in place, so you don't lose it.

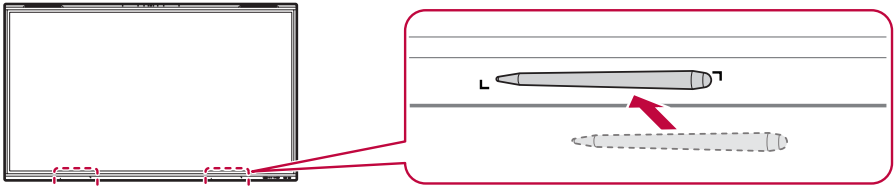

Replacing the Pen Tip

If the touch pen tip is worn or damaged, it must be replaced with a new tip.

- 1 Remove the old tip by pulling on the end with tools such as tweezers.
- 2 Slide the new tip into the pen body.

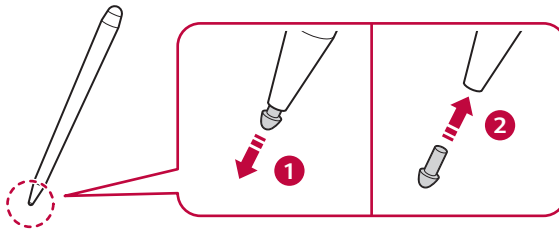

Note

- For additional purchases of touch pens or extra tips, contact LG Electronics.

Using the Wi-Fi Module

Installation Procedure

Caution

- Ensure the power cord of the product is disconnected before installation.

- 1 Unscrew and remove the Wi-Fi module cover located on the bottom of the product.

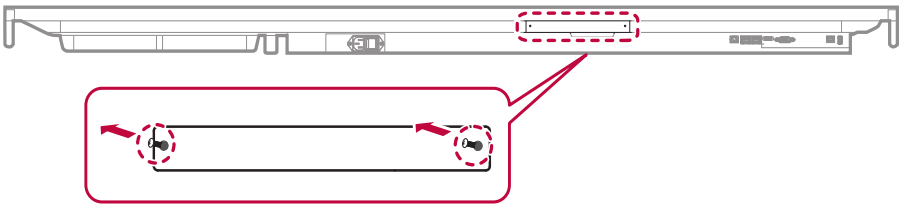

- 2 Following the direction of the arrow, insert the Wi-Fi module fully into the slot.

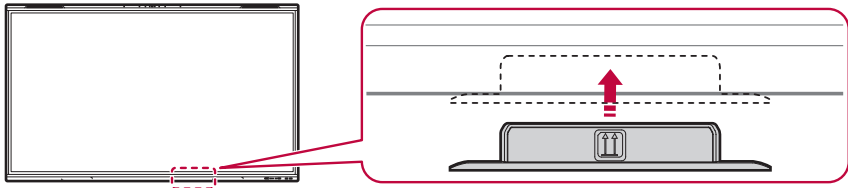

Feature

Once installation is complete, power on the product to automatically activate the Wi-Fi module.

- 1 Click [Settings] on the screen.
- 2 Clicking on [Wireless & Network] allows you to turn on and off [Wi-Fi] and [Hotspot] items.

Precautions for Use

Glass Breakage

- Although the screen of this product is made of tempered glass, it may still break as a result of abnormal impact or sudden temperature changes. Spontaneous breakage may also occur during use due to microscopic impurities or flaws in the glass. Since sharp fragments may be produced if the glass breaks, always wear protective gear when installing or handling the product. If the screen breaks while in use, move everyone nearby to a safe distance immediately to avoid injury from flying fragments.

Dust

The warranty will not cover any damage caused by using the product in an excessively dusty environment.

Afterimage

- After-image appears when the product is turned off.
 - Pixels may be damaged rapidly if a still image is displayed on the screen for a long period of time. Use the screen-saver function.
 - Switching from a screen with high differences in luminance (black and white or grey) to a darker screen may cause an afterimage. This is normal due to the display characteristics of this product.
- When the LCD screen is in a still pattern for extended periods of use, a slight voltage difference may occur between the electrodes that operate the liquid crystal (LC). The voltage difference between the electrodes increases over time and tends to keep the liquid crystal aligned in one direction. At this time, the previous image remains, which is called an afterimage.
- Afterimages do not occur when continuously changing images are used but take place when a certain screen is fixed for a long time. The following are operational recommendations for reducing the occurrence of afterimages when using a fixed screen. The maximum recommended time for switching the screen is 12 hours. Shorter cycles are better for preventing afterimages.

Recommended Usage Condition

- 1 Change the background color and text color at equal intervals.
 - Afterimages occur less when the colors to be changed are complementary to one another.

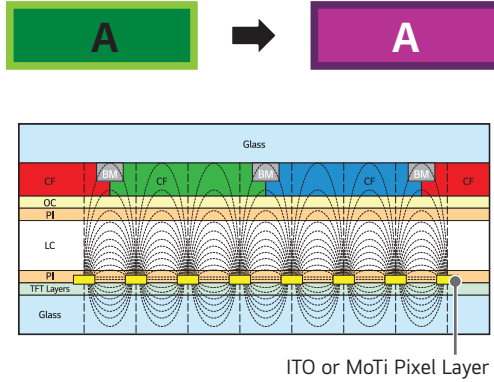

- 2 Switch the screen at equal time intervals.
 - Take caution, and ensure that text or images from before the screen change are not left in the same location after the screen change.



Product Specifications

Without prior notice, all product information and specifications contained in this manual are subject to change to improve the performance of the product.

The ~ symbol means alternating current, and the symbol --- means direct current.

Input/Output Ports	⚡ IN, HDMI™ 1/2/3/4, TOUCH 1/2, 2.0, 3.0, RS232, LAN, HDMI™ OUT, IN, OUT, AUDIO, AUDIO OUT, SPDIF	
Embedded Battery	Not Applied	
Resolution	Recommended Resolution	3840 x 2160 @ 60 Hz
	Max Resolution	3840 x 2160 @ 60 Hz This may not be supported on some OS or graphics card types.
Environmental Conditions	Operating Temperature	0 °C to 40 °C (32 °F to 104 °F)
	Operating Humidity	10 % to 90 % (Condition for preventing condensation)
	Storage Temperature	-20 °C to 60 °C (-4 °F to 140 °F)
	Storage Humidity	10 % to 90 % (Condition for preventing condensation) Product box packaging storage conditions

Note

- The maximum power rating of the USB Type-C port installed on this product is 100 W. When using this port to charge electronic devices, the charging power of the electronic device should not exceed the power rating of the port. If the charging power of the electronic device exceeds the charging power rating of the port, do not charge it directly using this port.
- Use a certified USB-C cable. (1.5 m (59 inches) or less) If you do not do so, the screen may not be displayed or a connection error may occur.
- USB-C ports do not support DPM (Sleep mode).
- Video daisy chain can be configured through HDMI™ OUT, and the input resolution can be supported up to 3840 x 2160 @ 30 Hz.

Touch screen

OS	Windows 10 / Windows 8 / Windows 7 / Android / Linux / macOS (Linux / macOS are supported with the 1 Point touch function.)	40 Points
	Chrome OS	16 Points
	Spacing between touches: at least 25 mm (0.9 inches)	

Speaker

* Applicable only to speaker-supporting models.

Audio	RMS audio output	8 W + 18 W (R + L)
	Input Sensitivity	0.5 Vrms
	Speaker impedance	6 Ω

Specifications by Model

65TR3PN-B 65TR3PN-I		
Power	Power Voltage	100-240 V~ 50/60 Hz 4.0 A
Dimensions (Width x Height x Depth) / Weight	1488 mm x 908 mm x 87.1 mm / 38.6 kg (58.5 inches x 35.7 inches x 3.4 inches / 85.0 lbs)	

75TR3PN-B 75TR3PN-I		
Power	Power Voltage	100-240 V~ 50/60 Hz 5.0 A
Dimensions (Width x Height x Depth) / Weight	1709 mm x 1031 mm x 86.4 mm / 51.4 kg (67.2 inches x 40.5 inches x 3.4 inches / 113.3 lbs)	

86TR3PN-B 86TR3PN-I		
Power	Power Voltage	100-240 V~ 50/60 Hz 6 A
Dimensions (Width x Height x Depth) / Weight	1957 mm x 1171 mm x 86.4 mm / 63.5 kg (77.0 inches x 46.1 inches x 3.4 inches / 139.9 lbs)	

Resolution

Note

- Vertical Frequency: The monitor screen functions by the screen image changing dozens of times every second like a fluorescent lamp. The vertical frequency or refresh rate is the number of image displays per second. The unit is Hz.
- Horizontal Frequency: The horizontal interval is the time taken to display one horizontal line. When one is divided by the horizontal interval, the number of horizontal lines displayed every second is the horizontal frequency. The unit is kHz.

HDMI / USB Type-C / DP Supported Mode

Resolution	Horizontal Frequency (kHz)	Vertical Frequency (Hz)	Note
640 x 480 @ 60 Hz	31.469	59.94	
640 x 480 @ 60 Hz 4:3	31.5	60	
720 x 480 @ 60 Hz 4:3	31.5	60	
720 x 480 @ 60 Hz	31.5	60	
800 x 600 @ 56 Hz	35.156	56.25	
800 x 600 @ 60 Hz	37.879	60.32	
848 x 480 @ 60 Hz	31	60	
1024 x 768 @ 60 Hz	48.363	60	
1280 x 720 @ 60 Hz	45	60	
1280 x 768 @ 60 Hz (RB)	47.396	59.99	
1280 x 768 @ 60 Hz	47.776	59.87	
1280 x 800 @ 60 Hz	49.702	59.81	
1280 x 960 @ 60 Hz	60	60	
1280 x 1024 @ 60 Hz	63.981	60.02	
1360 x 768 @ 60 Hz	47.712	60.02	
1366 x 768 @ 60 Hz	47.712	59.79	(For HDMI / USB Type-C only)

Resolution

Resolution	Horizontal Frequency (kHz)	Vertical Frequency (Hz)	Note
1400 x 1050 @ 60 Hz (RB)	64.744	59.948	
1400 x 1050 @ 60 Hz	65.317	59.978	
1600 x 900 @ 60 Hz	60	60	
1600 x 1200 @ 60 Hz	75	60	
1680 x 1050 @ 60 Hz (RB)	64.674	59.883	
1680 x 1050 @ 60 Hz	65.29	59.95	
1920 x 1080 @ 23 Hz	26.973	23.98	
1920 x 1080 @ 24 Hz	27	24	
1920 x 1080 @ 25 Hz	28.125	25	
1920 x 1080 @ 30 Hz	33.75	30	
1920 x 1080 @ 60 Hz	67.5	60	
1080i @ 60 Hz	33.75	60	(For HDMI / DP only)
1080i @ 50 Hz	28.125	50	(For HDMI / DP only)
3840 x 2160 @ 60 Hz	135	59.94	(For HDMI / USB Type-C only)
3840 x 2160 @ 50 Hz	112.5	50	(For HDMI / USB Type-C only)
3840 x 2160 @ 30 Hz	67.5	29.97	
3840 x 2160 @ 25 Hz	56.25	25	
3840 x 2160 @ 24 Hz	54	23.98	
3840 x 2160 @ 23 Hz	53.946	23.976	

Wireless module Specifications

Wireless module (SI07B) Specifications	
Wireless LAN (IEEE 802.11a/b/g/n/ac/ax)	
Frequency range (MHz)	Output power (Max.) (dBm)
2412 to 2472	19.14
5150 to 5250	18.90
5250 to 5350	15.11
5470 to 5725	17.37
5725 to 5850	13.58
Bluetooth	
Frequency range (MHz)	Output power (Max.) (dBm)
2402 to 2480	7.29
<ul style="list-style-type: none">• As band channels can vary per country, the user cannot change or adjust the operating frequency. This product is configured for the regional frequency table.• For consideration of the user, this device should be installed and operated with a minimum distance of 20 cm (7.8 inches) between the device and the body.• FCC ID : 2AFG6-SI07B / IC : 22166-SI07B	

Licence

Supported licenses may differ by model. Visit www.lg.com for more information on licenses.



The terms HDMI, HDMI High-Definition Multimedia Interface, HDMI trade dress and the HDMI Logos are trademarks or registered trademarks of HDMI Licensing Administrator, Inc.

**CRESTRON
CONNECTED**



Supplier's Declaration of Conformity

Trade Name	LG
Responsible Party	LG Electronics USA, Inc.
Address	111 Sylvan Avenue, North Building, Englewood Cliffs, NJ 07632
E-mail	lg.environmental@lge.com



This product qualifies for ENERGY STAR®.

Changing the factory default configuration and settings or enabling certain optional features and functionalities may increase energy consumption beyond the limits required for ENERGY STAR® certification.

Refer to ENERGYSTAR.gov for more information on the ENERGY STAR® program.

The model and serial number of the product are located on the back and on one side of the product. Record them below in case you ever need service.

MODEL _____

SERIAL NO. _____

Temporary noise is normal when powering ON or OFF this device.