

SUMMIT DREAMBILT

INDOOR/OUTDOOR ICE MACHINE



MODELS:

BIM62ADA

DBIM64CSS

BIM63OS

DBIM65CSS

User Manual

BEFORE USE, PLEASE READ AND FOLLOW ALL SAFETY RULES AND OPERATING INSTRUCTIONS.

Write Serial Nos. (on lower left corner of rear wall of door) here:

Felix Storch, Inc.
ISO 9001:2015 registered company
770 Garrison Avenue
Bronx, NY 10474
www.summitappliance.com

TABLE OF CONTENTS

Appliance Safety	3
Important Safeguards	3-5
Disposal	6
Location of Parts	7
Installation Instructions	8-17
<i>Before Using Your Appliance</i>	8
<i>Installation of Your Appliance</i>	8-9
<i>Electrical Connection</i>	9
<i>Extension Cord</i>	10
<i>Adjusting the Kick-plate</i>	10
<i>Installing the Stainless Steel Handle</i>	11
<i>Reversing the Door Swing of Your Appliance</i>	11-12
<i>Full Overlay Panel Installation Instructions</i>	13-15
<i>Water Supply and Drain Requirements</i>	16-17
<i>Installation Procedure</i>	17
<i>Installation Check List</i>	17
Operating Your Appliance	18-21
<i>Control Panel</i>	18-19
<i>Sequence of Operation</i>	19-20
<i>Ice Cube Size Selection</i>	20
<i>Mode Memory Function</i>	20
<i>Sabbath Mode</i>	20
<i>Cleaning Alarm</i>	20
<i>Operating Noise</i>	21
Care and Maintenance	22
<i>General</i>	22
<i>Cleaning the Cabinet Exterior</i>	22
<i>Cleaning the Interior</i>	23
<i>Cleaning/Sanitizing the Ice Making System</i>	23-24
<i>Full Cleaning/Sanitizing Procedure</i>	24-25
<i>Removal of Parts for Cleaning/Sanitizing</i>	25-26
<i>Preventing Stainless Steel Rust</i>	26-27
<i>Power Failure</i>	27
<i>Vacations</i>	27
<i>Moving Your Appliance</i>	28
<i>Energy-Saving Tips</i>	28
Troubleshooting	29-30
Limited Warranty	32

APPLIANCE SAFETY

Your safety and the safety of others are very important.

We have provided many important safety messages in this manual and on your appliance. Always read and obey all safety messages.



This is the Safety Alert Symbol. The symbol alerts you to potential hazards that can kill or injure you and others. All safety messages will follow the Safety Alert Symbol and either the word DANGER or WARNING.



DANGER means that failure to heed this safety statement may result in severe personal injury or death.



WARNING means that failure to heed this safety statement may result in extensive product damage, serious personal injury, or death.

All safety messages will alert you about the potential hazard, tell you how to reduce the chance of injury, and let you know what can happen if the instructions are not followed.

IMPORTANT SAFEGUARDS



Before the appliance is used, it must be properly positioned and installed as described in this manual, so read the manual carefully. To reduce the risk of fire, electrical shock or injury when using the appliance, follow basic precautions, including the following:



- Plug into a grounded 3-prong outlet, do not remove the grounding prong, do not use an adapter, and do not use an extension cord.
- Replace all parts and panels before operating.
- It is recommended that a separate circuit serving only your appliance be provided. Use receptacles that cannot be turned off by a switch or pull chain.
- **WARNING:** Never clean appliance parts with flammable fluids. These fumes can create a fire hazard or explosion. And do not store or use gasoline or other flammable vapors and liquids or explosive substances such as aerosol cans with a flammable propellant in this appliance or in the vicinity of this or any other appliance. The fumes can create a fire hazard or explosion.
- Do not connect or disconnect the electric plug when your hands are wet.
- Unplug the appliance or disconnect the power before cleaning or servicing. Failure to do so can result in electrical shock or death.
- Do not attempt to repair or replace any part of your appliance unless it is specifically recommended in this manual. All other servicing should be referred to a qualified technician.
- If the power cord is damaged, it must be replaced by the manufacturer, its service agent or similar qualified person in order to avoid a hazard.

**A3**

Warning: Risk of Fire / Flammable Materials.

- This appliance is CFC- and HFC-free and contains small quantities of Isobutane (R600a) which is environmentally friendly, but flammable. It does not damage the ozone layer, nor does it increase the greenhouse effect. Care must be taken during transportation and setting up of the appliance so that no parts of the cooling system are damaged. Leaking coolant can ignite and may damage the eyes.
- In the event of any damage:
 - Avoid open flames and anything which creates a spark.
 - Disconnect from the power supply,
 - Air the room in which the appliance is located for several minutes and contact the Service Department for advice.
- The more coolant there is in an appliance, the larger the room it should be installed in. In the event of a leakage, if the appliance is in a small room, there is the danger of combustible gases building up. For every ounce of coolant, at least 325 cubic feet of room space is required. The amount of coolant in the appliance is stated on the data plate inside the appliance. It is hazardous for anyone other than an Authorized Service Person to carry out servicing or repairs to this appliance.
- Take serious care when handling, moving, and using the appliance to avoid either damaging the refrigerant tubing or increasing the risk of a leak.
- Replacing component parts and servicing shall be done by factory-authorized service personnel, so as to minimize the risk of possible ignition due to incorrect parts or improper service.
- This appliance is not intended for use by persons (including children) with reduced physical, sensory or mental capabilities, or lack of experience and knowledge, unless they have been given supervision or instruction concerning use of the appliance by a person responsible for their safety.
- Children should be supervised to ensure that they do not play with the appliance.

**WARNING****FOLLOW THE WARNING CALLOUTS BELOW ONLY WHEN APPLICABLE TO YOUR MODEL**

- Use two or more people to move and install the appliance. Failure to do so can result in back or other injuries.
- **WARNING:** Keep ventilation openings, in the appliance enclosure or in the built-in structure, clear of obstruction.
- **WARNING:** Do not use mechanical devices or other means to accelerate the defrosting process or to clean, other than those recommended by the manufacturer.
- **WARNING:** Connect to potable water supply only.
- **WARNING:** The appliance shall be stored in a room without continuously operating ignition sources (for example: open flames, an operating gas appliance or an operating electric heater).
- **WARNING:** Do not pierce or burn. Do not damage the refrigerant circuit.
- **WARNING:** Be aware that refrigerants may not contain an odor.
- **WARNING:** In order to reduce flammability hazards the installation of this appliance must only be carried out by a suitably qualified person.
- **WARNING:** Flammable Refrigerant Used. Component parts shall be replaced with like components so as to minimize the risk of possible ignition due to incorrect parts.
- **WARNING:** Do not use electrical appliances inside the food storage compartments of the appliance, unless they are of the type recommended by the manufacturer.
- **WARNING:** To avoid a hazard due to instability of the appliance, it must be fixed in accordance with the instructions.
- **WARNING:** When positioning the appliance, ensure the supply cord is not trapped or damaged.
- **WARNING:** Do not locate multiple portable socket-outlets or portable power supplies at the rear of the appliance.

- **CAUTION:** Use this appliance only for its intended purpose. This equipment is intended for the storage and display of packaged products only.
- To ensure proper ventilation for your appliance, the front of the unit must be completely unobstructed. Choose a well-ventilated area with temperatures above 50°F (10°C) and below 110°F (43°C).
- The appliance should not be located next to ovens, grills, or other sources of high heat.
- The appliance must be installed with all electrical, water, and drain connections in accordance with state and local codes. A standard electrical supply (115 V AC only, 60 Hz), properly grounded in accordance with the National Electrical Code and local codes and ordinances, is required.
- Do not kink or pinch the power supply cord of the appliance.
- The size of the fuse (or circuit breaker) should be 15 amperes.
- It is important that the appliance be leveled in order to work properly. You may need to make several adjustments to level it.
- All installations must be in accordance with local plumbing code requirements.
- Make certain that the pipes are not pinched, kinked, or damaged during installation.
- Check for leaks after connection.
- Never allow children to operate, play with or crawl inside the appliance.
- Do not use solvent-based cleaning agents or abrasives on the interior. These cleaners may damage or discolor the interior.
- Use this appliance only for its intended purpose as described in this *Instruction Manual*.
- Keep fingers out of the “pinch point” areas. Clearances between the door and cabinet are necessarily small. Be careful closing the door when children are in the area.
- Never allow anyone, including children to sit, stand or climb on any part of the appliance, including the door. Doing so may cause damage, serious injury or death.
- If you receive a damaged product, immediately contact your dealer or builder. Do not install or use a damaged appliance.
- Make sure that this appliance has been properly installed according to the installation section. Make sure you know the location of the electrical outlet so that you know where and how to disconnect power. Making sure the appliance is properly installed is the responsibility of the customer.
- Do not place another appliance on top of the appliance.
- Disconnect this appliance when not in use.
- Never keep anything in the ice storage bin that is not ice. Objects like wine or beer bottles are not only unsanitary, but the labels can slip off and plug up the drain.
- The appliance is intended to be permanently connected to the water mains and not connected by a hose-set.
- **CAUTION:** Serving must be performed only as recommended by the manufacturer.

- SAVE THESE INSTRUCTIONS –

DISPOSAL

Dispose of your appliance packaging properly. Ensure that any plastic wrappings, bags, etc., are disposed of safely and kept out of the reach of babies and young children. **Danger of suffocation!**

Refrigeration equipment must be properly disposed of in a professional and appropriate way, in accordance with the current local regulations and laws which protect the environment. This applies to your old appliance and to your new unit once it has reached the end of its service life.

WARNING: Please ensure that old, worn appliances are rendered unusable before disposal by removing the doors, removing the plug, cutting the network cable, and removing or destroying any snap fastenings or bolts. Leave shelving in place. You will thus prevent children from locking themselves in the appliance during play (risk of suffocation) or endangering their lives in any other way. **DO NOT** dispose of the appliance in landfill as the insulation (Cyclopentane) and refrigerant gas (R600a) contained in these appliances are flammable.

Disposal instructions:

- The appliance must not be disposed of in the dustbin or with normal household rubbish.
- The coolant circuit, particularly the heat exchanger at the back/bottom of the unit, must not be damaged.
- The appliance is not to be handled as normal household waste but is to be taken to a recycling collection point for electrical and electronic goods. By correctly disposing of this product you are contributing to the protection of the environment and to the health of your fellow human beings. Improper disposal endangers health and the environment. Further information about the recycling of the product may be obtained from your town hall, refuse collection department or the store where you purchased the product.



Risk of child entrapment!

Child entrapment and suffocation are not problems of the past. Junked or abandoned appliances are still dangerous, even if they will “just sit for a few days.”

Before you throw away your old appliance:

- *Take off the doors*
- *Leave the shelves in place so that children may not easily climb inside.*

LOCATION OF PARTS

Models BIM63OS / DBIM65CSS

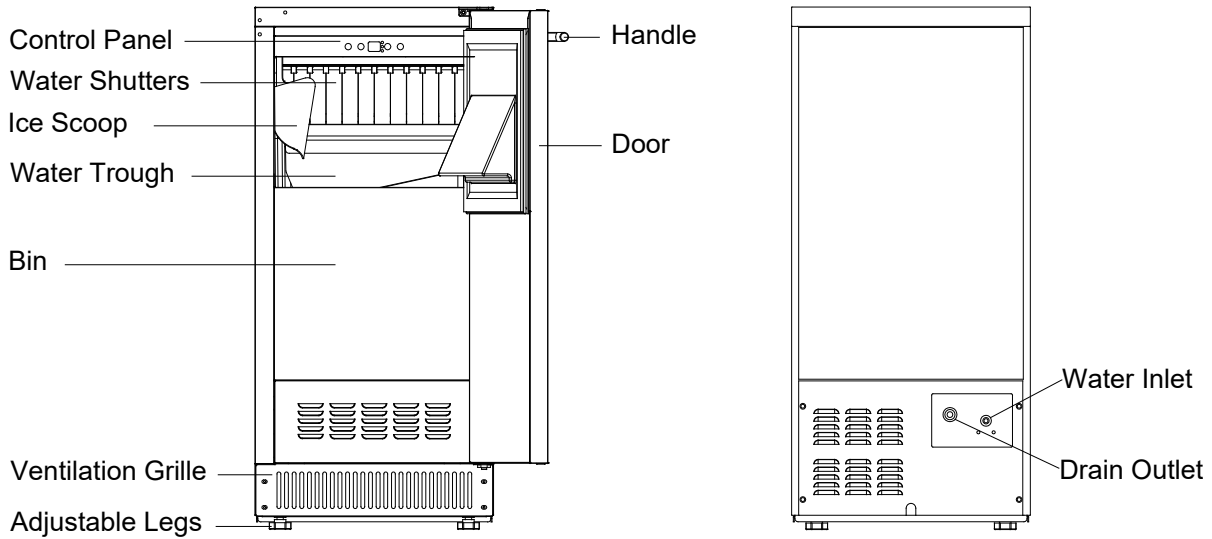

Models BIM62ADA / DBIM64CSS

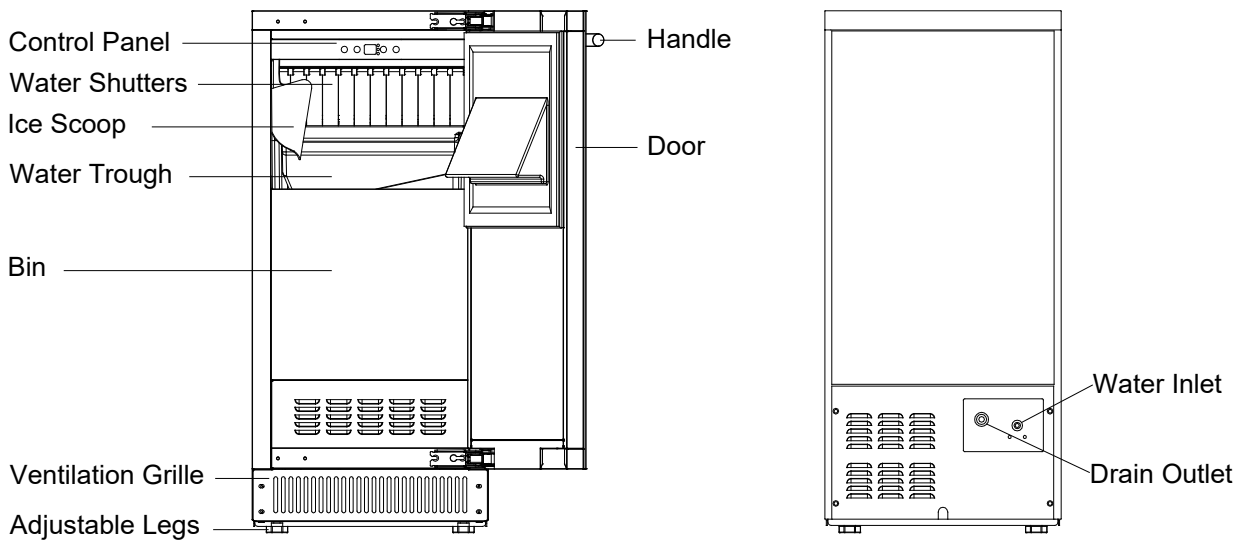

INSTALLATION INSTRUCTIONS

Before Using your Appliance

- Remove the exterior and interior packing.

CAUTION: *After unpacking you MUST allow this appliance to stand upright for at least 2 hours to allow the lubricant and refrigerant to drain back into the compressor and stabilize. Failure to do so may adversely affect performance and the lifetime of this unit.*

- Clean the interior surface with lukewarm water using a soft cloth.
- Install the handle on the door. (See Installing the Stainless Steel Handle.)
- Sanitize the ice machine. All ice machines are factory-operated and adjusted before shipment. Normally, new installations do not require any adjustment.

Installation of your Appliance

- The appliance is designed for built-in, recessed, or free-standing installation for indoor or outdoor use.

NOTE: Do not store or install the appliance outdoors for models with indoor use only.

- This ice machine should be properly installed by qualified personnel.

WARNING: *Flammable Refrigerant Used. Appliance should be installed in accordance with the Safety Standard for Refrigeration Systems, ANSI/ASHRAE 15.*

WARNING: *This appliance must be installed in accordance with all local codes and ordinances.*

- Place your appliance on a floor that is strong enough to support it when it is fully loaded. It is very important for the ice machine to be level in order to work properly. To level your unit, adjust the front adjustable legs at the bottom of the unit.
- For freestanding installation, 5 inches (127mm) of space between the back and sides of the unit are suggested, which allows the proper air circulation to cool the compressor and condenser for energy saving. At the same time replace the current four feet by four NSF recognized 6 inches height legs (The legs are not provided and can be purchased from our service center.) Even for built-in installation, it is a must to keep ¼" (5mm) space on each side and at the top to ensure proper service access and efficient ventilation. Take care that the air vent at the front of the appliance must never be covered or blocked in any way.
- Installation of the ice maker requires a cold water supply inlet of ¼-in. (6.35mm) soft copper tubing with a shut-off valve.

CAUTION: *Make sure that the socket and ON/OFF switch are easily accessible after the appliance has been installed.*

- Avoid locating the unit in moist areas.
- Plug the appliance into an exclusive, properly grounded wall outlet. Do not under any circumstances cut or remove the third (ground) prong from the power cord. Any questions concerning power and/or grounding should be directed toward a certified electrician or an authorized service center.

NOTE: It is recommended that you do not install the appliance near an oven, radiator, or other heating sources. Direct sunlight may affect the acrylic coating and heat sources may increase electrical consumption. Do not install in a location where the temperature will fall below 50°F (10°C). Extreme cold ambient temperatures may also cause the unit not to perform properly. For best performance, do not install the appliance behind a cabinet door or block the base grille.

- The appliance must be installed to all electrical, plumbing, water and drain connections in accordance with state and local codes.
- The equipment must be installed with adequate backflow protection to comply with applicable federal, state and local codes.
- *It is strongly recommended that a water filter be used.* A filter, if it is of the proper type, can remove taste and odors as well as particles. Some water is very hard, and softened water may result in white, mushy cubes that stick together. Deionized water is not recommended.

Built-in Under-counter Instructions

The product should be placed on a flat ground, make sure your installation does not block the front ventilation grille. And be sure the door will open and close properly in the chosen location. The base of the ice machine must be sealed to the floor to meet NSF standard. Food grade silastic sealant is recommended (The sealant is not provided and can be purchased from the service center.). Place a bead of the sealant between the floor and the outside edge of the product. The bead must fill the space between the product bottom edges and the floor. Or apply glass glue around the bottom of the product to seal to the floor, intended to prevent liquid spillage on adjacent surfaces of the floor or countertop from passing under inaccessible portions of the equipment.

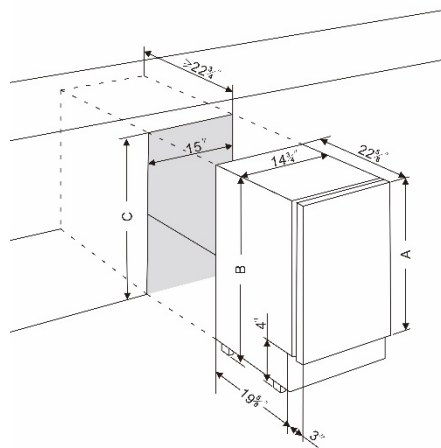

NOTE: When pushing the appliance into the niche, make sure that the main cable does not get trapped.

Models	A (Inch)	B (Inch)	C (Inch)
BIM62ADA / DBIM64CSS / BIM63OS / DBIM65CSS	28	32	32 1/4

CAUTION: To ensure the proper functioning of the appliance, air vents should never be blocked or covered.

Electrical Connection

Check that the voltage marked on the product corresponds with your supply voltage.



WARNING

Improper use of the grounded plug can result in the risk of electrical shock. If the power cord is damaged, have it replaced by a qualified electrician or an authorized service center.

This appliance should be properly grounded for your safety. The power cord of this appliance is

equipped with a three-prong plug which mates with standard three-prong wall outlets to minimize the possibility of electrical shock.

Do not under any circumstances cut or remove the third (grounded) prong from the power cord supplied. For personal safety, this appliance must be properly grounded. Any questions concerning power and/or grounding should be directed toward a certified electrician or an authorized service center.

This appliance requires a standard 115/120 Volt AC ~ 60Hz three-prong grounded electrical outlet. Have the wall outlet and circuit checked by a qualified electrician to make sure the outlet is properly grounded. When a standard 2-prong wall outlet is encountered, it is your responsibility and obligation to have it replaced with a properly grounded 3-prong wall outlet.

To prevent accidental injury, the cord should be secured behind the appliance and not left exposed or dangling.

The appliance should always be plugged into its own individual electrical outlet which has a voltage rating that matches the rating label on the appliance. This provides the best performance and also prevents overloading house wiring circuits that could cause a fire hazard from overheating. Never unplug the appliance by pulling on the power cord. Always grip the plug firmly and pull it straight out from the receptacle. Repair or replace immediately all power cords that have become frayed or otherwise damaged. Do not use a cord that shows cracks or abrasion damage along its length or at either end. When moving the appliance, be careful not to damage the power cord.

Extension Cord

Because of potential safety hazards under certain conditions, it is strongly recommended that you do not use an extension cord with this appliance. However, if you must use an extension cord, it is absolutely necessary that it be a UL/CUL-Listed, 3-wire grounding type appliance extension cord having a grounding type plug and outlet and that the electrical rating of the cord is 115 volts and at least 10 amperes.

Adjusting the Height of the Unit

The height of the ADA appliances can be increased by up to 3" by turning the adjustable legs. Once the desired height has been achieved, the gap between the kick-plate and the floor can be covered by lowering a hidden section of the kick-plate. See the next section for instructions.

Adjusting the Kick Plate

The pre-fitted kick-plate of the appliance includes an adjustable kick-plate section that is initially seated behind the upper section. In order to adjust the kick-plate height, follow the instructions below:

1. Remove the screws (1) from both the top left- and top right-hand sides of the kick-plate.
2. Loosen or remove the screws (2) from both the bottom left and bottom right-hand sides of the kick-plate. Failure to loosen the bottom screws sufficiently may cause damage to the lower trim when adjusting it.
3. Carefully guide the lower trim down until the desired height is achieved.
4. Reinsert screws and tighten them.

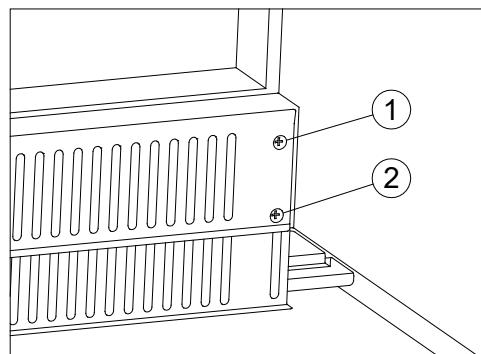

Installing a Stainless Steel Handle

This appliance includes a stainless steel handle that is not required to operate the unit. To install the handle, follow the instructions below:

Place the handle (1) over the mounting stub (3) of the door and using the supplied Allen key, tighten the securing grub screws (2) to affix the handle.

IMPORTANT: Do not overtighten the screws & do not use power tools to install the handle.

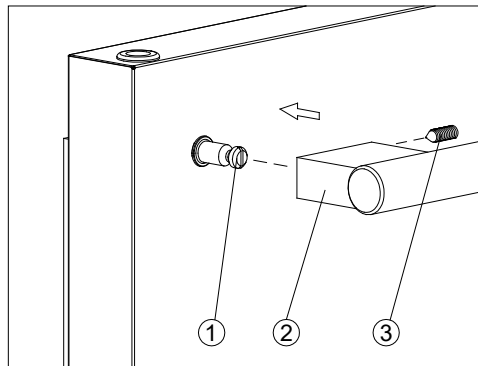

Reversing the Door Swing of your Appliance

This unit has the capability of the door opening from either the left or right side. The unit is delivered to you with the door opening from the left side. Should you desire to reverse the opening direction, please follow the reversal instructions shown below.

NOTE: All parts removed must be saved to allow the door swing to be reversed.

NOTE: Some variations of these items may only be reversible in Summit facilities before being shipped. Consult our website for more information.

Models BIM63OS / DBIM65CSS

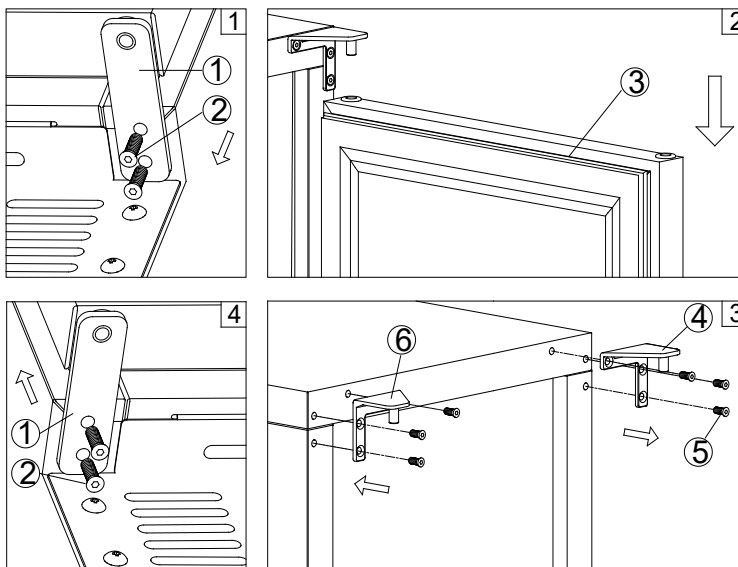

1. Remove the bottom hinge (1) by unscrewing the two lock screws (2). Be careful to hold the door firmly after removing the screws. (Fig. 1)
2. Gently pull down to remove the door (3) from the right top hinge and place it on a padded surface to avoid the risk of damage. Then remove the right top hinge (4). (Fig. 2 & 3)
3. Unscrew the cover caps on the left side of cabinet and use them to cover the screw holes on the right hand side.

4. Screw the alternative left top hinge (6), included in the fittings, on the left hand side of cabinet. (Fig. 3)
5. Relocate the door to the designated position. Then screw the bottom hinge assembly on the left designated position and tighten it after the door is leveled.

Models BIM62ADA / DBIM64CSS

⚠ WARNING

Use extreme caution with the articulated hinges. The hinge is self-closing, and many pinch points exist prior to built-in installation.

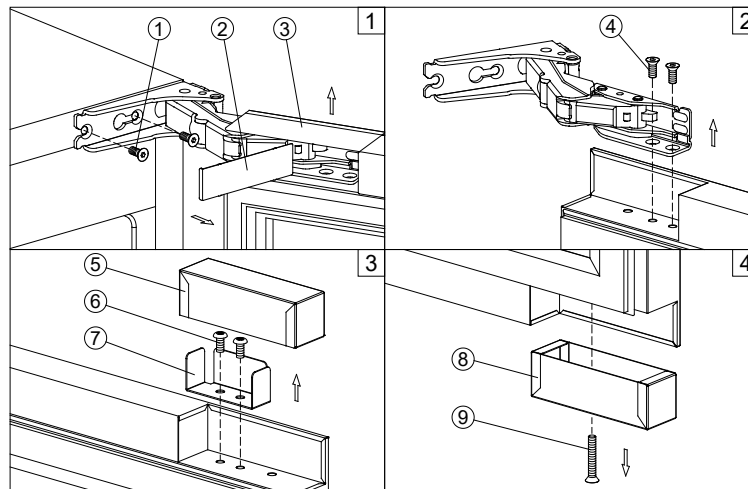

1. Pull the top decoration cover (3) upward and remove it. Remove the cover caps (2) and then remove the door by unscrewing the four screws (1). Be careful to hold the door firmly after removing the screws and place it on a padded surface to avoid the risk of damage. Leave the hinges open. (Figure 1)
2. Unscrew the four screws (4) to remove the top and bottom articulated hinges. (Figure 2)
3. Pop out the cover caps on the left side of the cabinet and use them to cover the screw holes on the right-hand side.
4. Pull the top decoration cover (5) upward and remove it. Unscrew the two screws (6) and transfer the retaining bracket (7) to the opposite side of the door. Refit the top decoration cover (5). (Figure 3)
5. Unscrew the screw (9) and transfer the bottom decoration cover (8) to the opposite side of the door. (Figure 4)
6. Refit the articulated hinges to the opposite side of the door by using the four screws (4). (Repeat step 2 in reverse.)
7. Refit the door to the opposite side. Then screw and tighten it after the door is leveled. (Repeat step 1 in reverse.)

Full Overlay Panel Installation Instructions for Models BIM62ADA / DBIM64CSS

These models are designed for field-installed overlay panel. The overlay panel covers the stainless steel to give a built-in appearance. The overlay panel and appropriate hardware are not included with the unit and the end user needs to prepare them themselves. Please follow the instructions below for installation:

Door Panel Preparation

Prepare the overlay panel to the dimensions shown below.

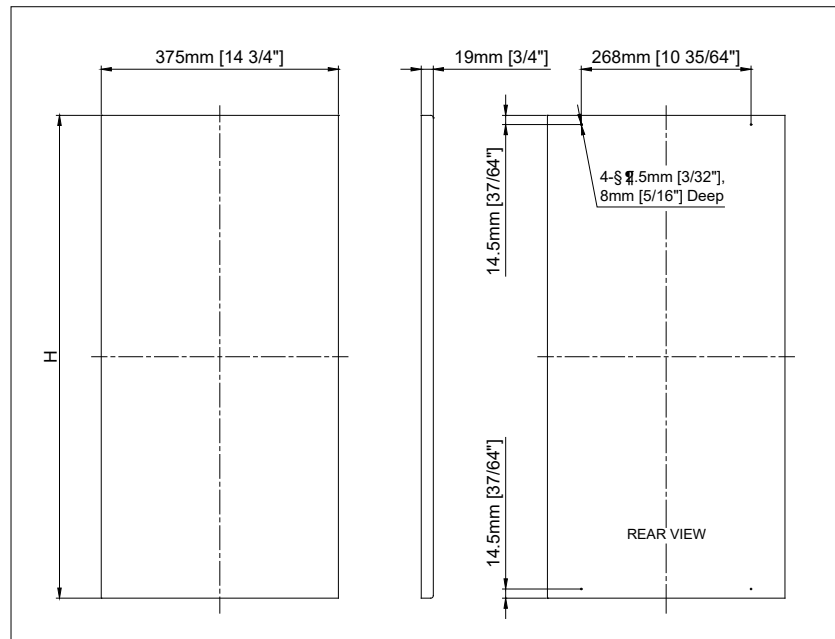

IMPORTANT:

1. H = Height of door + 1mm [3/80"].
2. Weight of the overlay panel should not exceed 22 lbs. (10 kg).
3. It is important to ensure that all drilled holes are drilled to the correct depth in order to avoid splits in the wood when hardware is installed.

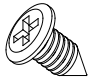
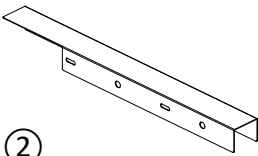
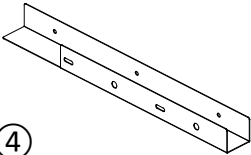
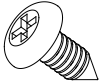
Included in the bracket kit			
 ①	 ②	 ④	 ⑤
Phillips self-tapping screw (6)	Bottom bracket (1)	Top brackets (1)	Phillips self-tapping screw (4)

Door Panel Installation

NOTE: This design will leave a 3mm gap between the panel and the unit door.

If you do not want the 3mm gap, you will have the option to route the wood according to the bracket's dimensions. Then proceed to install the bracket following the instructions below.

Installing the Handle on the Overlay Panel

If reusing the handle that came with the unit:

1. Unscrew the studs located on the front face of the door and set them aside for later use.
2. Remove the screws from the door and proceed to mark their positions on the overlay panel by using the handle as a guide.
3. Use a 3/16" (5mm) drill bit to make the holes on the overlay panel for the screws.
4. Insert the screws, making sure to leave the head of the screw flush with the surface of the panel (countersink screws if necessary).
5. Take the studs you saved in Step 1 and screw them back. They are now projecting from the face of the panel.
6. Place the handle over the mounting studs and, using the supplied Allen key, tighten the securing grub screws to fix the handle. Refer to **"Installing a Stainless Steel Handle"** (Refer to page 13).

If using a customer supplied handle(s):

1. Attach the handle to the overlay panel by using flat head or countersunk screws.
2. Unscrew the studs located on the front face of the door and save them for later possible use.

Installing the Bracket

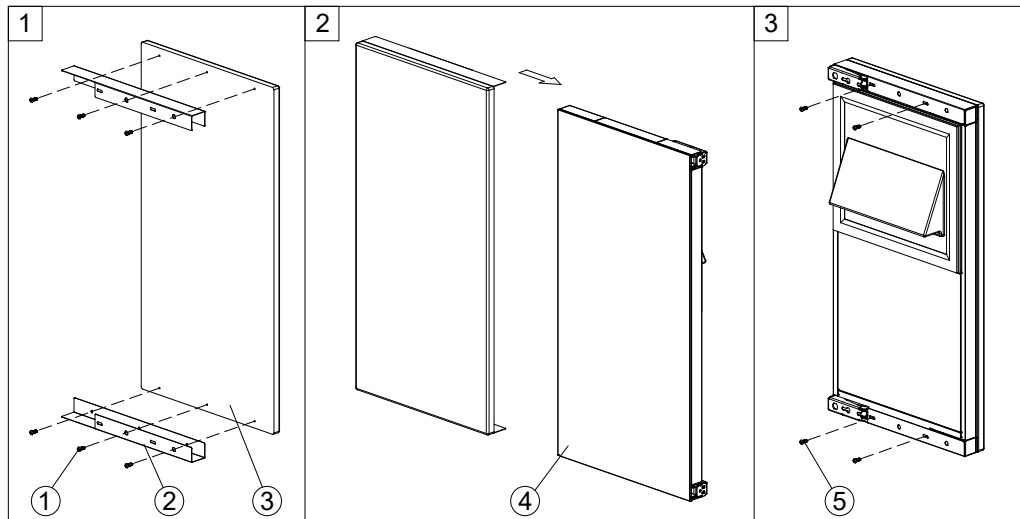

1. Lay the wooden panel (3) on a flat surface.
2. Place the bottom bracket (2) along the edge of the panel.
3. Attach the bracket (2) to the wooden panel by using three 1/2" Phillips self-tapping screws (1).
4. Repeat steps 2-3 for the top bracket.

NOTE: The two brackets must be horizontally spaced according to the specific dimensions of your unit's door.

5. We recommend you leave the factory-installed protective film to protect the door and prevent scratching while installing the panel.
6. Open the unit's door all the way. Then, carefully slide the bracketed wooden panel onto the unit's door (4).
7. Attach the bracket to the door by inserting four ½" Phillips self-tapping screws (5) through the bracket and into the unit's door, two on each end of the bracket.

Door Panel Installation Method 2:

This method will leave the panel flush with the door but will require some drilling into the unit's door.

1. Peel off the gasket (4) and remove the handle by removing the two screws that attach the handle to the door.
2. Drill the 6 holes shown by using a 3/16" drill bit inside the door groove on the four sides of the door front (2).
3. Cut the overlay panel (1) with a thickness of 3/4" to the dimensions corresponding to your model. The height of the panel should be 1mm [3/80"] more than the height of the door and the width of the panel should be 14 ¾" (375mm)
4. Attach the handle to the overlay panel by using the flat head screws and drive the screws flush with the panel.
5. Then attach the overlay panel to the door face using the 6 wood screws #10x1½ (ST4x38) (3) and through the 6 existing holes inside the door groove.
6. Reinstall the gasket.

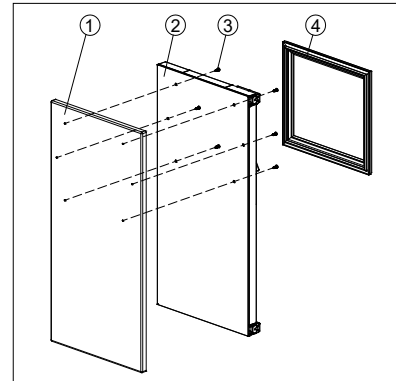

Water Supply and Drain Requirements

Prepare water supply line and drain before installation of your ice machine. Installation requires a 1/4" ID copper cold water line and compression fitting (not supplied).

The ice machine is supplied with an automatic drain pump system. The drain method requires routing to an open site drain. Do not connect directly to drain line as bacteria from drain line may contaminate the ice machine.

Make certain the hoses are not pinched or kinked or damaged during installation.

This appliance is intended to be permanently connected to the water mains and not connected by a hose-set.

Check for leaks after connection.

WATER INLET LINES



CAUTION

Copper tubing is recommended for the water supply line. Water supply tubing made of 1/4" plastic is not recommended since it greatly increases the potential for water leaks. Manufacturer will not be responsible for any damage if plastic tubing is used for the supply line.

Follow these guidelines to install water inlet lines:

- Do not connect the ice machine to a hot water supply. Be sure all hot water restrictors installed for other equipment are working. (Check valves on sink faucets, dishwashers, etc.)
- If water pressure exceeds the maximum recommended pressure (80 psig - 55 bar), obtain a water pressure regulator.
- Install a water shut-off valve for the ice making water lines.
- Insulate the water inlet line to prevent condensation.
- Install tubing only in areas where temperatures will remain above freezing.
- Leave a coil of copper tubing to allow the ice maker to be pulled out of the cabinet or away from the wall for service.

DRAIN CONNECTIONS (FACTORY SUPPLIED)

Follow these guidelines when installing drain lines to prevent drain water from flowing back into the ice machine and storage bin:

- Drain lines must have a 1.5-inch drop per 5 feet of run (2.5 cm per meter), and must not create traps.
- The floor drain must be large enough to accommodate drainage from all drains.
- Drain pump discharge line must terminate at an open site drain.
- The maximum length of drain hose is 6.5 feet (2 m).
- The maximum rise of drain hose is 5 feet (1.5 m).
- Pour 3000ml of water into the ice storage bin to check for leaks in the drainage system.

WATER SUPPLY AND DRAIN LINE SIZING/CONNECTIONS



CAUTION

Plumbing must conform to state and local codes.

Location	Water Temperature	Water Pressure	Ice Machine Fitting	Tubing Size Up to Ice Machine Fitting
Ice Making Water Inlet	41°F(5°C) Min. 90°F(32°C) Max.	20 psig (138 kPa) Min. 80 psig (552 kPa) Max.	1/4" (.64 cm) ID Copper Tubing	1/4" (.64 cm) minimum inside diameter

NOTE: If air temperature is less than 60°F (15.5°C), water temperature must be equal to or greater than 50°F (10°C).

Installation Procedure

1. Prepare the site by following the instructions under Electrical Connection and Water Supply and Drain Requirements.
2. Remove ice machine from carton.
3. Inspect for damage.
4. Remove literature packet and drain hose from inside the ice machine.
5. Adjust leg levelers.
6. Reverse door if desired. See Reversing the Door Hinge.
7. Install drain hose to drain on back of ice machine and route to open site drain.
8. Use compression fitting to connect the Water Inlet on back of ice machine to the prepared 1/4" ID cold water line.
9. Open the shut-off valve on the water line.
10. Connect electrical plug to grounded (three-prong), polarized outlet.
11. Place ice machine back in position and check leveling again. Make any necessary adjustments.
12. Prepare sanitizer solution and sanitize the ice machine according to Cleaning/Sanitizing the Ice Making System.
13. At initial start-up, ice machine will need approximately 45 minutes to freeze.

Installation Check List

- Is the Ice Machine level?
- Has all of the packing been removed?
- Have all of the electrical and water connections been made?
- Has the supply voltage been tested and checked against the rating on the nameplate?
- Is there proper clearance around the ice machine for air circulation?
- Has the ice machine been installed where ambient temperatures will remain in the range of 50° - 110°F (10° - 43°C)?
- Has the ice machine been installed where the incoming water temperature will remain in the range of 41° - 90°F (5° - 32°C)?
- Has the water supply pressure been checked to ensure a minimum of 20 psig with a static pressure not to exceed 80 psig?
- Is the ice machine drain line routed to an open site drain?
- Are all electrical leads free from contact with refrigeration lines and moving equipment?
- Has the ice machine and bin been sanitized?
- Is the ice machine plugged into a properly grounded, polarized receptacle?
- Have the water and drain connections been examined for leaks?

OPERATING YOUR APPLIANCE

The ice machine is factory-operated and adjusted before shipment. Normally, new installation does not require any adjustment.

Turn on the water tap, then plug the machine or touch the POWER key to turn on. The ice machine will start working automatically.

After 3 minutes, the ice machine will automatically go to the freeze cycle, and the sound of water flowing will be heard.



This appliance is designed for operation at certain ambient temperatures. The climatic class is specified on the rating plate.

Test room climatic class	Dry bulb temperature °C	Relative humidity %	Dew point °C	Water vapor mass in dry air g/kg
0	20	50	9.3	7.3
1	16	80	12.6	9.1
2	22	65	15.2	10.8
3	25	60	16.7	12.0
4	30	55	20.0	14.8
5	40	40	23.9	18.8
6	27	70	21.1	15.8
7	35	70	30.0	27.3
8	24	55	14.4	10.2

Control Panel



Power

To turn the appliance off, touch and hold the  key for 5 seconds. To turn the appliance on, press and hold the  key for 1 second.

NOTE: Touching the  key once can switch off the audible alarm when the alarm is on.

Clean

In stand-by mode touching the CLEAN key will initiate a clean cycle. The display will show "CL". The background light of CLEAN key will flash after 180 days of use to indicate it is time to clean the machine. It will remain flashing until the clean cycle is operated once or touching and holding the CLEAN key for 5 seconds to cancel the clean cycle.

IMPORTANT: CLEAN mode only can be activated in stand-by mode. Turning the unit off and then turning the unit on can enter the stand-by mode.

Mode

Touching the MODE key toggles between 2 operation cycles: ice making cycle (default) and

harvest cycle.

Touching the MODE key once will initiate an ice making cycle. The display will show "I".

Touching the MODE key again will initiate a harvest cycle. The display will show "HE".

Delay Start ⌚

Touching the DELAY START key will initiate a delay cycle. The ice machine will not run until the delay time expires. The defaulted delay time is 3 hours. Pressing the CLEAN key to select the delay period from 1 hour to 10 hours and touching the DELAY START again to confirm the period. You can cancel the DELAY START operation by touching and holding the DELAY START key for 5 seconds.

Display

Display the working status.

-- means that the machine is working in the stand-by mode.

I means that the machine is working in the ice making cycle.

CL means that the machine is working in the cleaning cycle.

HE means that the machine is working in the harvest cycle.

FU means that the ice storage bin is full.

NOTES:

- If the unit is unplugged, power lost, or turned off, you must wait 3 to 5 minutes before restarting the unit. If you attempt to restart before this time delay, the unit will not start.
- Although the machine has been tested and cleaned at the factory, due to long-term transit and storage, the first batch of cubes must be discarded.
- Never turn the water supply tap off when the ice machine is working.
- Never touch evaporator when unit is running.

Sequence of Operation

Depending on ambient conditions and cold water supply temperature, the ice making process will take approximately 30 minutes.

1. Initial Start-Up – Water Fill

Before the compressor starts after the water tap is turned on, the water inlet valve will energize and the water will fill in the water trough automatically.

2. Refrigeration System Start-Up

The compressor starts after the Water Fill cycle and remains on throughout the Freeze and Harvest cycles. The condenser fan motor starts and runs throughout the Freeze cycle.

3. Freeze

The water pump sprays water into the evaporator surface. The water freezes layer by layer, until an ice cube forms in each bucket. During the freeze cycle, fresh water enters into the water trough continuously as the water in the trough freezes continuously in the evaporator. The control system will adjust the length of the Freeze cycle to conditions.

4. Harvest



The water pump shuts off and the compressor continues to run. The evaporator is warmed, allowing the cubes to release from the evaporator and drop into the storage bin. The control system will adjust the length of the Harvest cycle to condition and regulate whether the condenser fan will run. At the end of the Harvest cycle, the ice machine will start another Freeze cycle.

5. Automatic Shut-Off

The level of ice in the storage bin controls the ice machine shut-off. When the bin is full, ice will contact the bin thermistor holder. The bin thermistor cools, which stops the ice machine.

The ice machine remains off until ice no longer contacts the bin thermistor holder and the thermistor warms up. The increase in temperature will restart the ice machine.

Ice Cube Size Selection

Touching and holding the CLEAN key, touch and release the DELAY START key to select the size of ice cubes. The ice size toggles between 3 sizes of ice: Medium (default) , Small  and Large .

When the Medium size is selected, the indicator  will be ON. When the Small size is selected, the indicator  will be ON. When the Large size is selected, the indicator  will be ON.

Mode Memory Function

In the event of a power interruption (power surge, breaker switch, etc.), the unit can remember the previous mode settings, and when the power is recovery, the ice machine will go back the same setting as power off.

Sabbath Mode

Sabbath mode is available for the observance of certain religious holidays. This mode turns off the displays, interior light and audible alarms and prevents them from turning on again. Normal ice making will still take place.

To initiate Sabbath mode, press the **MODE** and **DELAY START** keys at the same time for at least 5 seconds. The unit will beep two times and the displays will go out to confirm the Sabbath mode is ON.

Sabbath mode can be canceled by repeating the above process. The Sabbath Mode will automatically turn off after 96 hours.

Cleaning Alarm

The background light of **CLEAN** key will flash after 180 days of use to indicate it is time to clean the machine. It will remain flashing until the clean cycle is operated once or touching and holding the **CLEAN** key for 5 seconds to reset the counter. After that the light will stop flashing.

Operating Noises

The unit is cooled by a compressor (refrigeration aggregate). The compressor pumps coolant through the cooling system, producing operating noise. Even when the compressor cuts out, noises caused by changes in temperature and pressure are unavoidable. Operating noise will be most audible immediately after the compressor cuts in.

The following noises are normal:

- Gurgling sound, caused by the refrigerant flowing through the appliance's coils,
- Humming noise made by the motor compressor.
- Cracking/popping sounds, resulting from the materials contraction and expansion due to temperature variations,
- Condenser fan operating sound, to force air through the condenser.
- Water running from the evaporator to the water trough may make a splashing sound.
- During the harvest cycle, you may hear the sound of ice cubes falling into the ice chute and ice storage bin.
- The buzzing sound when the water valve opens to fill the water trough.
- The water drainage sound from the drain pump.

Unusual noise is normally the result of improper installation. Under no circumstances must tubing come into contact with a wall, other furniture or with other tubing.

Where the unit is installed in open-plan kitchen or in partition walls, the level of operating noise will be heard more acutely. However, this is due to the surrounding architecture and not to the unit.

An individual's perception of noise is directly linked to the environment in which the unit is located, as well the specific type of models. Our appliances are in line with international standards for such appliance and in line with the latest technical developments. But please remember that the noise of the compressor and the coolant circulating in the system is unavoidable.

CARE AND MAINTENANCE



WARNING

- To avoid possible injury due to electric shock, disconnect the power cord or turn off power at the circuit breaker panel or fuse box and shut off the water line before cleaning the appliance.
- Clean only the parts of the appliance listed in this manual. Clean them only in the manner specified.
- Do not use a steam cleaner to clean this appliance. Steam could penetrate the electrical components and cause a short circuit.
- Do not allow water or cleaning fluids to penetrate into the electrical components or ventilation grill.
- Use only the types of cleaning solutions specified in this manual. NEVER clean appliance parts with flammable fluids.
- Do not use abrasives such as steel wool, scouring pads, rough sponges or scrub brushes.

General

Basic hygiene and maintenance of your Ice Machine, will increase its reliability, increase performance, and help save on water and power consumption. Ice production will be maintained and unwanted repairs due to maintenance issues will be minimized.



CAUTION

If the ice machine is left unused after prolonged shutdown, before the next use it must be thoroughly cleaned. Follow carefully any instructions provided for cleaning or use of sanitizing solutions. Do not leave any solution inside the ice machine after cleaning.

The following minimum maintenance procedures are recommended in order to ensure reliable, trouble-free operation and maximum ice production. If the ice machine requires more frequent cleaning and sanitizing, consult a qualified service company to test the water quality and recommend appropriate water treatment. An extremely dirty ice machine must be taken apart for cleaning and sanitizing.

- Clean cabinet exterior: Weekly, at start-up and after prolonged shutdown
- Clean/sanitize ice bin: Semi Annual, at start-up and after prolonged shutdown
- Clean/sanitize the ice making system: Semi Annual, at start-up and after prolonged shutdown
- Full cleaning and sanitizing: Annual.



WARNING

If you do not understand the procedures or the safety precautions that must be followed, call your local service representative to perform the maintenance procedures for you.

Cleaning the Cabinet Exterior

Clean the outside cabinet of the ice machine as often as necessary to maintain cleanliness. Wash it with warm water and mild liquid detergent. Rinse well and wipe dry with a clean soft cloth.

Do not clean the stainless steel with steel wool pads. Suggest to using an all-in-one stainless steel cleaner to clean the stainless steel and always clean in the direction of grain.

Cleaning the Interior

The ice storage bin should be sanitized occasionally. Clean the water trough before the ice machine is used first time and reused after prolonged shutdown. It is usually convenient to sanitize the trough after the ice making system has been cleaned, and the ice storage bin is empty.

1. Disconnect the power to the unit.
2. Open the door. With a clean cloth, wipe down the interior of unit with a sanitizing solution made of 1 ounce of household bleach or chlorine and 2 gallons of hot (95°F – 115°F) water.
3. Rinse thoroughly with clear water.
4. Reconnect power to the unit.
5. The ice scoop should be washed regularly. Wash it just like any other food container.

Cleaning/Sanitizing the Ice Making System

Minerals that are removed from the water during the freezing cycle will eventually form a hard, scaly deposit in the water system. Cleaning the system regularly helps remove the mineral scale buildup. How often to clean the system depends upon how hard your water is or how effective your filtration may be. With hard water of 15 to 20 grains/gal. (4 to 5 grains/ liter), you may need to clean the system as often as once every 6 months.

Use ice machine cleaner to remove lime scale or other mineral deposits. Ice machine sanitizer disinfects and removes algae and slime.

Make sure that all the ice is off the evaporator. If ice is being formed, wait until the cycle is completed, then press and hold the POWER key for 5 seconds to switch off the unit.

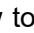
1. Remove all ice from the storage bin.
2. Keep the ice machine connected to the water supply. Add 8 oz. of Nickel-Safe Ice Maker Cleaner Solution into the water trough by lifting the water shutters and pouring directly into the spray area. Press the POWER key to switch on the unit and then press the CLEAN key to initiate the clean cycle. The display window will show “ ” and the ice machine will run in the CLEAN mode automatically. This entire cycle lasts approximately 30 minutes.
3. The “ ” will flash in the display window to indicate the CLEAN cycle is complete. After cleaning, drain off the waste water inside the water trough to a convenient container by removing the overflow tube.

NOTE: Don't drain off the waste water to the inside of the cabinet.

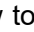
4. Replace the overflow tube securely on the water trough. If the overflow tube is loose, water will empty from the water trough and you will have either thin ice or no ice.
5. Repeat steps 2, 3 and 4 (without Ice Maker Cleaning Solution) once to rinse the ice making system thoroughly.
6. Add 1 oz. of undiluted Ice Machine Sanitizer into the water trough by lifting the water shutters and pouring directly into the spray area. Then press the CLEAN key, initiating the clean cycle. The display window will show “ ” and the ice machine will run in the CLEAN mode automatically. This entire cycle lasts approximately 30 minutes.
7. The “ ” will flash in the display window to indicate the CLEAN cycle is complete. After cleaning, drain off the waste water inside the water trough to a convenient container.

NOTE: Don't drain off the waste water to the inside of the cabinet and remember to replace the overflow tube securely.

8. Prepare a sanitizing solution made of 1 ounce of Ice Machine sanitizer and 2 gallons of hot water (95° to 115°F). Use a spray bottle, sponge or cloth to sanitize the bin. Allow the solution to be in contact for at least 3 minutes, then dry.
9. Repeat steps 2, 3 and 4 (without Ice Maker Cleaning Solution and Sanitizer) three times to rinse the ice making system thoroughly.

10. Press and hold the POWER key for 5 seconds to switch off the unit to finish the above process. Then press the POWER key to switch on the unit and press the ICE key, the machine will return to the regular ice making mode. Discard the first batch of ice.



WARNING

- The ice machine cleaner contains acids. Use rubber gloves to protect hands. Carefully read the material safety instructions on the container of the ice machine cleaner and sanitizer.
- DO NOT use or mix with any other solvent-based cleaner products.
- Discard the first batch of ice produced after cleaning.

Full Cleaning/Sanitizing Procedure

Ice machine cleaner is used to remove lime scale and other mineral deposits. Ice machine sanitizer disinfects and removes algae and slime.

NOTE: All ice must be removed from the bin.

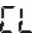
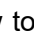
1. Remove all ice from the storage bin.
2. Keep the ice machine connected to the water supply. Add 8 oz. of Nickel-Safe Ice Maker Cleaner Solution into the water trough by lifting the water shutters and pouring directly into the spray area. Press the POWER key to switch on the unit and then press the CLEAN key to initiate the clean cycle. The display window will show “ ” and the ice machine will run in the CLEAN mode automatically. This entire cycle lasts approximately 30 minutes.
3. The “ ” will flash in the display window to indicate the CLEAN cycle is complete. After cleaning, drain off the waste water inside the water trough to a convenient container by removing the overflow tube.

NOTE: Don't drain off the waste water to the inside of the cabinet.

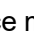
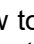
4. When the cleaning process stops, disconnect power and remove all parts as described in Removal of Parts for Cleaning and Sanitizing.
5. Take all removed components to a sink for cleaning. Use 1/2 of the cleaner/water mixture to clean all components. The cleaner solution will foam when it contacts lime scale and mineral deposits. Once the foaming stops, use a soft-bristle nylon brush, sponge or cloth (NOT a wire brush) to carefully clean the parts. Disassemble the spray bar (remove the left and right silicone plugs), remove nozzles and soak for 5 minutes. For heavily scaled parts, soak in solution for 15~20 minutes. Rinse all components with clean water.
6. While components are soaking, use the other 1/2 of the cleaner/water solution and a nylon brush or cloth to clean inside of ice bin. Clean inside of door, door gasket, bin, top of evaporator and evaporator bucket. Rinse all areas thoroughly with clean water.
7. Use 1/2 of the sanitizer/water mixture to sanitize all removed components. Use a cloth or sponge to liberally apply the solution to all surfaces of the removed parts or soak the removed parts in the sanitizer/solution.
8. Use the other 1/2 of the sanitizer/water solution and a sponge or cloth to sanitize the inside of ice bin. Sanitize inside of door, door gasket, bin, top of evaporator and evaporator bucket.
9. Replace all removed components.
10. Add 1 oz. of undiluted Ice Machine Sanitizer into the water trough by lifting the water shutters and pouring directly into the spray area. Then press the CLEAN key, initiating the clean cycle. The display window will show “ ” and the ice machine will run in the CLEAN mode automatically. This entire cycle lasts approximately 30 minutes.
11. The “ ” will flash in the display window to indicate the CLEAN cycle is complete. After cleaning, drain off the waste water inside the water trough to a convenient container.
11. NOTE: Don't drain off the waste water to the inside of the cabinet and remember to replace the overflow tube securely.
12. Repeat steps 10 and 11 (without Ice Maker Cleaning Solution and Sanitizer) three times to rinse the ice making system thoroughly.

13. Press and hold the POWER key for 5 seconds to switch off the unit to finish the above process. Then press the POWER key to switch on the unit and press the ICE key, the machine will return to the regular ice making mode. Discard the first batch of ice.

Removal of Parts for Cleaning/Sanitizing



WARNING

- Disconnect the electrical power to the ice machine and turn off the water supply before proceeding.
- The removal and replacement of parts must be carried out by the authorized or qualified service technician.

1. Turn off the electrical and water supply to the ice machine.
2. Remove all ice from the storage bin.
3. Remove the components that must be cleaned and sanitized as the following removal procedures for these parts.
4. Soak the removed part(s) in a properly mixed solution of cleaner.
5. The cleaner will foam. Once the foaming stops use a soft-bristle nylon brush, sponge or cloth (NOT a wire brush) to carefully clean the parts.
6. Thoroughly rinse all the parts with clean water.
7. Soak the removed parts in a properly mixed solution of sanitizer for 5 minutes.
8. Use a soft-bristle nylon brush, sponge or cloth (NOT a wire brush) to carefully sanitize the parts.
9. Use the sanitizing solution and a sponge or cloth to sanitize (wipe) the interior of the ice machine and bin.
10. Install the removed parts.
11. Turn on the water and electrical supply.

Water Shutter and Ice Chute

Open the door and remove the two screws (1) on the front side. Then you can pull and remove the water shutter assembly (2) and then lift to remove the ice chute (3).

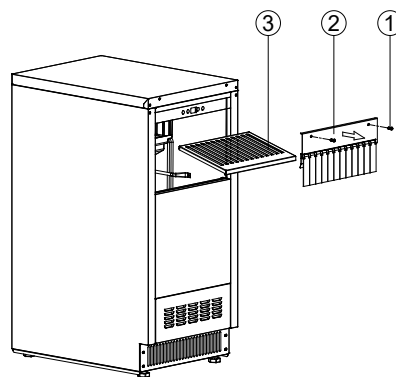

Spray Bar and Overflow Tube

Disconnect the water hose (3) from the spray bar assembly (2). Grasp two ends of the spray bar, lift up and remove from seat formed in water trough. Gently pull out the two silicone plugs (1) and then you can clean nozzle frame and the gap of nozzle. Nozzles are not suggested to be removed for cleaning.

Gently lift the overflow tube (4) inside the water trough and clean it. Make sure to replace the overflow tube in the correct position after cleaning, otherwise, draining will not stop, with the product rendered unable to make ice.

Gently pull to remove the filter screen (5) inside the water trough and clean it.

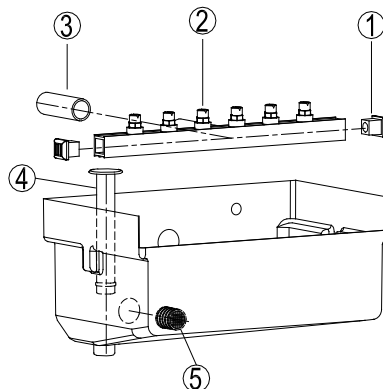

Top and Evaporator Cover

! WARNING

- Disconnect the electrical power to the ice machine and turn off the water supply before proceeding.
- All the following servicing should be referred to a qualified technician.

Remove the door.

Slide down to remove the rear cover (2) by unscrewing the four screws (1).

Slide down to remove the rear panel (4) by unscrewing the two screws (3).

Remove the top cover (7) by unscrewing the two screws (6). Now you can remove the evaporator cover (5).

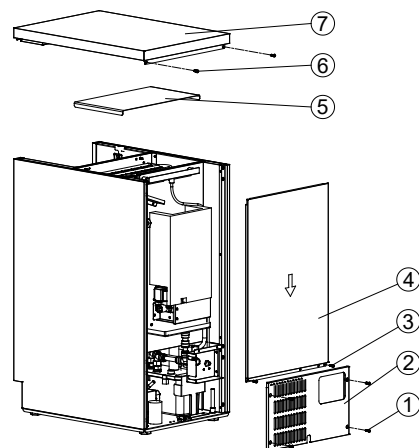

Preventing Stainless Steel Rust

Use non-abrasive tools to clean stainless steel products. Soft cloths and plastic scouring pads will not harm the steel's passive layer.

Clean with polish lines. Some stainless steels have visible polishing lines or “grain”. When visible lines are present, always scrub in a motion parallel to the lines. When the grain cannot be seen, polish in a consistent straight pattern and not in a circular motion.

Use alkaline, alkaline chlorinated or non-chloride containing cleaners. While many traditional cleaners are loaded with chlorides, the industry is providing an ever-increasing choice of non-chloride cleaners. If you are not sure of chloride content in the cleaner being used, contact your cleaner supplier. If your present cleaner contains chlorides, ask your supplier for an alternative. Avoid cleaners containing quaternary salt; it also can attack stainless steel and cause pitting and rusting.

Keep food equipment clean. Use alkaline, alkaline chlorinated or non-chloride cleaners at recommended strength. Clean frequently to avoid build-up of hard, stubborn stains. The single most likely cause of damage is chlorides in the water. Remember, adding heat to cleaners that contain chlorides dramatically increases their effect on stainless steel.

If chlorinated cleaners are used, immediately rinse and wipe equipment and supplies dry. The sooner you wipe standing water, especially when it contains cleaning agents, the better. After wiping equipment down, allow it to air dry. Oxygen helps maintain the stainless steel passive film.

Power Failure

In the event of a power interruption, all previous settings are automatically memorized. If power is interrupted (power surge, breaker switch, etc.) and then powered up again, the unit will operate with the last temperature set-point.

Vacation Time

Short holidays: Leave the unit in operation for holidays of less than three weeks.

Long absences: If the appliance will not be used for several months, or is to be moved to another place, exposed to ambient temperatures of 32°F (0°C) or below, please follow up the below instructions:



CAUTION

If water is allowed to remain in the ice machine in freezing temperatures, severe damage to some components could result. Damage of this nature is not covered by the warranty.

1. Perform a cleaning and sanitizing procedure to prevent mildew growth.
2. Disconnect the electric supply at the main electrical power source.
3. Turn off the water supply.
4. Disconnect and drain the incoming ice-making water line at the rear of the ice machine.
5. Remove any remaining ice and water from the storage bin and dry the bin.
6. Drain off all water in the water trough.
7. Make sure water is not trapped in any of the water or drain lines. Compressed air can be used to blow out the lines.
8. Use a spray bottle and a solution of sanitizer/water (0.50 oz/1 gal) and spray all interior surfaces.
Do not rinse, allow to air dry.
9. Leave the door partially open to allow for circulation and prevent mold or mildew growth.

Moving Your Appliance

Unplug the power plug from the electrical outlet. Disconnect the water line.

Remove the ice from the bin and drain off the water. Then fix all moving parts.

Raise the adjustable legs up to the base to avoid damage.

Tape the door shut.

Transport the machine only in the upright position. Also protect the outside of the appliance with a blanket or similar item.

Energy Saving Tips

Should the unit be left empty for long periods of time, it is suggested that the appliance is unplugged, and after careful cleaning, leave the door ajar to allow air to circulate inside the cabinet in order to avoid possible condensation, mold or odors forming.

The machine should be installed in the coolest area of the room, away from heat producing appliances, and out of the direct sunlight.

Ensure that the unit is adequately ventilated. Never cover air vents. Clean dust and dirt from the condenser at regular intervals.

Only open the door for as long as necessary and for as short a time as possible.

TROUBLESHOOTING

You can solve many common problems easily, saving you the cost of a possible service call. Try the suggestions below to see if you can solve the problem before calling the servicer.

PROBLEM	POSSIBLE CAUSE	REMEDY
<i>Ice machine will not run</i>	<ul style="list-style-type: none"> • <i>Appliance is not connected to a power supply.</i> • <i>The appliance is turned off.</i> • <i>The circuit breaker tripped or a blown fuse.</i> • <i>The ice storage bin is full of ice.</i> 	<ul style="list-style-type: none"> • <i>Connect the appliance.</i> • <i>Switch on the appliance.</i> • <i>Switch on circuit breaker or replace fuse.</i> • <i>Remove some ice cubes. Be sure the bin thermistor holder is free of ice.</i>
<i>Ice machine runs and no ice is produced</i>	<ul style="list-style-type: none"> • <i>No water to ice machine or too little water inside the water trough or Ice cubes are stuck on the vaporizer.</i> • <i>Incorrect incoming water pressure.</i> • <i>Spray nozzles blocked with mineral buildup.</i> • <i>Ambient temperature is too high or low.</i> • <i>Refrigerating system failure.</i> 	<ul style="list-style-type: none"> • <i>Correct water supply.</i> • <i>Water pressure must be 20-80 psi (1.4 bar - 5.5 bar).</i> • <i>Clean and sanitize the ice machine.</i> • <i>Ambient temperature must be between 50° F and 110°F (10°C and 43 °C).</i> • <i>Call for service.</i>
<i>Freeze cycle is long - Low ice production</i>	<ul style="list-style-type: none"> • <i>Water temperature is too high.</i> • <i>Dirty condenser.</i> • <i>High air temperature entering condenser.</i> • <i>Water inlet filter screen is dirty.</i> • <i>Water inlet valve is not working.</i> • <i>Refrigeration problem.</i> 	<ul style="list-style-type: none"> • <i>Connect to a cold water supply, verify check valves in faucets and other equipment are functioning correctly.</i> • <i>Clean condenser.</i> • <i>Air temperature must not exceed 110°F (43°C).</i> • <i>Remove the water inlet and clean the filter screen.</i> • <i>Water inlet valve must be replaced, call for service.</i> • <i>Call for service.</i>
<i>Ice quality is poor - cubes are shallow, incomplete or white.</i>	<ul style="list-style-type: none"> • <i>Ice machine is dirty.</i> • <i>Poor incoming water quality.</i> • <i>Water inlet filter screen is dirty.</i> • <i>Water is not accurately sprayed from the nozzle to the center of the evaporator buckets.</i> 	<ul style="list-style-type: none"> • <i>Clean and sanitize the ice machine.</i> • <i>Contact a qualified service company to test the quality of the incoming water and make appropriate filter recommendations.</i> • <i>Remove the water inlet and clean the filter screen.</i> • <i>Clean the ice machine - the nozzle may be clogged with a foreign object.</i>
<i>The water doesn't feed in after the machine starts.</i>	<ul style="list-style-type: none"> • <i>The water supply tap is turned off.</i> • <i>The water supply pipe is not properly connected.</i> 	<ul style="list-style-type: none"> • <i>Turn on the water supply tap.</i> • <i>Reconnect the water supply pipe.</i>
<i>Water leaks from the ice</i>	<ul style="list-style-type: none"> • <i>The drain hole below the ice storage bin is blocked.</i> 	<ul style="list-style-type: none"> • <i>Remove the ices and clean the drainhole.</i>

storage bin	<ul style="list-style-type: none"> The drain hose is kinked or improperly placed higher than the floor of the ice storage bin. 	<ul style="list-style-type: none"> Check the drain hose to be sure water can be drained out unhindered.
Vibrations.	<ul style="list-style-type: none"> The appliance is not properly level. 	<ul style="list-style-type: none"> Level the appliance with the adjustable feet.
The appliance seems to make too much noise.	<p>The rattling noise may come from the flow of the refrigerant, which is normal. As each cycle ends, you may hear gurgling sounds caused by the flow of refrigerant in your appliance.</p> <p>During the freeze cycle, you may hear the sound of water flow, which is normal.</p> <p>During the harvest cycle, you may hear the sound of ice cubes falling into the ice chute and ice storage bin, which is normal.</p> <ul style="list-style-type: none"> The appliance is not properly level. Is there ice between the ice chute and the water shutter? 	<ul style="list-style-type: none"> Level the appliance with the adjustable feet and remove some ice.
The door will not close properly.	<ul style="list-style-type: none"> The appliance is not properly level. The door was reversed and not properly installed. The gasket is dirty. 	<ul style="list-style-type: none"> Level the appliance with the adjustable feet. Check the door hinge and reassemble correctly. Clean the door gasket.
Display "E0", "E1", "E2", "E3", "E4", "E5", "E6", "E7", "E8" or "HP".	<ul style="list-style-type: none"> "E0" indicates communication error. "E1" or "E2" indicates that the ambient air temperature sensor is failed. "E3" or "E4" indicates that the sensor in the suction pipe is failed. "E5" or "E6" indicates that the sensor in the bin thermistor holder is failed. "E7" indicates the drainage failure. "E8" indicates the water inlet failure. "HP" indicates the high pressure protection. 	<ul style="list-style-type: none"> Try resetting the controls by disconnecting power to the unit for 5 minutes, then reconnect. If error code returns, problem cannot be resolved by user. Call for service.

If you have checked the information above and you still need help with your appliance, call our Customer Service facility at **800-932-4267** (Ext. **513**) between 9:00 AM and 5:00 PM ET or visit our website **summitappliance.com/support** at any time. We will do our best to answer your questions.

NOTES

CALIFORNIA CARB/SNAP DISCLOSURE

This product uses eco-friendly hydrocarbon refrigerant and fully complies with California CARB regulations.

However, we are required by California Law to provide the following disclosure statement in every product sold in California.

"This equipment is prohibited from use in California with any refrigerants on the 'List of Prohibited Substances' for that specific end-use, in accordance with California Code of Regulations, title 17, section 95374. This disclosure statement has been reviewed and approved by Felix Storch, Inc. and Felix Storch, Inc. attests, under penalty of perjury, that these statements are true and accurate."

This product does **not** use any refrigerants on the 'List of Prohibited Substances'"

LIMITED WARRANTY

ONE-YEAR LIMITED WARRANTY

Within the 48 contiguous United States, for one year from the date of purchase, when this appliance is operated and maintained according to instructions attached to or furnished with the product, warrantor will pay for factory-specified parts and repair labor to correct defects in materials or workmanship. Service must be provided by a designated service company. Outside the 48 states, all parts are warranted for one year from manufacturing defects. Plastic parts, shelves and cabinets are warranted to be manufactured to commercially acceptable standards, and are not covered from damage during handling or breakage.

5-YEAR COMPRESSOR WARRANTY

1. The compressor is covered for 5 years.
2. Replacement does not include labor.

ITEMS WARRANTOR WILL NOT PAY FOR:

1. Service calls to correct the installation of your appliance, to instruct you how to use your appliance, to replace or repair fuses or to correct wiring or plumbing.
2. Service calls to repair or replace appliance light bulbs or broken shelves. Consumable parts (such as filters) are excluded from warranty coverage.
3. Damage resulting from accident, alteration, misuse, abuse, fire, flood, acts of God, improper installation, installation not in accordance with electrical or plumbing codes, or use of products not approved by warrantor.
4. Replacement parts or repair labor costs for units operated outside the United States.
5. Repairs to parts or systems resulting from unauthorized modifications made to the appliance.
6. The removal and reinstallation of your appliance if it is installed in an inaccessible location or is not installed in accordance with published installation instructions.

DISCLAIMER OF IMPLIED WARRANTIES; LIMITATION OF REMEDIES

CUSTOMER'S SOLE AND EXCLUSIVE REMEDY UNDER THIS LIMITED WARRANTY SHALL BE PRODUCT REPAIR AS PROVIDED HEREIN. IMPLIED WARRANTIES, INCLUDING WARRANTIES OF MERCHANTABILITY OR FITNESS FOR A PARTICULAR PURPOSE, ARE LIMITED TO ONE YEAR. WARRANTOR SHALL NOT BE LIABLE FOR INCIDENTAL OR CONSEQUENTIAL DAMAGES. SOME STATES DO NOT ALLOW THE EXCLUSION OR LIMITATION OF INCIDENTAL OR CONSEQUENTIAL DAMAGES, OR LIMITATIONS ON THE DURATION OF IMPLIED WARRANTIES OF MERCHANTABILITY OR FITNESS, SO THESE EXCLUSIONS OR LIMITATIONS MAY NOT APPLY TO YOU. THIS WARRANTY GIVES YOU SPECIFIC LEGAL RIGHTS AND YOU MAY ALSO HAVE OTHER RIGHTS, WHICH VARY FROM STATE TO STATE.



WARNING: This product can expose you to chemicals including Nickel (Metallic) which is known to the State of California to cause cancer.

For more information go to www.P65Warnings.ca.gov

Note: Nickel is a component in all stainless steel and some other metallic compositions.

Felix Storch, Inc.
An ISO 9001:2015 registered company
770 Garrison Ave
Bronx, New York 10474
www.summitappliance.com

SUMMIT

For parts and accessory ordering,
troubleshooting and helpful hints, visit:
www.summitappliance.com/support

Revised November 27, 2024
Printed in China