

36" Series 7 Integrated Refrigerator Freezer, Ice

Series 7 | Integrated

Panel Ready | Left hinge



Choose a roomy refrigerator with ice maker. Fits flush with your custom cabinetry or with our stainless steel panels.

- ActiveSmart™ technology helps keep food fresher for longer by constantly maintaining the ideal temperature
- Customize with your own kitchen cabinetry or purchase our stainless steel door panel accessory
- Spacious bottom freezer with full extension drawer, and Internal ice maker with boost for busy times

- Can be fitted for a height of 80 or 84 inches

DIMENSIONS

Height	79 13/16 "
Width	35 1/16 "
Depth	23 3/4 "

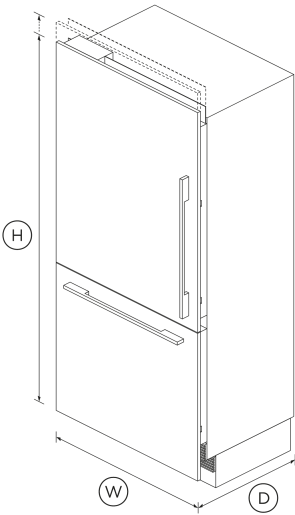

FEATURES & BENEFITS

ACTIVESMART™ FOODCARE

ActiveSmart™ Foodcare learns how you live. It's the technology that understands how you use your fridge and adjusts the temperature, airflow and humidity inside to help keep food fresher for longer.

Clever Energy

Your refrigerator adapts to daily use by cooling and defrosting only when needed. This means your refrigerator uses the energy it needs without compromising on food care.

Complementary Design

With their premium handle styling and stainless steel finish, our refrigerators are designed to match the rest of Fisher & Paykel's kitchen appliance family.

Ice maker

Fresh ice is always available for you in a dedicated freezer bin. Simply turn it off to free up freezer space or during busy times, you can boost ice production by up to 30%.

Easy cleaning

No more permanent dirty marks with our EZKleen feature for stainless steel refrigerators. Anti-fingerprint coating means you simply wipe clean any marks. Spill-safe secure glass shelves easily capture any drips or leaks.

Simple storage

This refrigerator is designed to make it simple for you to store, access and remove food. Storage bins give you full access inside when they're pulled open and can be easily removed to clean. Our flexible shelving also gives you more storage options.

Easy Installation

Our integrated products are easy to install, whether you are renovating your kitchen or designing a new one. Our refrigerators are designed for minimal gaps with adjustable front and rear feet to allow for uneven floors alongside adjustable door panels that can be customized to match your kitchen.

SPECIFICATIONS

Accessories (sold separately)

Door panel set stainless steel	80"" Right hinge RD3680WR, 80"" Left hinge RD3680WL	Adjustable glass shelves	3	Rated current	10 A
		Covered door shelves	2	Supply frequency	60 Hz
		Deli storage bins	1	Supply voltage	115 V
Handle kit Classic	AHCLRD36W	Door alarm	•		
Handle kit Contemporary round, aluminium	AHS-ASBI-B	Fruit and vegetable bins	2		
Handle kit Contemporary square fine, aluminium	AHD5RD36W	LED lighting	•	Product Dimensions	
Handle kit Contemporary square fine, black	AHD5RD36WB	Smart appliance	•	Depth	23 3/4 "
Handle kit Professional round flush	AHP3RD36W	SmartTouch control panel	•	Height	79 13/16 "
Joiner Kit	RS80	Stackable bottle holders	4	Width	35 1/16 "
Stainless steel door panel	80" Left hinge RD3680WL, 84" Left Hinge RD3684WL				
Water filter replacement	847200 - FWC3	Freezer Features		Product information	
		Automatic ice maker	•	Unpackaged weight	327 lbs
		Bottle chill	•		
		Drawer alarm	•		
		Fast freeze	•		
		Freezer bins	2	SKU	26317
		Ice Boost	•		
		LED Lighting	•	The product dimensions and specifications in this page apply to the specific product and model. Under our policy of continuous improvement, these dimensions and specifications may change at any time. You should therefore check with Fisher & Paykel's Customer Care Centre to ensure this page correctly describes the model currently available. © Fisher & Paykel Appliances Ltd 2020	
		Slide Out Pastry Tray	•		
		Performance		Other product downloads available at fisherpaykel.com	
		ActiveSmart™ Foodcare	•		
		Adaptive defrost	•		
		Frost Free Freezer	•		
		Humidity control system	•	↓	2D-DWG Integrated Refrigeration - K05 Hinge
		Inverter controlled compressor	•	↓	2D-DWG Integrated Fridge Freezer
		Sabbath mode	•	↓	2D-DXF Integrated Refrigeration - K05 Hinge
				↓	2D-DXF Integrated Fridge Freezer
				↓	Data Sheet Integrated Fridge Freezer
				↓	Energy Label
		Power Requirements			

- [↓](#) Water Filter Replacement Instructions - Parts 847200 and 847201 - EN
- [↓](#) Installation Guide EN / Guide d'installation FR
- [↓](#) Dual Installation Guide EN
- [↓](#) Water Filter Replacement Instructions - Parts 847200 and 847201 - FR
- [↓](#) Planning Guide
- [↓](#) Revit Refrigerator Freezer
- [↓](#) Rhino Refrigerator Freezer
- [↓](#) Rhino Refrigerator Freezer
- [↓](#) Rhino Refrigerator Freezer
- [↓](#) Rhino Refrigerator Freezer
- [↓](#) Rhino Refrigerator Freezer
- [↓](#) Rhino Refrigerator Freezer
- [↓](#) Rhino Refrigerator Freezer
- [↓](#) Rhino Refrigerator Freezer
- [↓](#) Rhino Refrigerator Freezer
- [↓](#) SketchUp Refrigerator Freezer
- [↓](#) SketchUp Refrigerator Freezer
- [↓](#) SketchUp Refrigerator Freezer
- [↓](#) SketchUp Refrigerator Freezer
- [↓](#) SketchUp Refrigerator Freezer
- [↓](#) SketchUp Refrigerator Freezer
- [↓](#) SketchUp Refrigerator Freezer
- [↓](#) SketchUp Refrigerator Freezer
- [↓](#) User Guide EN

Our In-use Energy Carbon Emissions Estimate is designed to assist customers in making informed purchasing decisions when comparing different Fisher & Paykel products. For example, a heat pump dryer typically has a lower In-use Energy Carbon Emissions Estimate than a vented dryer.



A PEACE OF MIND SALE
24 Hours 7 Days a Week Customer Support
T 1.888.936.7872 W www.fisherpaykel.com

Where applicable:

All appliances use energy, and energy usage typically generates carbon emissions. **Fisher & Paykel Appliances' In-use Energy Carbon Emissions Estimate** indicates carbon emissions from a product's in-use energy. This is calculated either annually or per cycle, using the product's market-specific energy label energy consumption data multiplied by the carbon emissions factor for energy in your country or region.